

SHEET LAYOUT

Main data table with columns for stationing (e.g., 25.1, 25.2, 25.3) and elevation values. Includes sub-sections for 'RED #30 W/LIGHT & BELL' and 'GREEN #27 W/LIGHT & BELL'.

RED # 30 W/LIGHT & BELL EBS 30 APRIL 2013

RED # 28 W/LIGHT & BELL EBS 30 APRIL 2013

RED # 26 W/LIGHT & BELL EBS 30 APRIL 2013

GREEN # 27 W/LIGHT & BELL EBS 30 APRIL 2013

GREEN CAN # 25 EBS 30 APRIL 2013

Vertical table with columns for 'DATE OF SURVEY' and 'FILE NO.' containing survey dates and file numbers.

Table with columns for 'SCALE' and 'FIELD BOOKS' containing scale information and book numbers.

APPROVED: D. SMITH/D. SWAIN (with signature) APPROVED: M. FORTI (with signature) APPROVED: D. CLARKE (with signature) APPROVED: F. POSTILLONE (with signature) DATE: 6 MAY 2013

NEW YORK & NEW JERSEY CHANNELS RARITAN BAY EAST REACH PLANS AND SPEC SURVEY (POST SANDY)

VH-101 SHEET 1 OF 6

PROJECT SPECIFIC NOTES: -THE INFORMATION DEPICTED ON THIS MAP REPRESENTS THE RESULTS OF SURVEYS MADE ON THE DATES INDICATED AND CAN ONLY BE CONSIDERED AS THE GENERAL CONDITIONS EXISTING AT THAT TIME...

LOCAL CONTROL DATA BENCHMARK: NICHOLLS ELEVATION: 6.39' NAVD 1988

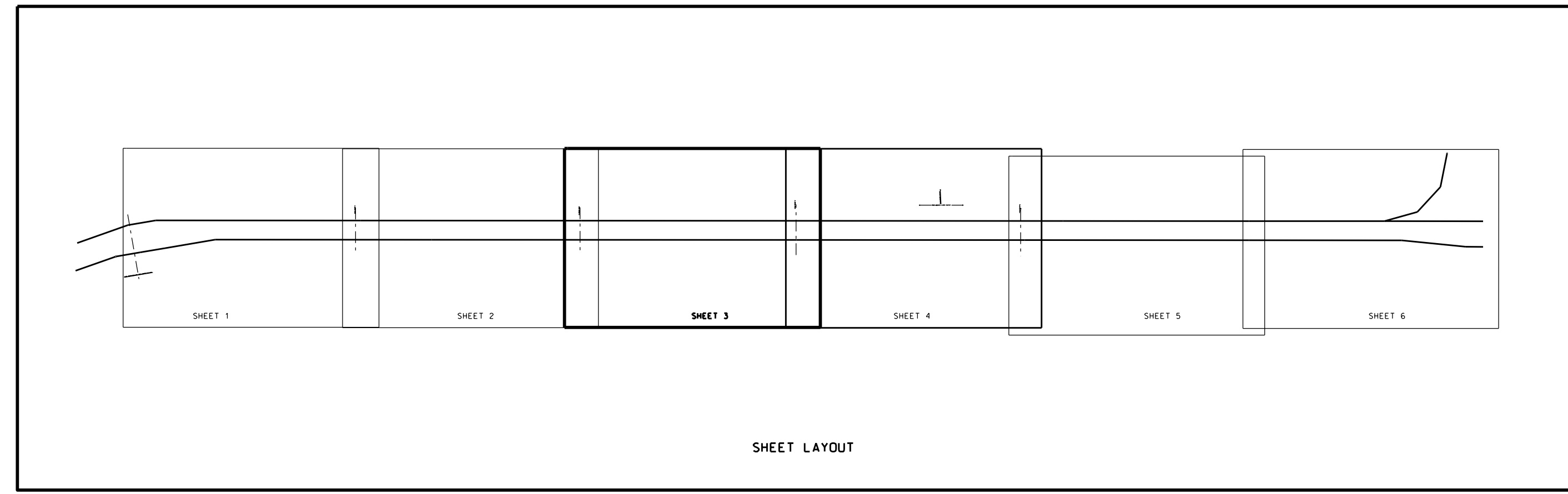
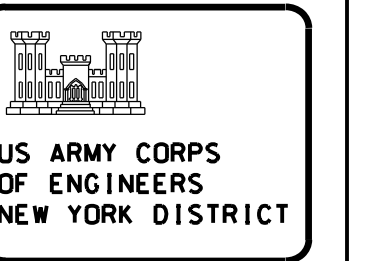

RED # 14
W/LIGHT & BELL
EBB
30 APRIL 2013

MATCH TO SHEET 2

MATCH TO SHEET 4

Table of numerical data (elevation points) with columns for stationing and values. Includes a 'LOCAL CONTROL DATA' box with benchmark information.

DEPARTMENT OF THE ARMY
CORPS OF ENGINEERS
OPERATIONS DIVISION
SURVEY SECTION
CENAN-OP-5

APPROVED: D. SMITH/D. SWAIN
APPROVED: M. FORTE
APPROVED: D. CLARKE
DATE: 6 MAY 2013

NEW YORK & NEW JERSEY CHANNELS
RARITAN BAY EAST REACH
PLANS AND SPEC SURVEY
(POST SANDY)

SCALES:
ONE INCH = 200 FEET
FIELD BOOKS:
9431, B85

DATES OF SURVEY:
15-18, 24, 25, 30 APR 2013

FILE NO.: 13345
PROJECT NO.: 59700

PROJECT SPECIFIC NOTES:

- THE INFORMATION DEPICTED ON THIS MAP REPRESENTS THE RESULTS OF SURVEYS MADE ON THE DATES INDICATED AND CAN ONLY BE CONSIDERED AS THE GENERAL CONDITIONS EXISTING AT THAT TIME.
- THE SOUNDING DATA DEPICTED ON THIS MAP WAS COLLECTED USING PROJECT CLASSIFICATION GENERAL AS SPECIFIED IN EM 1110-2-1003.
- COORDINATES REFER TO THE U.S. STATE PLANE COORDINATE SYSTEM NAD 1983.
- NEW JERSEY MERCATOR - ZONE 2900 - US SURVEY FEET
- SOUNDINGS ON THIS MAP REFER TO THE PLANE OF C.O.G.E. MEAN LOW WATER.
- THE PLANE OF C.O.G.E. MEAN LOW WATER IS 3.4' TO 3.5' FEET BELOW NAVD88.
- FROM ENTRANCE TO A LINE BETWEEN PT COMFORT BEACON AND OLD ORCHARD LIGHT THE PLANE OF C.O.G.E. MEAN LOW WATER IS 3.4' BELOW NAVD 1988.
- FROM A LINE BETWEEN PT COMFORT BEACON AND OLD ORCHARD LIGHT TO SEQUINE PT THE PLANE OF C.O.G.E. MEAN LOW WATER IS 3.5' BELOW NAVD 1988.
- THE DATA ON THIS MAP IS REPRESENTATIVE OF A LARGER DATA SET.
- SOUNDINGS WERE THINNED TO A 25' INTERVAL USING THE COMPLETE DATA SET.
- CONTOURS ON THIS MAP WERE GENERATED USING THE MAP DATA SET.
- THE DATA DEPICTED ON THIS MAP SHOULD NOT BE USED FOR VOLUME CALCULATION PURPOSES.
- THIS SURVEY WAS PERFORMED USING REAL TIME KINEMATIC GPS FROM STATION "0-12".
- THIS MAP IS NOT CEPD COMPLIANT.

VH-103
SHEET 3 OF 6

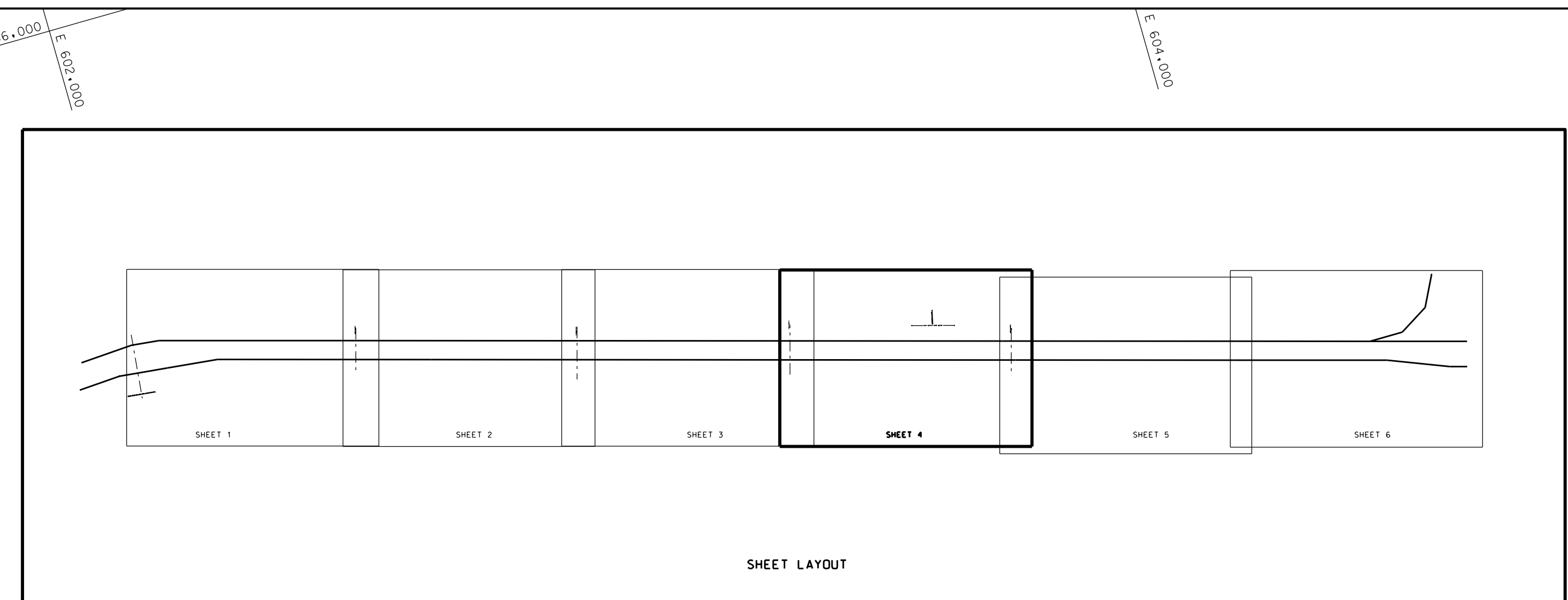
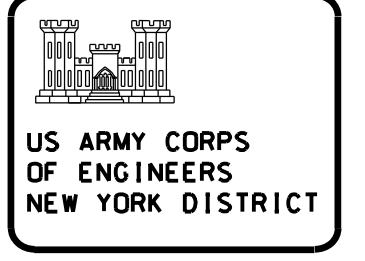

SHEET LAYOUT

Main data table with columns for stationing (e.g., 29.8, 29.9, 30.0) and elevation values. Includes match lines on the left and right sides.

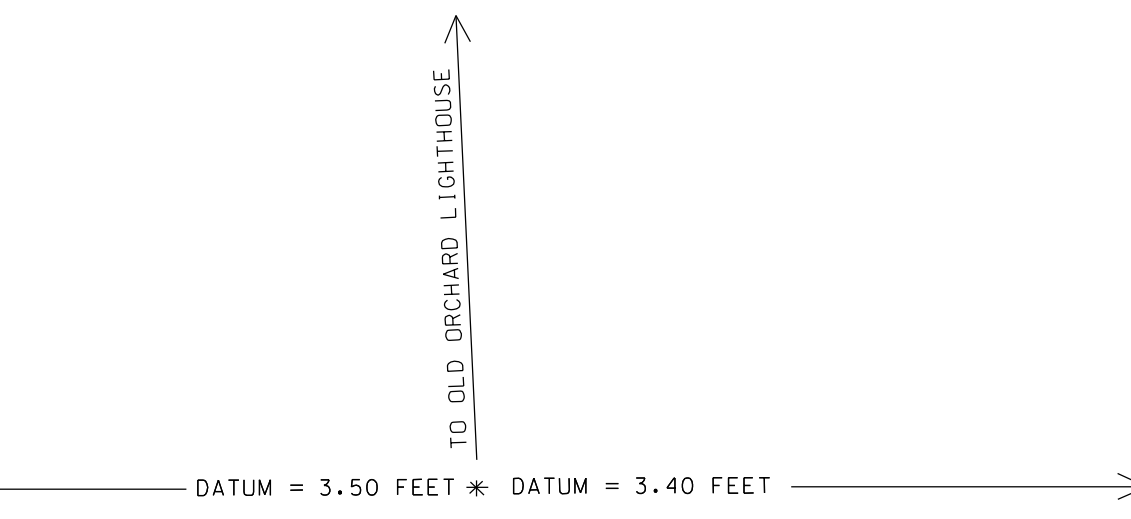

RED # 10 W/LIGHT & BELL EBB 30 APRIL 2013

GREEN # 9 W/LIGHT EBB 30 APRIL 2013

LOCAL CONTROL DATA
BENCHMARK: NICHOLLS
ELEVATION: 6.39' NAVD 1988

PROJECT SPECIFIC NOTES:
-THE INFORMATION DEPICTED ON THIS MAP REPRESENTS THE RESULTS OF SURVEYS MADE ON THE DATES INDICATED AND CAN ONLY BE CONSIDERED AS CLASSIFICATION GENERAL AS SPECIFIED IN EM 1110-2-100.
-THE SOUNDING DATA DEPICTED ON THIS MAP WAS COLLECTED USING PROJECT CLASSIFICATION GENERAL AS SPECIFIED IN EM 1110-2-100.
-COORDINATES REFER TO THE U.S. STATE PLANE COORDINATE SYSTEM NAD 83.
-NEW JERSEY MERIDIAN - ZONE 1800 - US SURVEY FEET.
-SOUNDINGS ON THIS MAP REFER TO THE PLANE OF C.D.E. MEAN LOW WATER.
-THE PLANE OF C.D.E. MEAN LOW WATER IS 2.4' BELOW NAVD88.
-FROM ENTRANCE TO A LINE BETWEEN PT COMFORT BEACON AND OLD ORCHARD LIGHT
-THE PLANE OF C.D.E. MEAN LOW WATER IS 3.4' BELOW NAVD 1988.
-FROM A LINE BETWEEN PT COMFORT BEACON AND OLD ORCHARD LIGHT
-TO SEQUENCE PT THE PLANE OF C.D.E. MEAN LOW WATER IS 3.5' BELOW NAVD 1988.
-THE DATA ON THIS MAP IS REPRESENTATIVE OF LARGE SCALE DATA.
-SOUNDINGS WERE THINNED TO A 25' INTERVAL USING THE COMPLETE DATA SET.
-CONTOURS ON THIS MAP WERE GENERATED USING THE MAP DATA SET.
-THE DATA DEPICTED ON THIS MAP SHOULD NOT BE USED FOR VOLUME CALCULATION PURPOSES.
-THIS SURVEY WAS PERFORMED USING REAL TIME KINEMATIC GPS FROM STATION "GK-12".
-THIS MAP IS NOT CEPD COMPLIANT.

DATES OF SURVEY:
13-04-24-29-30 APR 2013

SCALE:
ONE INCH = 200 FEET

APPROVED: D. SMITH (LTD.)
APPROVED: M. EBBE
APPROVED: D. CLARKE
APPROVED: F. POSTOL
DATE: 8 MAY 2013

DEPARTMENT OF THE ARMY
NEW YORK DISTRICT
CORPS OF ENGINEERS
OPERATIONS DIVISION
SURVEY SECTION
CEMAN-OP-5

NEW YORK & NEW JERSEY CHANNELS
RARIITAN BAY EAST REACH
PLANS AND SPEC SURVEY
(POST SANDY)

VH-104
SHEET 4 OF 6

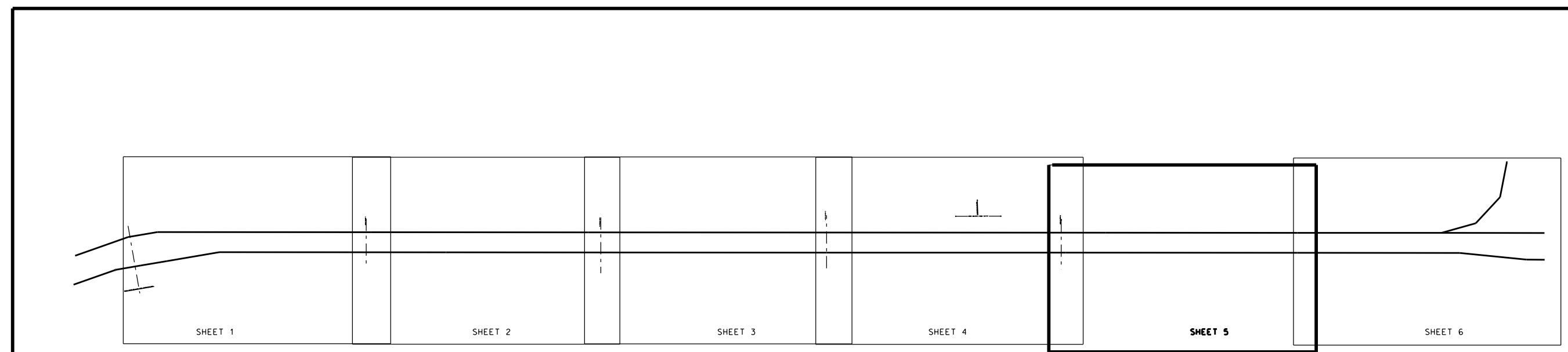
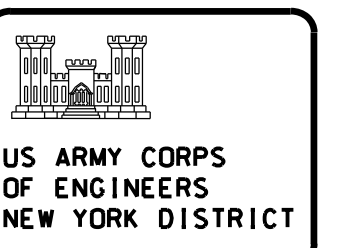

SHEET LAYOUT

RED W/LIGHT & BELL
EBB
30 APRIL 2013

RED NUN #8
EBB
30 APRIL 2013

Large data table with columns for stationing (e.g., 27.0, 27.1, 27.2) and elevation values. Includes match lines on the left and right sides.

LOCAL CONTROL DATA
BENCHMARK: NICHOLLS
ELEVATION: 6.39' NAVD 1988

PROJECT SPECIFIC NOTES
-THE INFORMATION DEPICTED ON THIS MAP REPRESENTS THE RESULTS OF SURVEYS MADE ON THE DATES INDICATED AND CAN ONLY BE CONSIDERED AS THE GENERAL CONDITIONS EXISTING AT THAT TIME.
-THE SOUNDING DATA DEPICTED ON THIS MAP WAS COLLECTED USING PROJECT CLASSIFICATION GENERAL AS SPECIFIED IN EM 1110-2-1.003.
-COORDINATES REFER TO THE U.S. STATE PLANE COORDINATE SYSTEM NAD 1983.
-NEW JERSEY MEGATON - ZONE 2900 - US SURVEY FEET.
-SOUNDINGS ON THIS MAP REFER TO THE MEAN OF C.O.C.E. MEAN LOW WATER.
-THE PLANE OF C.O.C.E. MEAN LOW WATER IS 3.4' BELOW NAVD88.
-FROM ENTRANCE TO A LINE BETWEEN PT COMFORT BEACON AND OLD ORCHARD LIGHT THE PLANE OF C.O.E MEAN LOW WATER IS 3.4' BELOW NAVD 1988.
-THE DATA ON THIS MAP IS REPRESENTATIVE OF A LARGER DATA SET.
-SOUNDINGS WERE THINNED TO A 25' INTERVAL USING THE COMPLETE DATA SET.
-CONTOURS ON THIS MAP WERE GENERATED USING THE MAP DATA SET.
-THE DATA DEPICTED ON THIS MAP SHOULD NOT BE USED FOR VOLUME CALCULATION PURPOSES.
-THIS SURVEY WAS PERFORMED USING REAL TIME KINEMATIC GPS FROM STATION "CK-12".
-THIS MAP IS NOT CEPD COMPLIANT.

Vertical sidebar containing: DATES OF SURVEY (15-18, 24-25, 29-30 APR 2013), SCALE (ONE INCH = 200 FEET), FIELD BOOKS (9-13, 855), DEPARTMENT OF THE ARMY CORPS OF ENGINEERS NEW YORK DISTRICT OPERATIONS DIVISION SURVEY SECTION CENAN-OP-5, APPROVED signatures, and PROJECT TITLE: NEW YORK & NEW JERSEY CHANNELS RARITAN BAY EAST REACH PLANS AND SPEC SURVEY (POST SANDY).

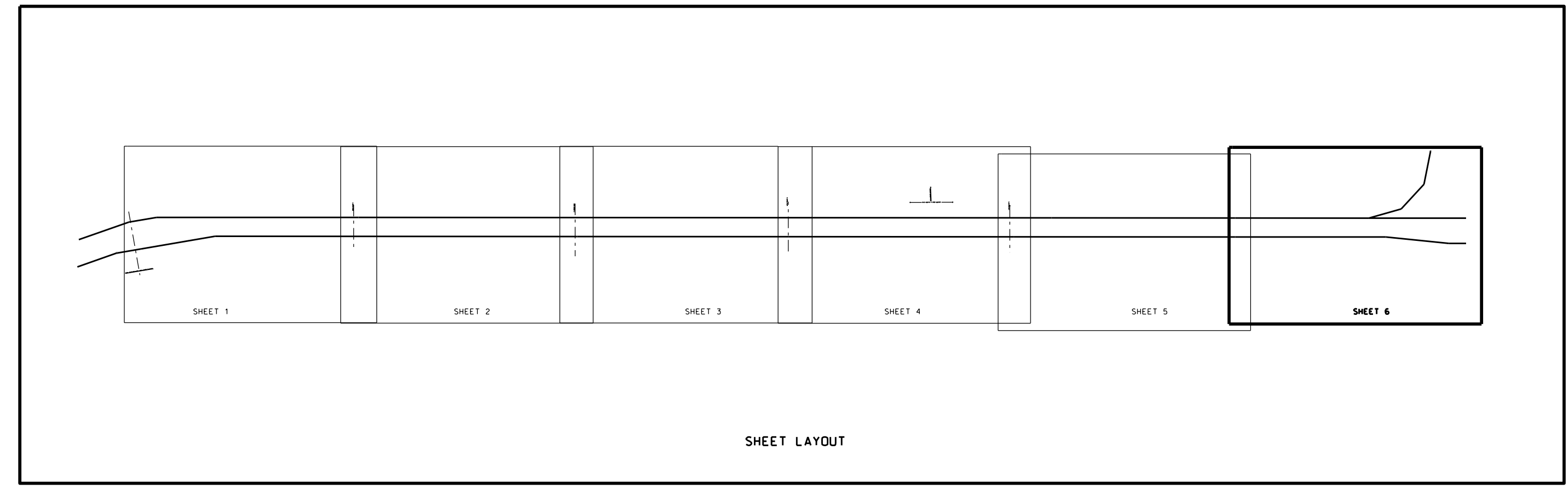
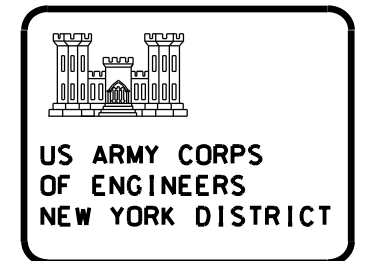

ENTRANCE TO CHAPEL HILL CHANNEL

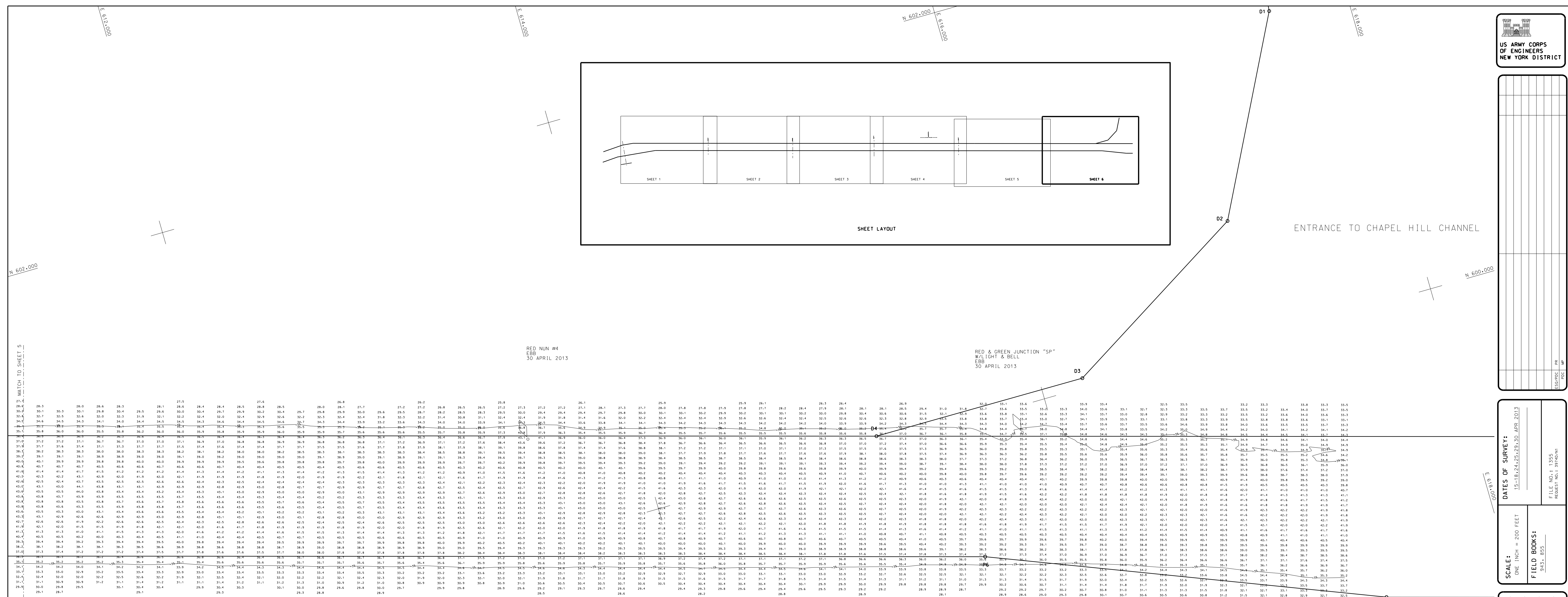

RED NUM #4
EBB
30 APRIL 2013

RED & GREEN JUNCTION "SP"
W/LIGHT & BELL
EBB
30 APRIL 2013

GREEN LIGHT #1
EBB
30 APRIL 2013

Table with 2 columns: DATE, TIME. Contains a grid for recording survey data.

Table with 2 columns: DATE OF SURVEY, FIELD BOOKS. Contains survey dates and book numbers.

Table with 2 columns: SCALE, FIELD BOOKS. Contains scale information and book numbers.

Table with 2 columns: APPROVED, DATE. Contains approval signatures and dates for various roles.

DEPARTMENT OF THE ARMY
CORPS OF ENGINEERS
NEW YORK DISTRICT
OPERATIONS DIVISION
SURVEY SECTION
CENAN-OP-5

NEW YORK & NEW JERSEY CHANNELS
RARITAN BAY EAST REACH
PLANS AND SPEC SURVEY
(POST SANDY)

VH-106
SHEET 6 OF 6

LOCAL CONTROL DATA
BENCHMARK: NICHOLLS
ELEVATION: 6.39' NAVD 1988

PROJECT SPECIFIC NOTES:
- THE INFORMATION DEPICTED ON THIS MAP REPRESENTS THE RESULTS OF SURVEYS MADE ON THE DATES INDICATED AND CAN ONLY BE CONSIDERED AS THE GENERAL CONDITIONS EXISTING AT THAT TIME.
- THE SOUNDING DATA DEPICTED ON THIS MAP WAS COLLECTED USING PRODUCT CLASSIFICATION GENERAL AS SPECIFIED IN EM 1110-2-1003.
- COORDINATES REFER TO THE US STATE PLANE COORDINATE SYSTEM NAD 1983, NEW JERSEY MERCATOR - ZONE 2900, US SURVEY FEET.
- SOUNDINGS ON THIS MAP REFER TO THE PLANE OF C.O.D.E., MEAN LOW WATER.
- THE PLANE OF C.O.D.E., MEAN LOW WATER IS 3.4' TO 3.5' FEET BELOW NAVD88.
- FROM ENTRANCE TO A LINE BETWEEN PT COMFORT BEACON AND OLD ORCHARD LIGHT
- THE PLANE OF COE MEAN LOW WATER IS 3.4' BELOW NAVD 1988.
- TO SEGMENT PT THE PLANE OF COE MEAN LOW WATER IS 3.5' BELOW NAVD 1988.
- THE DATA ON THIS MAP IS REPRESENTATIVE OF A LARGER DATA SET.
- SOUNDINGS WERE THINNED TO A 2' INTERVAL USING THE COMPLETE DATA SET.
- THE DATA DEPICTED ON THIS MAP SHOULD NOT BE USED FOR VOLUME CALCULATION PURPOSES.
- THIS SURVEY WAS PERFORMED USING REAL TIME KINEMATIC GPS FROM STATION "OK-12".
- THIS MAP IS NOT GCPD COMPLIANT.