

SCALE: ONE INCH = 1200 FEET	DATES OF SURVEY: 7-12-19-20-24-26 FEB 2014
	FIELD BOOKS: 5, 7 MAR 2014 FILE NO.: 1360 PROJECT NO.: 4103D/N3

DEPARTMENT OF THE ARMY CORPS OF ENGINEERS NEW YORK, NEW YORK 10278	APPROVED: [Signature] DATE: 11 MAR 2014
OPERATIONS DIVISION SPECIAL OPERATIONS CEBAN-CPS	APPROVED: [Signature] DATE: 11 MAR 2014

NEW YORK & NEW JERSEY CHANNELS ARTHUR KILL CONDITION SURVEY
---

LOCAL CONTROL DATA
BENCHMARK: A1D 10024 ELEVATION: 13.02' NAVD 1988
NSRS BENCHMARK
BENCHMARK: B5 (PID: KVO006) ELEVATION: 63.49' NAVD 1988

PROJECT SPECIFIC NOTES:

- THE INFORMATION DEPICTED ON THIS MAP REPRESENTS THE RESULTS OF SURVEYS MADE ON THE DATES INDICATED AND CAN ONLY BE CONSIDERED AS THE GENERAL CONDITIONS EXISTING AT THAT TIME.
- THE SOUNDING DATA DEPICTED ON THIS MAP WAS COLLECTED USING PROJECT CLASSIFICATION SPIT AS SPECIFIED IN EM 1110-2-1003.
- COORDINATES REFER TO US STATE PLANE COORDINATE SYSTEM NAD 1983, NEW JERSEY MERCATOR - ZONE 2900, US SURVEY FEET.
- SOUNDINGS ON THIS MAP REFER TO THE PLANE OF C.D.E. MEAN LOW WATER.
- THE PLANE OF C.D.E. MEAN LOW WATER IS 3.4 - 3.5 FEET BELOW NAVD88.
- SOUNDINGS DEPICTED ON THIS MAP ARE BASED ON A 3' x 3' AVERAGE CELL, SORTED TO A 30' INTERVAL.
- CONTOURS ON THIS MAP WERE GENERATED USING THE 3' x 3' AVERAGE DATA SET.
- THE DATA DEPICTED ON THIS MAP SHOULD NOT BE USED FOR VOLUME CALCULATION PURPOSES.
- THE PLANIMETRICS DEPICTED ON THIS MAP ARE FOR ORIENTATION PURPOSES ONLY.
- THIS SURVEY WAS PERFORMED USING REAL TIME KINEMATIC GPS FROM THE NYDOT NETWORK.
- THIS MAP IS NOT CEPD COMPLIANT.

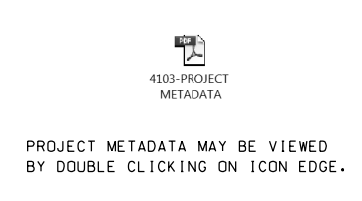



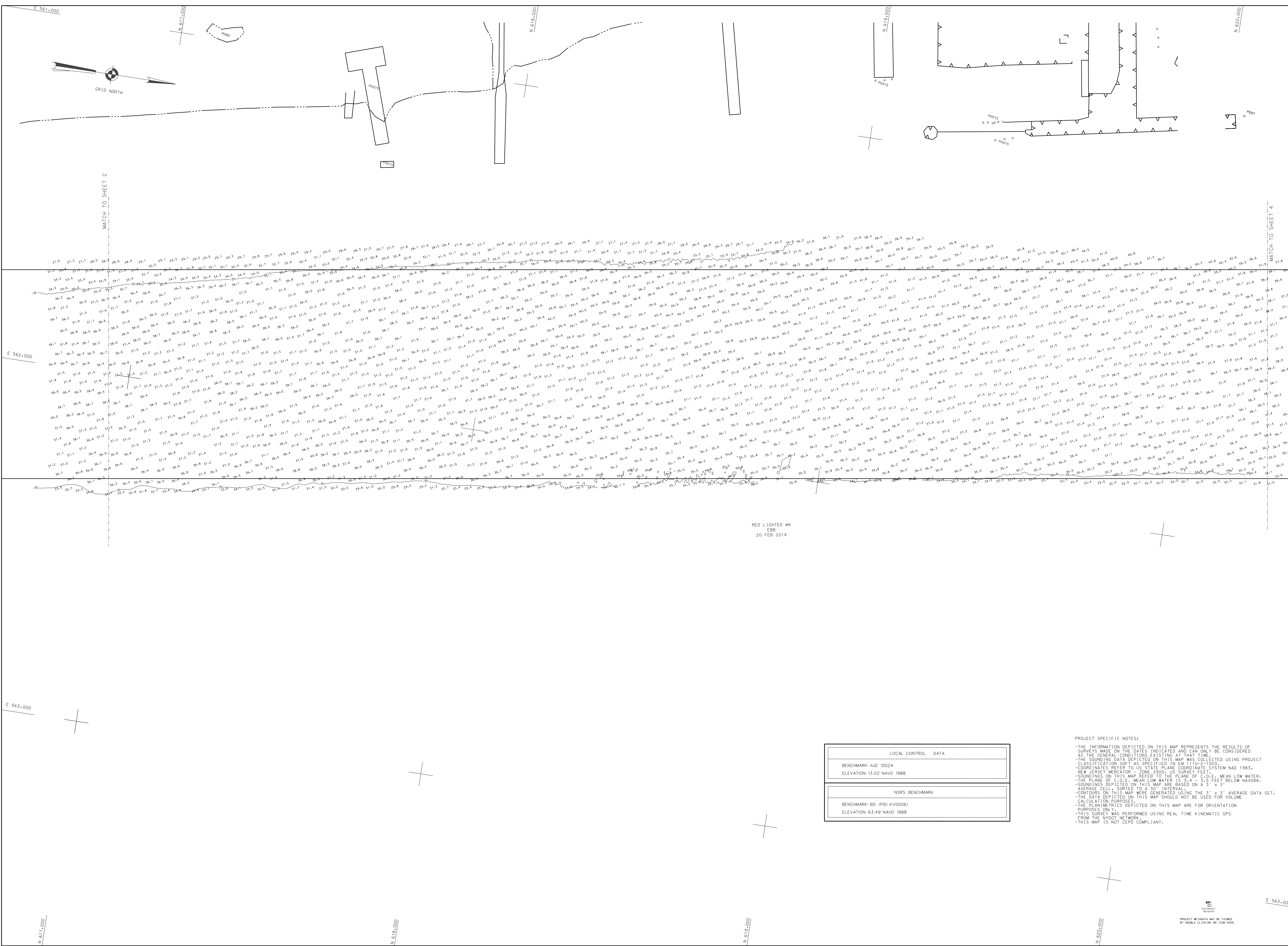
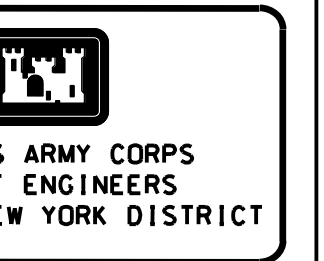

RED LIGHTED #4  
20 FEB 2014

LOCAL CONTROL DATA	
BENCHMARK: AJD 10024	
ELEVATION: 13.02' NAVD 1988	
NTRS BENCHMARK	
BENCHMARK: B5 (PID: KVV006)	
ELEVATION: 63.49' NAVD 1988	

PROJECT SPECIFIC NOTES:

- THE INFORMATION DEPICTED ON THIS MAP REPRESENTS THE RESULTS OF SURVEYS MADE ON THE DATES INDICATED AND CAN ONLY BE CONSIDERED AS THE GENERAL CONDITIONS EXISTING AT THAT TIME.
- THE SOUNDING DATA DEPICTED ON THIS MAP WAS COLLECTED USING PROJECT CLASSIFICATION SPT AS SPECIFIED IN EM 1110-2-1003.
- COORDINATES REFER TO US STATE PLANE COORDINATE SYSTEM NAD 1983, NEW JERSEY MERCATOR - ZONE 2900, US SURVEY FEET.
- SOUNDINGS ON THIS MAP REFER TO THE PLANE OF C.O.D.E. - MEAN LOW WATER, -THE PLANE OF C.O.D.E. - MEAN LOW WATER IS 2.4' - 2.5 FEET BELOW NAVD83.
- SOUNDINGS DEPICTED ON THIS MAP ARE BASED ON A 3' X 3' AVERAGE CELL, SORTED TO A 30' INTERVAL.
- CONTOURS ON THIS MAP WERE GENERATED USING THE 3' X 3' AVERAGE DATA SET.
- THE DATA DEPICTED ON THIS MAP SHOULD NOT BE USED FOR VOLUME CALCULATION PURPOSES.
- THE PLANIMETRICS DEPICTED ON THIS MAP ARE FOR ORIENTATION PURPOSES ONLY.
- THIS SURVEY WAS PERFORMED USING REAL TIME KINEMATIC GPS FROM THE NYDOD NETWORK.
- THIS MAP IS NOT CEPD COMPLIANT.

E50		PRE	DATE
E51		PRE	DATE
E52		PRE	DATE
E53		PRE	DATE
E54		PRE	DATE
E55		PRE	DATE
E56		PRE	DATE
E57		PRE	DATE
E58		PRE	DATE
E59		PRE	DATE
E60		PRE	DATE

SCALE:	ONE INCH = 100 FEET
DATES OF SURVEY:	7-12-19, 20-24, 26 FEB 2014 6-7 MAR 2014
FIELD BOOKS:	
	FILE NO: 1380 REQUEST NO: 49504

DEPARTMENT OF THE ARMY	APPROVED: D. SMITH
CORPS OF ENGINEERS	APPROVED: M. FERRE
NEW YORK, NEW YORK 10278	APPROVED: D. CLARK
	APPROVED: J. BRAY
	DATE: 13 MARCH 2014

NEW YORK & NEW JERSEY CHANNELS
ARTHUR KILL
CONDITIONS SURVEY









N 629.000

N 629.000

GRID NORTH

N 629.000

N 629.000

N 627.000

N 627.000

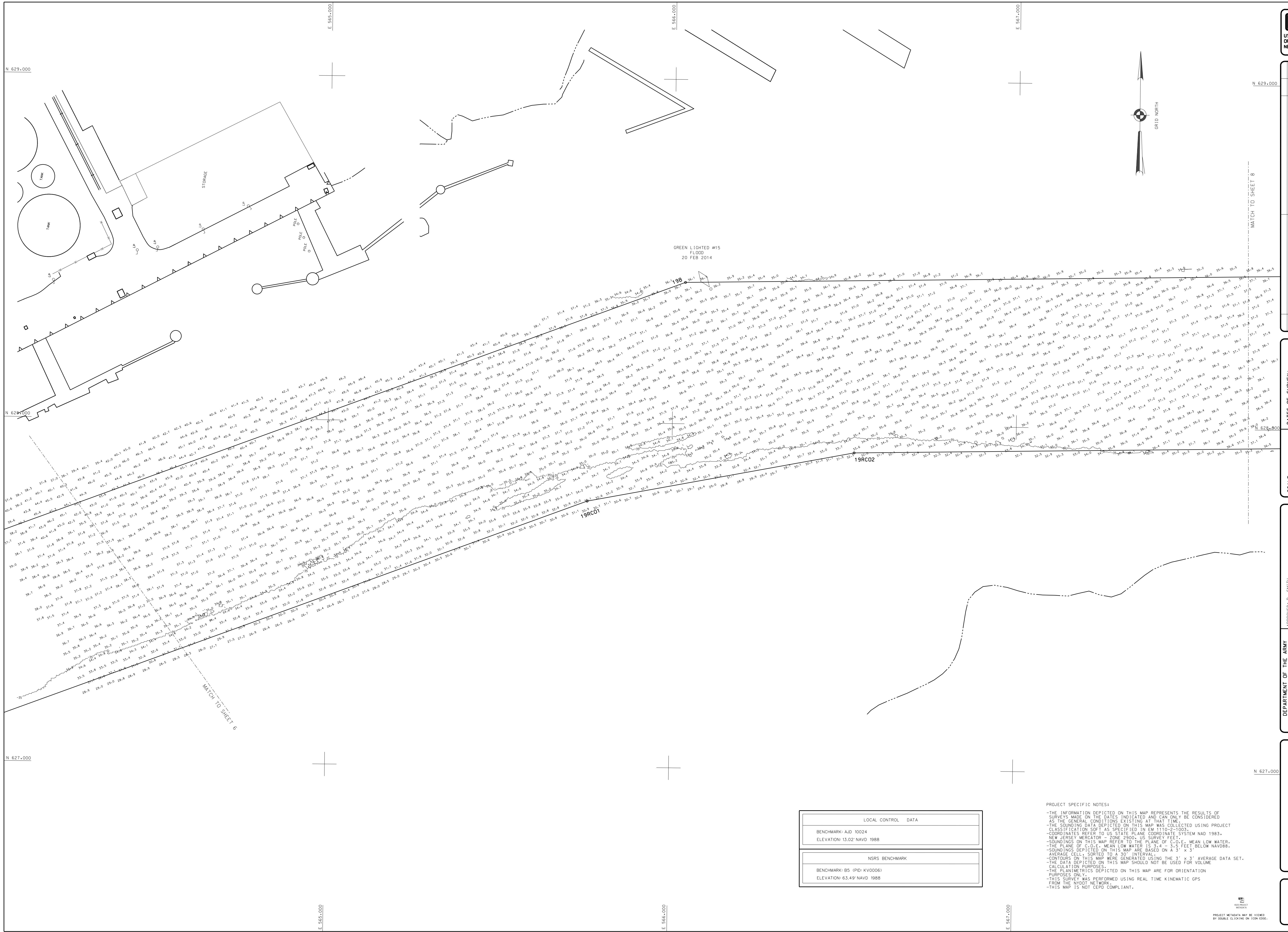

Table with columns for file names and sheet numbers. Includes entries like 'ESD DRG' and 'FOOT MAP'.

Table with columns for 'DATES OF SURVEY' and 'FILE NO.'s. Includes dates like '1-12-19-20-24-26 FEB 2014' and '6-7 MAR 2014'.

Table with columns for 'SCALE' and 'FIELD BOOKS'. Includes text like 'ONE INCH = 100 FEET'.

Table with columns for 'APPROVED' and 'DATE'. Includes names like 'D. SMITH' and 'M. EDLIE'.

Table with columns for 'DEPARTMENT OF THE ARMY' and 'OPERATIONS DIVISION'. Includes 'NEW YORK DISTRICT' and 'SURVEY SECTION'.

Table with columns for 'NEW YORK & NEW JERSEY CHANNELS' and 'CONDITIONS SURVEY'. Includes 'ARTHUR KILL'.

Table with columns for 'VH-107' and 'SHEET 7 OF 18'.

Table with columns for 'LOCAL CONTROL DATA' and 'NSRS BENCHMARK'. Includes benchmark details like 'BENCHMARK: A10 10024' and 'ELEVATION: 13.02 NAVD 1988'.

PROJECT SPECIFIC NOTES:
-THE INFORMATION DEPICTED ON THIS MAP REPRESENTS THE RESULTS OF SURVEYS MADE ON THE DATES INDICATED AND CAN ONLY BE CONSIDERED AS THE GENERAL CONDITIONS EXISTING AT THAT TIME.

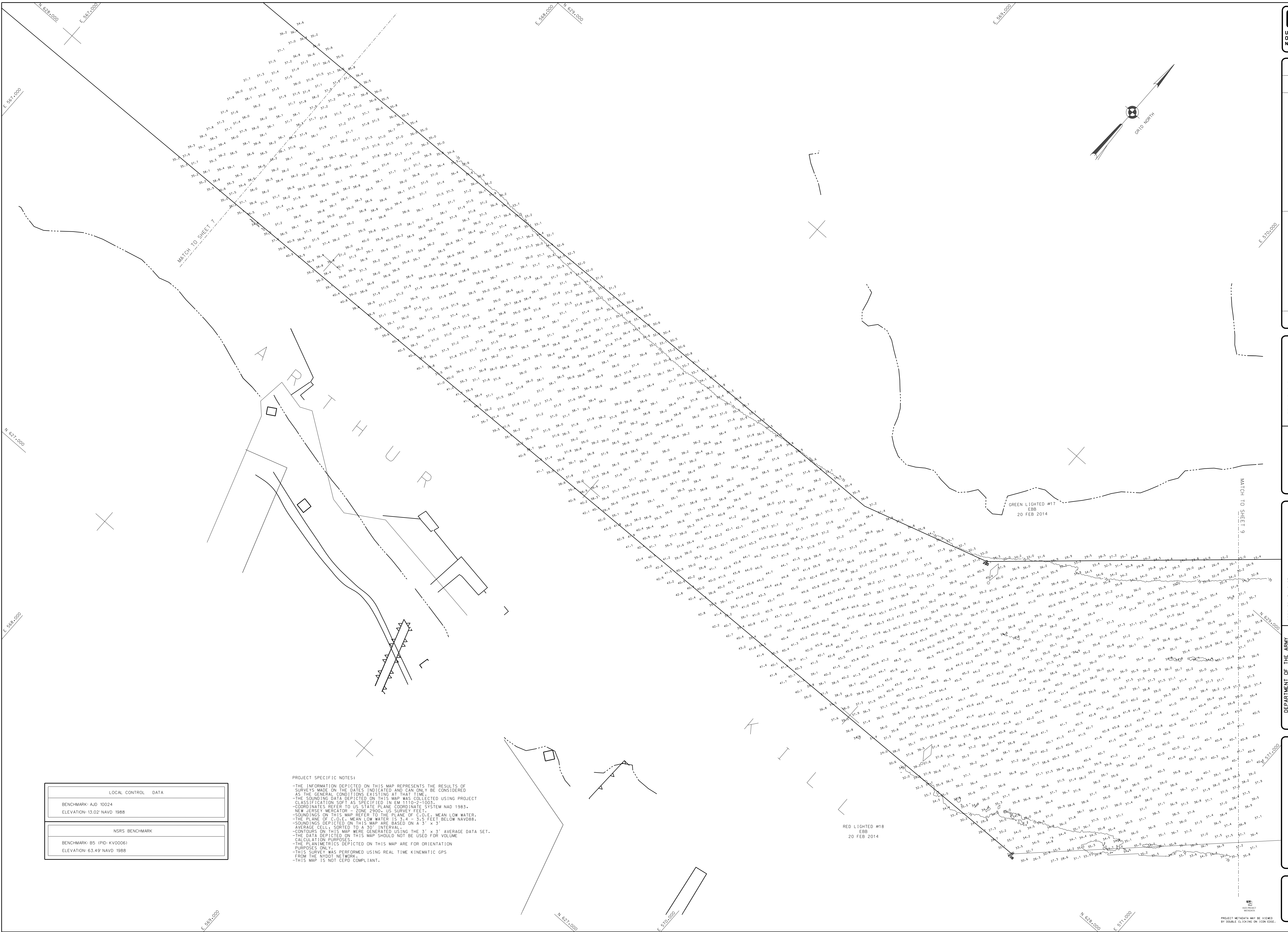
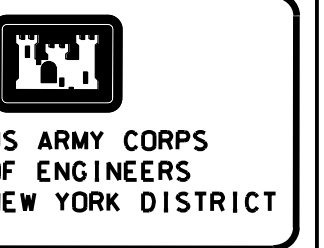

LOCAL CONTROL DATA	
BENCHMARK: AJD 10024	ELEVATION: 13.02 NAVD 1988
NSRS BENCHMARK	
BENCHMARK: 65 (PID: KY0006)	ELEVATION: 63.49 NAVD 1988

**PROJECT SPECIFIC NOTES:**

- THE INFORMATION DEPICTED ON THIS MAP REPRESENTS THE RESULTS OF SURVEYS MADE ON THE DATES INDICATED AND CAN ONLY BE CONSIDERED AS THE GENERAL CONDITIONS EXISTING AT THAT TIME.
- THE SOUNDING DATA DEPICTED ON THIS MAP WAS COLLECTED USING PROJECT CLASSIFICATION: SPT-45, SPECIFIED IN EM 1110-2-1003.
- COORDINATES REFER TO US STATE PLANE COORDINATE SYSTEM NAD 1983.
- NEW JERSEY MERCATOR - ZONE 1900 - US SURVEY FEET
- SOUNDINGS ON THIS MAP REFER TO THE PLANE OF C.O.D.E. MEAN LOW WATER.
- THE PLANE OF C.O.D.E. MEAN LOW WATER IS 3.4 - 3.5 FEET BELOW NAVD88.
- SOUNDINGS DEPICTED ON THIS MAP ARE BASED ON A 3' x 3' AVERAGE CELL, SORTED TO A 30' INTERVAL.
- CONTOURS ON THIS MAP WERE GENERATED USING THE 3' x 3' AVERAGE DATA SET.
- THE DATA DEPICTED ON THIS MAP SHOULD NOT BE USED FOR VOLUME CALCULATION PURPOSES.
- THE PLANIMETRICS DEPICTED ON THIS MAP ARE FOR ORIENTATION PURPOSES ONLY.
- THIS SURVEY WAS PERFORMED USING REAL TIME KINEMATIC GPS FROM THE NAD03 NETWORK.
- THIS MAP IS NOT CEPD COMPLIANT.

DATES OF SURVEY:	
7-12, 19, 20, 24, 26, FEB 2014	5-7 MAR 2014
FILE NO.: 1365	
REQUEST NO.: 410303	

SCALE:	
ONE INCH = 100 FEET	
FIELD BOOKS:	

APPROVED: D. SMITH (SPT-45)	APPROVED: M. FORTE (CIVIL ENGINEERING TECHNICIAN)
APPROVED: J. CLARKE (SPT-45)	APPROVED: J. MRSZ (SPT-45)
DATE: 13 MARCH 2014	DATE: 13 MARCH 2014

DEPARTMENT OF THE ARMY NEW YORK DISTRICT NEW YORK, NEW YORK 10278	OPERATIONS DIVISION SURVEY SECTION CENNA-COPS
---	---

NEW YORK & NEW JERSEY CHANNELS  
ARTHUR KILL  
CONDITIONS SURVEY



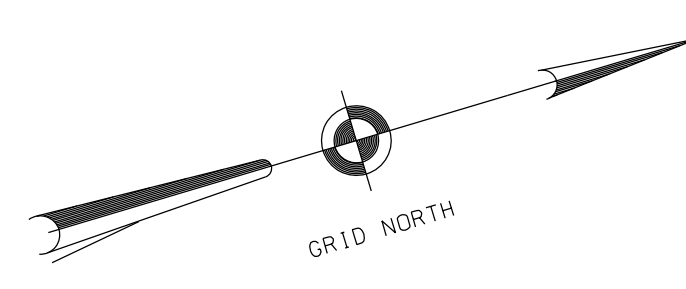
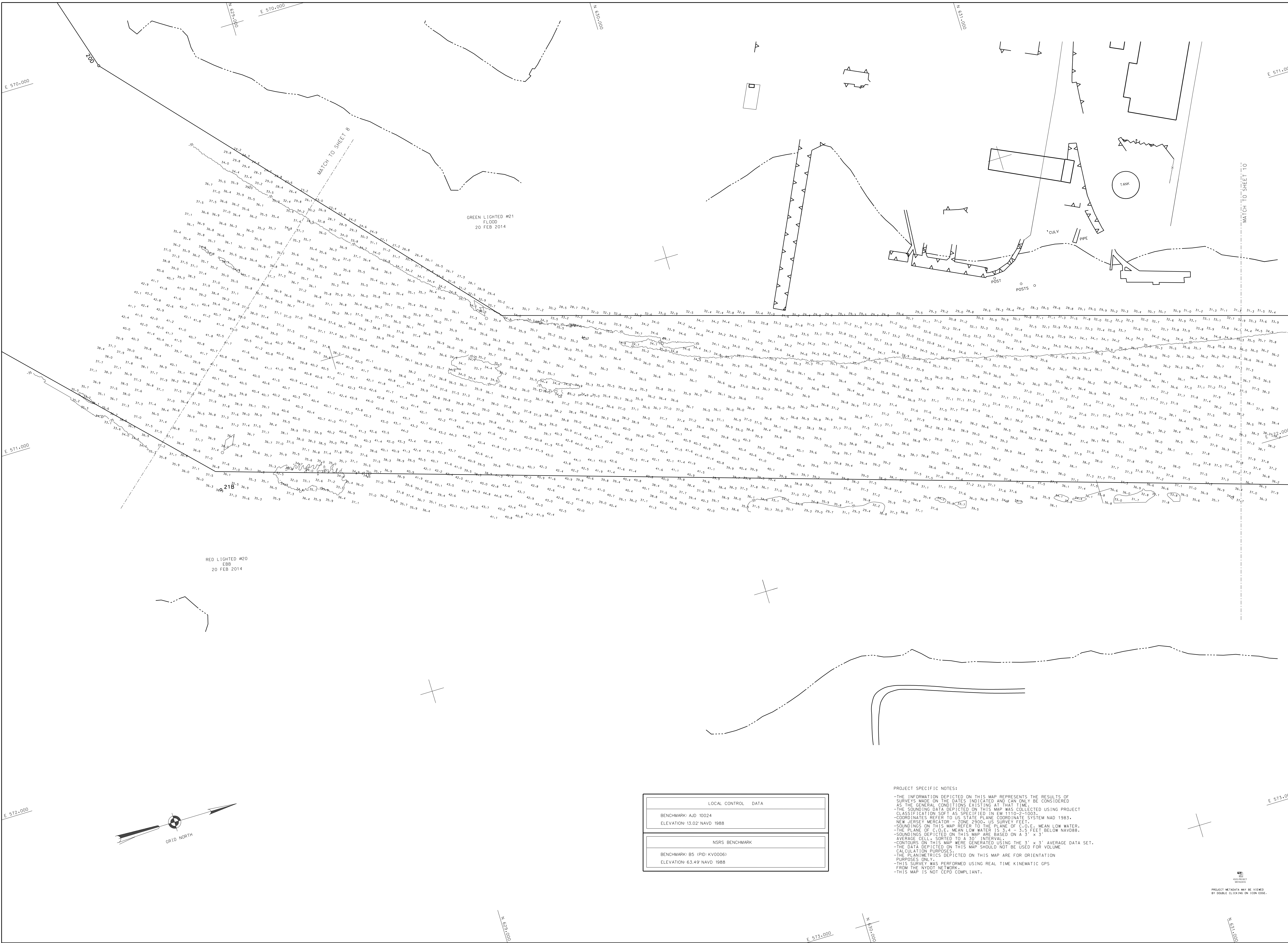

LOCAL CONTROL DATA	
BENCHMARK: AJD 10024	ELEVATION: 13.02' NAVD 1988
NSRS BENCHMARK	
BENCHMARK: B5 (PID: KY0006)	ELEVATION: 63.49' NAVD 1988

**PROJECT SPECIFIC NOTES**

- THE INFORMATION DEPICTED ON THIS MAP REPRESENTS THE RESULTS OF SURVEYS MADE ON THE DATES INDICATED AND CAN ONLY BE CONSIDERED AS THE GENERAL CONDITIONS EXISTING AT THAT TIME.
- THE SOUNDING DATA DEPICTED ON THIS MAP WAS COLLECTED USING PROJECT CLASSIFICATION "S" AS SPECIFIED IN EM 1110-2-1003.
- COORDINATES REFER TO US STATE PLANE COORDINATE SYSTEM NAD 1983.
- NEW JERSEY MERCATOR ZONE 18N00 US SURVEY FEET.
- SOUNDINGS ON THIS MAP REFER TO THE PLANE OF C.O.E. MEAN LOW WATER.
- THE PLANE OF C.O.E. MEAN LOW WATER IS 2.4 - 3.5 FEET BELOW NAVD83.
- SOUNDINGS DEPICTED ON THIS MAP ARE BASED ON 0.5' X 3' AVERAGE CELL, SORTED TO A 30' INTERVAL.
- CONTOURS ON THIS MAP WERE GENERATED USING THE 3' X 3' AVERAGE DATA SET.
- THE DATA DEPICTED ON THIS MAP SHOULD NOT BE USED FOR VOLUME CALCULATION PURPOSES.
- THE PLANIMETRICS DEPICTED ON THIS MAP ARE FOR ORIENTATION PURPOSES ONLY.
- THIS SURVEY WAS PERFORMED USING REAL TIME KINEMATIC GPS FROM THE WOOD NETWORK.
- THIS MAP IS NOT CEPD COMPLIANT.

ESD	PHI	DATE

<b>SCALE:</b> ONE INCH = 100 FEET	<b>DATES OF SURVEY:</b> 7-12-19; 20-24; 26 FEB 2014 6-7 MAR 2014
<b>FIELD BOOKS:</b>	<b>REQUEST NO.:</b> 1380 <b>FILE NO.:</b> 4380/NS

<b>DEPARTMENT OF THE ARMY</b> <b>CORPS OF ENGINEERS</b> <b>NEW YORK, NEW YORK 10278</b>	<b>APPROVED:</b> D. SMITH <b>APPROVED:</b> M. FORBIE <b>APPROVED:</b> D. CLARK <b>APPROVED:</b> J. BRAZ
<b>OPERATIONS DIVISION</b> <b>STRUCTURAL DIVISION</b> <b>CERAMICS</b>	<b>DATE:</b> 13 MARCH 2014

**NEW YORK & NEW JERSEY CHANNELS**  
**ARTHUR KILL**  
**CONDITIONS SURVEY**

PROJECT METADATA MAY BE VIEWED BY DOUBLE CLICKING ON ICON HERE.

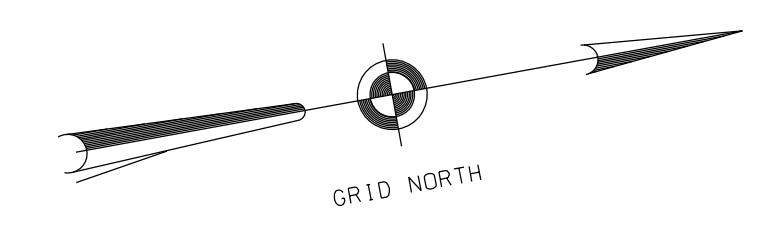
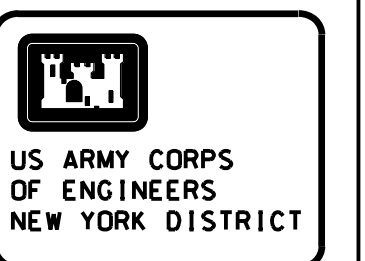

ESD	PH	DATE

<b>SCALE:</b> ONE INCH = 100 FEET	<b>DATES OF SURVEY:</b>
	7-12, 19, 20, 24, 26 FEB 2014 6, 7 MAR 2014
<b>FIELD BOOKS:</b>	<b>FILE NO.:</b> 1360
	REBEL NO.: 4150(N)

<b>APPROVED:</b> D. SMITH
<b>APPROVED:</b> M. EDRIE
<b>APPROVED:</b> D. CLARKE
<b>APPROVED:</b> J. BRAZ
<b>DATE:</b> 13 MAR 2014

DEPARTMENT OF THE ARMY  
CORPS OF ENGINEERS  
NEW YORK - NEW YORK 10278  
OPERATIONS DIVISION  
SURVEY SECTION  
CENAN-CPS

**NEW YORK & NEW JERSEY CHANNELS  
ARTHUR KILL  
CONDITIONS SURVEY**

**VH-110  
SHEET 10 OF 18**

RED LIGHED #24  
FLOOD  
20 FEB 2014

LOCAL CONTROL DATA	
BENCHMARK: AJD 10024	ELEVATION: 13.02' NAVD 1988
NSRS BENCHMARK	
BENCHMARK: B5 (PID: KV0006)	ELEVATION: 63.49' NAVD 1988

**PROJECT SPECIFIC NOTES:**

- THE INFORMATION DEPICTED ON THIS MAP REPRESENTS THE RESULTS OF SURVEYS MADE ON THE DATES INDICATED AND CAN ONLY BE CONSIDERED AS THE GENERAL CONDITIONS EXISTING AT THAT TIME.
- THE SOUNDING DATA DEPICTED ON THIS MAP WAS COLLECTED USING PROJECT CLASSIFICATION SOFTWARE AS SPECIFIED IN EM 1110-2-1003.
- COORDINATES REFER TO US STATE PLANE COORDINATE SYSTEM NAD 1983, NEW JERSEY MERCATOR ZONE 2000, US SURVEY FEET.
- SOUNDINGS ON THIS MAP REFER TO THE PLANE OF C.O.C.E. MEAN LOW WATER.
- THE PLANE C.O.C.E. MEAN LOW WATER IS 3.4 FEET BELDWN NAVD88.
- SOUNDINGS ON THIS MAP ARE BASED ON A 3' x 3' AVERAGE CELL, SORTED TO A 30' INTERVAL.
- CONTOURS ON THIS MAP WERE GENERATED USING THE 3' x 3' AVERAGE DATA SET. CALCULATION PURPOSES.
- THE DATA DEPICTED ON THIS MAP SHOULD NOT BE USED FOR VOLUME CALCULATION PURPOSES.
- THE PLANIMETRICS DEPICTED ON THIS MAP ARE FOR ORIENTATION PURPOSES ONLY.
- THIS SURVEY WAS PERFORMED USING REAL TIME KINEMATIC GPS FROM THE WOODNET NETWORK.
- THIS MAP IS NOT CEPD COMPLIANT.



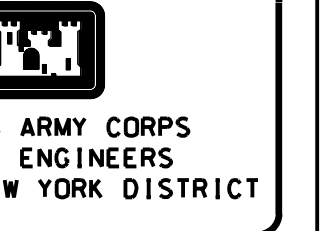

<b>DATES OF SURVEY:</b>	7-12, 19, 20, 24, 25 FEB 2014 5-7 MAR 2014
<b>FIELD BOOKS:</b>	FILE NO.: 1380 REBET NO.: 4102/N3

<b>SCALE:</b>	ONE INCH = 100 FEET
---------------	---------------------

<b>APPROVED:</b> D. SMITH (Survey Manager)	
<b>APPROVED:</b> M. EDRIE (Section Supervisor)	
<b>APPROVED:</b> D. CLARK (Survey Manager)	
<b>APPROVED:</b> J. MARZ (Survey Manager)	
<b>DATE:</b>	13 MAR 2014

DEPARTMENT OF THE ARMY  
CORPS OF ENGINEERS  
NEW YORK, NEW YORK 10278

OPERATIONS DIVISION  
SURVEY SECTION  
CERANO-OPS

**NEW YORK & NEW JERSEY CHANNELS**  
**ARTHUR KILL**  
**CONDITIONS SURVEY**

VH-112  
SHEET 12 OF 18

LOCAL CONTROL DATA	
BENCHMARK: A10 10024	
ELEVATION: 13.02' NAVD 1988	
NSRS BENCHMARK	
BENCHMARK: B5 (PID KY0006)	
ELEVATION: 63.49' NAVD 1988	

- PROJECT SPECIFIC NOTES:**
- THE INFORMATION DEPICTED ON THIS MAP REPRESENTS THE RESULTS OF SURVEYS MADE ON THE DATES INDICATED AND CAN ONLY BE CONSIDERED AS THE GENERAL CONDITIONS EXISTING AT THAT TIME.
  - THE SOUNDING DATA DEPICTED ON THIS MAP WAS COLLECTED USING PROJECT CLASSIFICATION SOFTWARE SPECIFIED IN EM 1110-2-1003.
  - COORDINATES REFER TO US STATE PLANE COORDINATE SYSTEM NAD 1983, NEW JERSEY MERIDIAN - ZONE 1800A, US SURVEY FEET.
  - SOUNDINGS ON THIS MAP REFER TO THE PLANE OF C.D.E., MEAN LOW WATER.
  - THE PLANE OF C.D.E., MEAN LOW WATER IS 3.4 - 3.5 FEET BELOW NAVD08.
  - SOUNDINGS DEPICTED ON THIS MAP ARE BASED ON A 3' x 3' AVERAGE CELL, SORTED TO A 50' INTERVAL.
  - CONTOURS ON THIS MAP WERE GENERATED USING THE 3' x 3' AVERAGE DATA SET.
  - THE DATA DEPICTED ON THIS MAP SHOULD NOT BE USED FOR VOLUME CALCULATION PURPOSES.
  - THIS SURVEY WAS PERFORMED USING REAL TIME KINEMATIC GPS FROM THE NYDOT NETWORK.
  - THIS MAP IS NOT CEPD COMPLIANT.

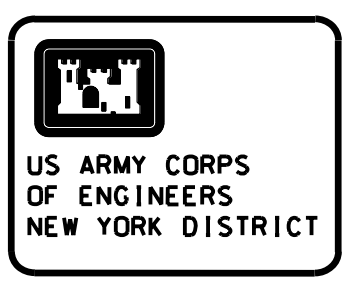

Table with multiple rows and columns, likely a metadata or revision log. Headers include 'ESD', 'PR', 'APP'.

Table containing 'DATES OF SURVEY' (7-12-19, 20, 24, 26 FEB 2014; 6, 7 MAR 2014) and 'FIELD BOOKS'.

Table for 'APPROVED' signatures. Includes names like 'D.L. SMITH', 'M. FERTE', 'D.L. ELBERT', 'J. WRAY' and dates.

DEPARTMENT OF THE ARMY  
ENGINEER CENTER  
NEW YORK, NEW YORK 10278  
ORGANIZATION: 10100  
SURVEY SECTION  
CERAN-COPS

NEW YORK & NEW JERSEY CHANNELS  
ARTHUR KILL  
CONDITIONS SURVEY

VH-113  
SHEET 13 OF 18

LOCAL CONTROL DATA
BENCHMARK: AJD 10024 ELEVATION: 13.02' NAVD 1988
NSRS BENCHMARK
BENCHMARK: BS (IPID:KV0006) ELEVATION: 63.49' NAVD 1988

PROJECT SPECIFIC NOTES:  
-THE INFORMATION DEPICTED ON THIS MAP REPRESENTS THE RESULTS OF SURVEYS MADE ON THE DATES INDICATED AND CAN ONLY BE CONSIDERED AS THE GENERAL CONDITIONS EXISTING AT THAT TIME.  
-THE SOUNDING DATA DEPICTED ON THIS MAP WAS COLLECTED USING PROJECT CLASSIFICATION SONAR AS SPECIFIED IN 3M 1110-2-1005.  
-COORDINATES REFER TO US STATE PLANE COORDINATE SYSTEM NAD 1983.  
-NEW JERSEY MERCATOR - ZONE 2900, US SURVEY FEET.  
-SOUNDINGS ON THIS MAP REFER TO THE PLANE OF COE MEAN LOW WATER.  
-THE PLANE OF COE MEAN LOW WATER IS 3.4 FEET BELOW NAVD88.  
-SOUNDINGS ON THIS MAP ARE BASED ON A 3' x 3' AVERAGE CELL.  
-CONTOURS ON THIS MAP WERE GENERATED USING THE 3' x 3' AVERAGE DATA SET.  
-THE DATA DEPICTED ON THIS MAP SHOULD NOT BE USED FOR VOLUME CALCULATION PURPOSES.  
-THE PLANIMETRICS DEPICTED ON THIS MAP ARE FOR ORIENTATION PURPOSES ONLY.  
-THIS SURVEY WAS PERFORMED USING REAL TIME KINEMATIC GPS FROM THE NYDOT NETWORK.  
-THIS MAP IS NOT CEPD COMPLIANT.





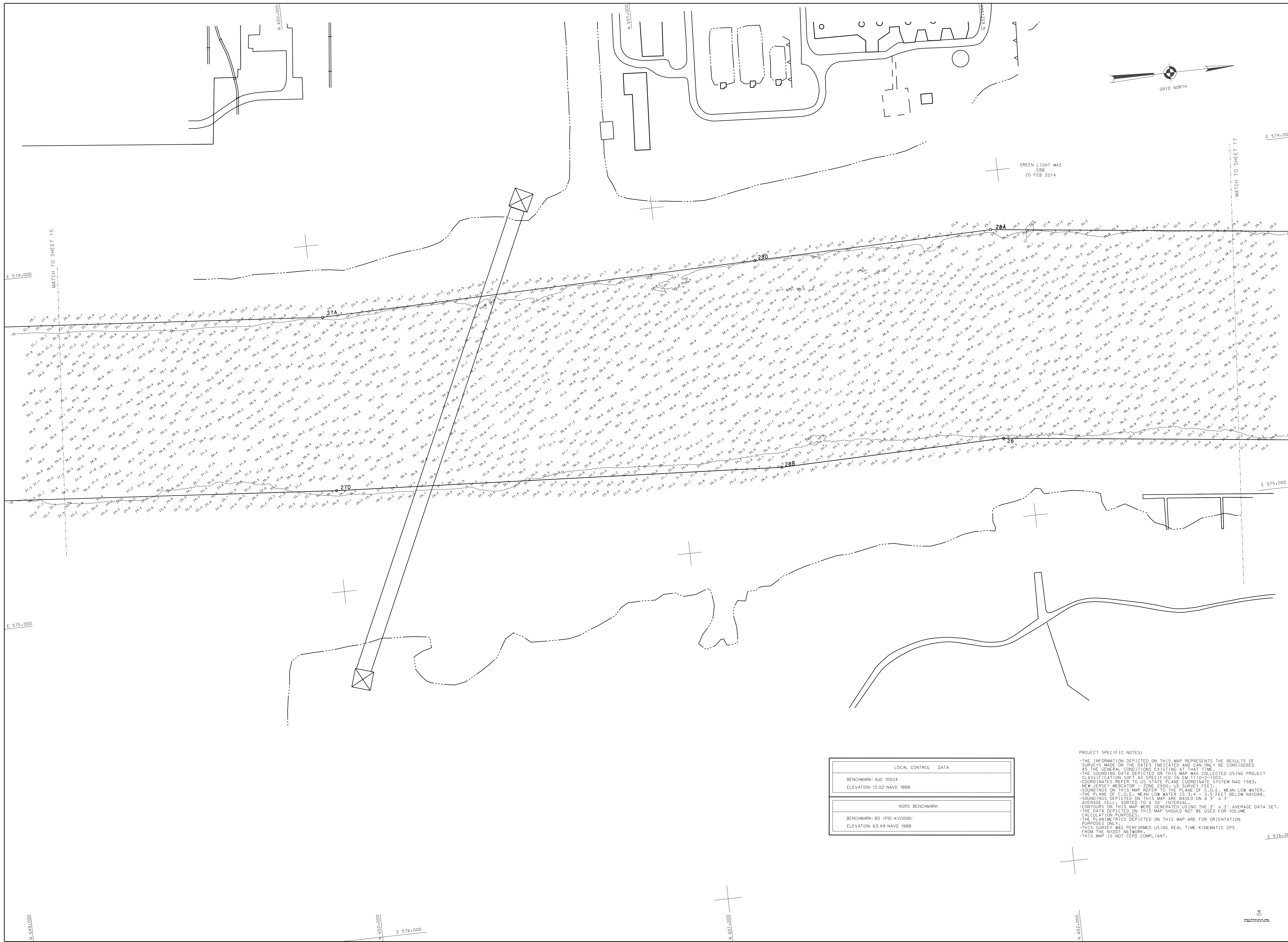

**US ARMY CORPS OF ENGINEERS NEW YORK DISTRICT**

ESD DR  
FILE NO.: 41030/43

**DATES OF SURVEY:** T-12-19-20-24-26 FEB 2014  
E-7 MAR 2014

**SCALE:** ONE INCH = 100 FEET  
**FIELD BOOKS:**

**APPROVED:** D. SMITH (RESTOREMENT)  
M. EDLIE (NON-RESTOREMENT)  
D. L. BAZ (FOR ORIENTATION)  
J. MARZ (NON-RESTOREMENT)

**DEPARTMENT OF THE ARMY  
CORPS OF ENGINEERS  
NEW YORK, NEW YORK 10278**

**OPERATIONS DIVISION  
SURVECTION  
CEMNAV-CORPS**

**NEW YORK & NEW JERSEY CHANNELS  
ARTHUR KILL  
CONDITIONS SURVEY**

LOCAL CONTROL DATA	
BENCHMARK: A/D 10024	ELEVATION: 13.02' NAVD 1988
NRSR BENCHMARK	
BENCHMARK: B5 (P/D: KV0006)	ELEVATION: 63.49' NAVD 1988

**PROJECT SPECIFIC NOTES:**  
- THE INFORMATION DEPICTED ON THIS MAP REPRESENTS THE RESULTS OF SURVEYS MADE ON THE DATES INDICATED AND CAN ONLY BE CONSIDERED AS THE GENERAL CONDITIONS EXISTING AT THAT TIME.  
- THE SOUNDINGS DATA DEPICTED ON THIS MAP WAS COLLECTED USING PROJECT CLASSIFICATION SPT AS SPECIFIED IN EM 1110-2-1003.  
- COORDINATES REFER TO US STATE PLANE COORDINATE SYSTEM NAD 1983, NEW JERSEY MERCATOR ZONE 200, US SURVEY FEET.  
- SOUNDINGS ON THIS MAP REFER TO THE PLANE OF C.D.L., MEAN LOW WATER.  
- THE PLANE OF C.D.L. = MEAN LOW WATER IS 2.4' - 2.5' FEET BELOW MAVORB.  
- SOUNDINGS DEPICTED ON THIS MAP ARE BASED ON A 3' x 3' AVERAGE CELL, SORTED TO A 30' INTERVAL.  
- CONTOURS ON THIS MAP WERE GENERATED USING THE 3' x 3' AVERAGE DATA SET.  
- THE DATA DEPICTED ON THIS MAP SHOULD NOT BE USED FOR VOLUME CALCULATION PURPOSES.  
- THIS SURVEY WAS PERFORMED USING REAL TIME KINEMATIC GPS FROM THE NYDOT NETWORK.  
- THIS MAP IS NOT CEPD COMPLIANT.



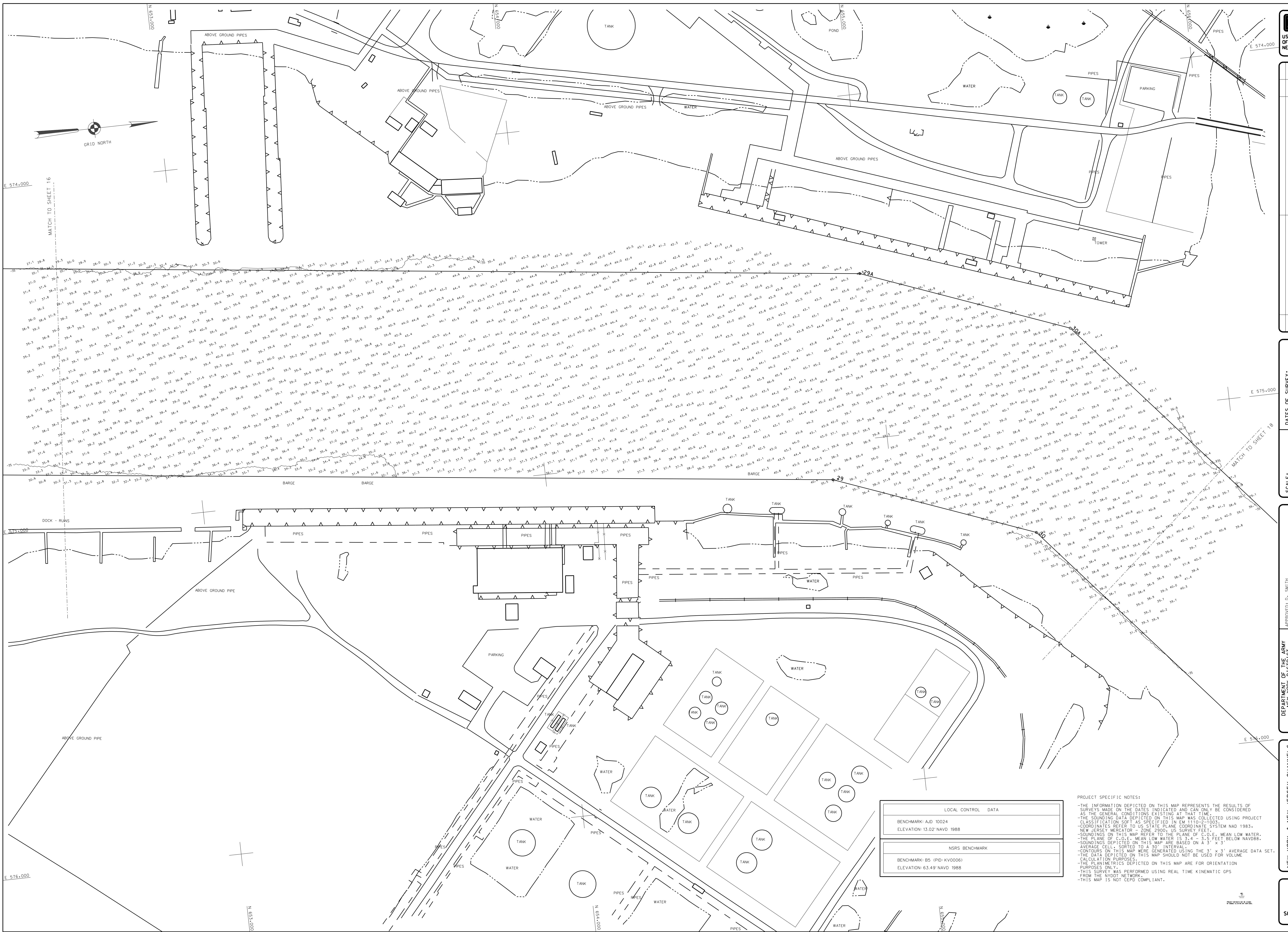
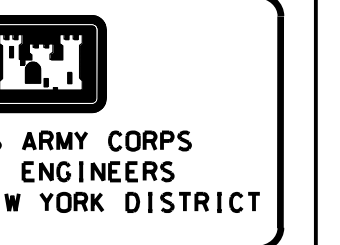

ESD	FILE
FOR	NO.

SCALE:	DATE OF SURVEY:
ONE INCH = 100 FEET	7-12-19-20-24-26 FEB 2014
FIELD BOOKS:	6-7 MAR 2014
	FILE NO.: 1360
	PROJECT NO.: 4103/N

APPROVED: D. SMITH	DATE: 13 MARCH 2014
APPROVED: M. EPIRE	
APPROVED: D. CLARK	
APPROVED: J. MARZ	

DEPARTMENT OF THE ARMY CORPS OF ENGINEERS NEW YORK - NEW YORK 10278
OPERATIONS DIVISION SURVEILLANCE CENNA/COPS

NEW YORK & NEW JERSEY CHANNELS ARTHUR KILL CONDITIONS SURVEY
--

VH-117
SHEET 17 OF 18

LOCAL CONTROL DATA
BENCHMARK: AJD 10024
ELEVATION: 13.02 NAVD 1988
NSRS BENCHMARK
BENCHMARK: BS (PID: KVD006)
ELEVATION: 63.49 NAVD 1988

PROJECT SPECIFIC NOTES:  
 -THE INFORMATION DEPICTED ON THIS MAP REPRESENTS THE RESULTS OF SURVEYS MADE ON THE DATES INDICATED AND CAN ONLY BE CONSIDERED AS THE GENERAL CONDITIONS EXISTING AT THAT TIME.  
 -THE SOUNDING DATA DEPICTED ON THIS MAP WAS COLLECTED USING PROJECT CLASSIFICATION SORT AS SPECIFIED IN EM 1110-2-1003.  
 -COORDINATES REFER TO US STATIC PLANE COORDINATE SYSTEM NAD 1983, NEW JERSEY MERCATOR ZONE 2900, US SURVEY FEET.  
 -SOUNDINGS ON THIS MAP REFER TO THE PLANE OF C.O.D.E. MEAN LOW WATER.  
 -THE PLANE OF C.O.D.E. MEAN LOW WATER IS 2.4 - 2.5 FEET BELOW NAVD88.  
 -SOUNDINGS DEPICTED ON THIS MAP ARE BASED ON 4.5' X 3' AVERAGE CELL, SORTED TO A 30' INTERVAL.  
 -CONTOURS ON THIS MAP WERE GENERATED USING THE 3' X 3' AVERAGE DATA SET. CALCULATION PURPOSES.  
 -THE PLANIMETRICS DEPICTED ON THIS MAP ARE FOR ORIENTATION PURPOSES ONLY.  
 -THIS SURVEY WAS PERFORMED USING REAL TIME KINEMATIC GPS FROM THE NYDOT NETWORK.  
 -THIS MAP IS NOT CEPD COMPLIANT.

