

LOCAL CONTROL DATA	
BENCHMARK: 853 2337 A TIDAL	ELEVATION: 14.83' (NAVD 1988)
NSRS BENCHMARK	
BENCHMARK: BELMAR (PID:KV0806)	ELEVATION: 14.20' (NAVD 1988)

PROJECT SPECIFIC NOTES:

- THE INFORMATION DEPICTED ON THIS MAP REPRESENTS THE RESULTS OF SURVEYS MADE ON THE DATES INDICATED AND CAN ONLY BE CONSIDERED AS THE GENERAL CONDITIONS EXISTING AT THAT TIME.
- THE SOUNDINGS ON THIS MAP MEET EM 1110-2-1003 ACCURACY STANDARDS.
- THIS MAP IS CEPD COMPLIANT IN ACCORDANCE WITH ER 1110-2-8160 AND EM 1110-2-6056.
- COORDINATES REFER TO US STATE PLANE COORDINATE SYSTEM NAD 1983, NEW JERSEY MERCATOR - ZONE 2900, US SURVEY FEET.
- SOUNDINGS ON THIS MAP REFER TO THE PLANE OF MEAN LOWER LOW WATER (MLLW) [EPOCH 1983-2001].
- MEAN LOWER LOW WATER IS 2.5 FEET BELOW NAVD88 AS DETERMINED USING VDATUM (VER. 4.3).
- SOUNDINGS DEPICTED ON THIS MAP ARE BASED ON A 3' x 3' MEDIAN CELL, SORTED TO A 30' INTERVAL.
- CONTOURS ON THIS MAP WERE GENERATED USING THE 3 x 3 DATA SET.
- THE DATA DEPICTED ON THIS MAP SHOULD NOT BE USED FOR VOLUME CALCULATION PURPOSES.
- AERIAL IMAGERY PROVIDED BY DISCOVER GIS DATA NY 2020 AND IS FOR ORIENTATION PURPOSES ONLY.
- THIS SURVEY WAS PERFORMED USING REAL TIME KINEMATIC GPS FROM STATION "BELMAR AZ MK".

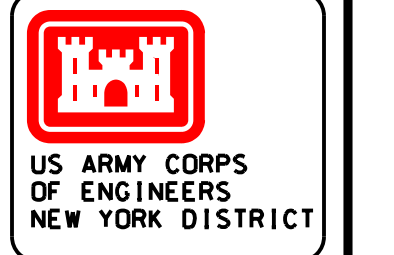

US ARMY CORPS OF ENGINEERS
NEW YORK DISTRICT

PR	EO:JHS
MP	JHS

DATES OF SURVEY:	REQ. NO./FILE NO.:
5 AUGUST 2022	10 AUG 2022

SCALE:	FIELD BOOKS:
ONE INCH = 100 FEET	1052

APPROVED:	N. VITELLO	FIELD CARTOGRAPHER
APPROVED:	M. FERRE	GEN. ENGINEERING TECHNICIAN
APPROVED:	P. BALDUIR	LEAD CARTOGRAPHER
APPROVED:	J. WRAZ	DEPUTY CHIEF OF SURVEY
DATE:	10 AUG 2022	

DEPARTMENT OF THE ARMY
U.S. ARMY CORPS OF ENGINEERS
NEW YORK DISTRICT
NEW YORK, NEW YORK 10278
OPERATIONS DIVISION
SURVEY SECTION
CENAN-OP-SS

SHARK RIVER INLET
NEW JERSEY
AFTER DREDGE SURVEY

VH-101
SHEET 1 OF 1

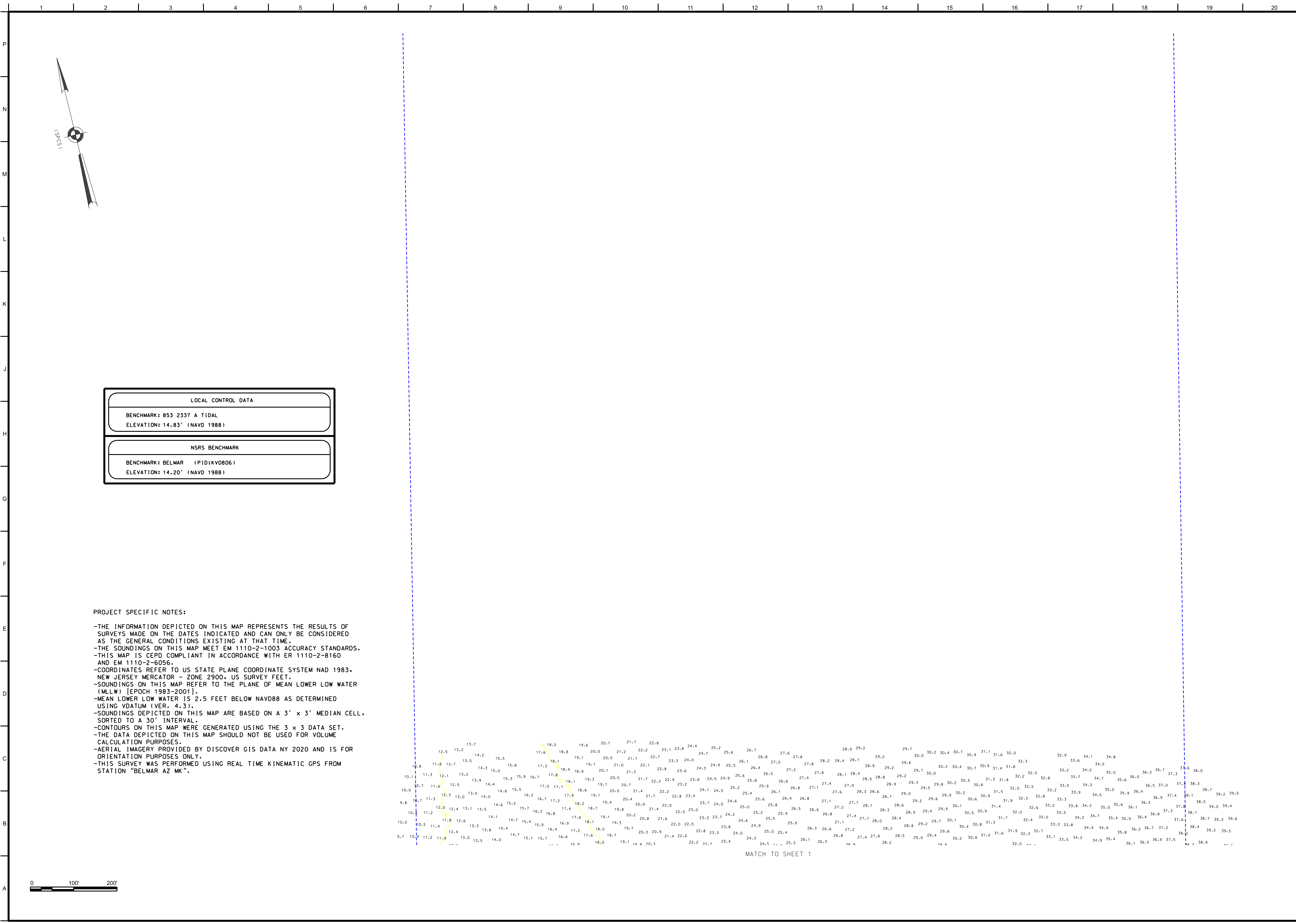

LOCAL CONTROL DATA	
BENCHMARK: 853 2337 A TIDAL	ELEVATION: 14.83' (NAVD 1988)
NSRS BENCHMARK	
BENCHMARK: BELMAR (PID:KV0806)	ELEVATION: 14.20' (NAVD 1988)

PROJECT SPECIFIC NOTES:

- THE INFORMATION DEPICTED ON THIS MAP REPRESENTS THE RESULTS OF SURVEYS MADE ON THE DATES INDICATED AND CAN ONLY BE CONSIDERED AS THE GENERAL CONDITIONS EXISTING AT THAT TIME.
- THE SOUNDINGS ON THIS MAP MEET EM 1110-2-1003 ACCURACY STANDARDS.
- THIS MAP IS CEPD COMPLIANT IN ACCORDANCE WITH ER 1110-2-8160 AND EM 1110-2-6056.
- COORDINATES REFER TO US STATE PLANE COORDINATE SYSTEM NAD 1983, NEW JERSEY MERCATOR - ZONE 2900, US SURVEY FEET.
- SOUNDINGS ON THIS MAP REFER TO THE PLANE OF MEAN LOWER LOW WATER (MLLW) [EPOCH 1983-2001].
- MEAN LOWER LOW WATER IS 2.5 FEET BELOW NAVD88 AS DETERMINED USING VDATUM (VER. 4.3).
- SOUNDINGS DEPICTED ON THIS MAP ARE BASED ON A 3' x 3' MEDIAN CELL, SORTED TO A 30' INTERVAL.
- CONTOURS ON THIS MAP WERE GENERATED USING THE 3 x 3 DATA SET.
- THE DATA DEPICTED ON THIS MAP SHOULD NOT BE USED FOR VOLUME CALCULATION PURPOSES.
- AERIAL IMAGERY PROVIDED BY DISCOVER GIS DATA NY 2020 AND IS FOR ORIENTATION PURPOSES ONLY.
- THIS SURVEY WAS PERFORMED USING REAL TIME KINEMATIC GPS FROM STATION "BELMAR AZ MK".

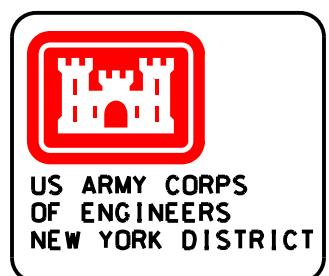
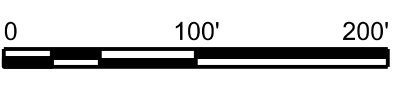

PR	EO-JHS
MP	JHS

DATES OF SURVEY:
5 AUG 2022

REQ. NO./FILE NO.: 5212/N4

SCALE:
ONE INCH = 100 FEET

FIELD BOOKS:
1052

APPROVED:	N. VITELLO	FIELD CARTOGRAPHER
APPROVED:	M. FORTI	CHIEF ENGINEERING TECHNICIAN
APPROVED:	P. BALDUIR	LEAD CARTOGRAPHER
APPROVED:	J. WRAZ	BRIFTY CHIEF OF SURVEY
DATE:	10 AUGUST 2022	

DEPARTMENT OF THE ARMY
U.S. ARMY CORPS OF ENGINEERS
NEW YORK DISTRICT
NEW YORK, NEW YORK 10278

OPERATIONS DIVISION
SURVEY SECTION
CENAN-OP-SS

SHARK RIVER INLET
NEW JERSEY
AFTER DREDGE SURVEY

VH-102
SHEET 2 OF 2

MATCH TO SHEET 1