

SOUTH LIMIT OF 8' PROJECT OF KEYPORT HARBOR CHANNEL
NORTH LIMIT OF 4' PROJECT OF MATAWAN CREEK CHANNEL

KEYPORT
HARBOR

RED NUN #12
FLOOD
21 MARCH 2013

RED NUN #10
FLOOD
21 MARCH 2013

RED NUN #8 W/LIGHT
FLOOD
21 MARCH 2013

GREEN CAN #9
FLOOD
21 MARCH 2013

GREEN CAN #7
FLOOD
21 MARCH 2013

LOCAL CONTROL DATA	
BENCHMARK: 853 1526 B TIDAL (IPID: KV3514)	
ELEVATION: 21.96' NAVD 1988	
NSRS BENCHMARK	
BENCHMARK: WALNUT (PID: KV0757)	
ELEVATION: 7.69' NAVD 1988	

NOTE:
THE INFORMATION DEPICTED ON THIS MAP REPRESENTS THE RESULTS OF SURVEYS MADE ON THE DATES INDICATED AND CAN ONLY BE CONSIDERED AS INDICATING THE GENERAL CONDITIONS EXISTING AT THE TIME.
COORDINATES REFER TO THE NEW JERSEY MERCATOR SYSTEM (NAD 1983).
SOUNDINGS REFER TO THE PLANE OF MEAN LOWER LOW WATER (MLLW), EPOCH (1983-2001) AS DEFINED IN NOAA'S DATUM 2.2.5 (NEW YORK HARBOR-NEW JERSEY, VERSION 02).
THE PLANE OF MLLW IS 2.9' BELOW NAVD 1988.
THE SOUNDING DATA DEPICTED ON THIS MAP WAS COLLECTED USING PROJECT CLASSIFICATION-GENERAL, AS DEFINED IN EM 1110-2-1003.
THE CONTOUR ON THIS MAP WAS CREATED FROM THE FULL DATA SET. THIS DATA ON THIS MAP IS REPRESENTATIVE OF A LARGER DATA SET. THIS SURVEY WAS PERFORMED USING RTK GPS FROM RTK KEYPORT.

DEPARTMENT OF THE ARMY CORPS OF ENGINEERS NEW YORK, NEW YORK 10278	
OPERATIONS DIVISION SURVEY SECTION CENANOPC	
APPROVED: M. APPELO	REVISIONS
APPROVED: M. EHRTE	REVISION
APPROVED: D. CLARKE	FOR COMMENT
APPROVED: J. MARZETZ	FOR DISCUSSION
DATE: 26 MARCH 2013	
KEYPORT HARBOR & MATAWAN CREEK KEYPORT, NEW JERSEY STATUS SURVEY POST HURRICANE IRENE	
VH101	
SHEET 1 OF 3	

DATES OF SURVEY: 15, 16, 21 MARCH 2013	
FIELD BOOKS: FILE NO: 184 PROJECT NO: 13349Z	
SCALE: ONE INCH = 100 FEET	

LOCAL CONTROL DATA	
BENCHMARK: 853 1526 B TIDAL (IPID: KV3514)	
ELEVATION: 21.96' NAVD 1988	
NSRS BENCHMARK	
BENCHMARK: WALNUT (PID: KV0757)	
ELEVATION: 7.69' NAVD 1988	

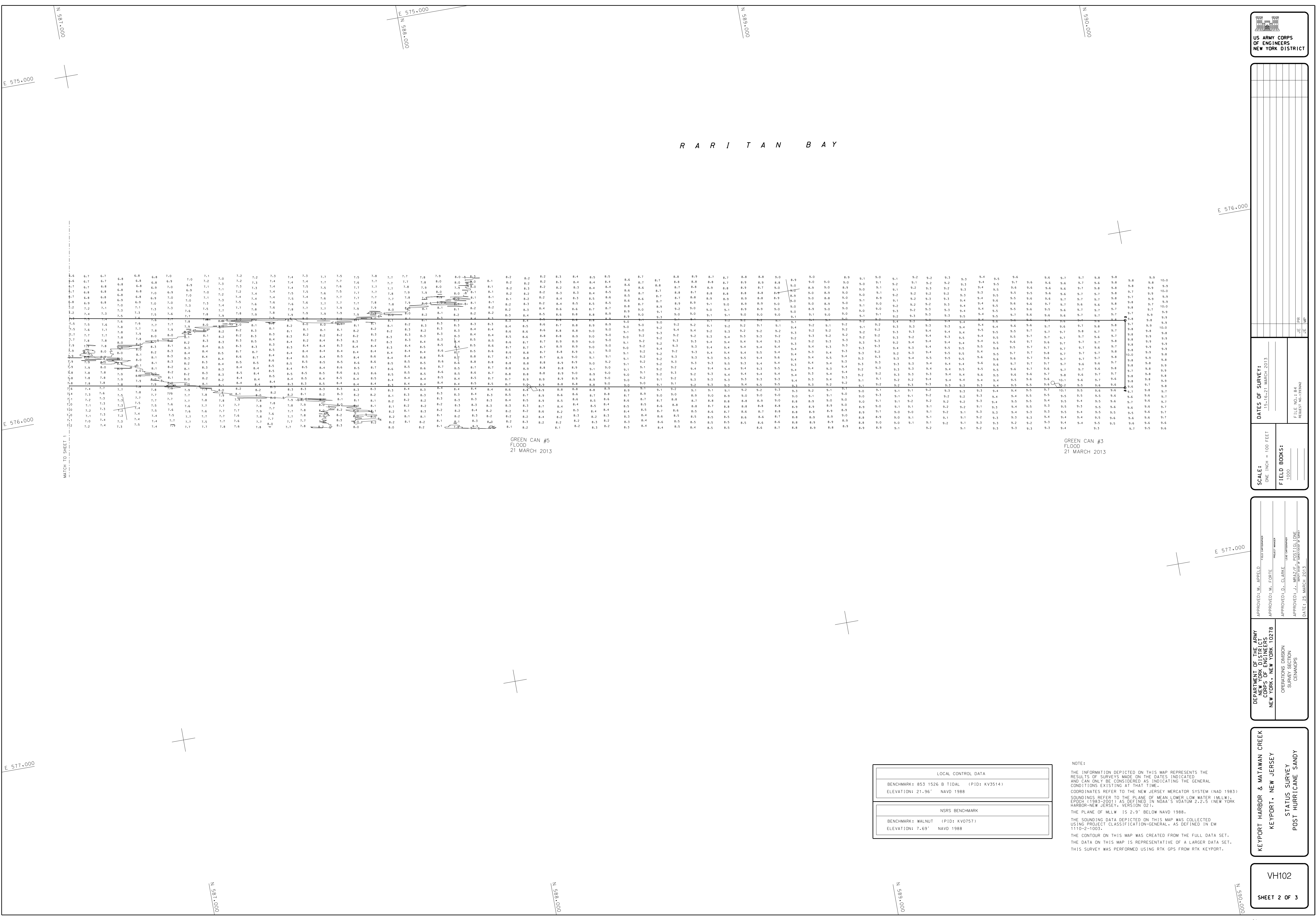

R A R I T A N B A Y

GREEN CAN #5
FLOOD
21 MARCH 2013

GREEN CAN #3
FLOOD
21 MARCH 2013

LOCAL CONTROL DATA	
BENCHMARK: 853 1526 B TIDAL (PID: KV3514)	
ELEVATION: 21.96'	NAVD 1988
NSRS BENCHMARK	
BENCHMARK: WALNUT (PID: KV0757)	
ELEVATION: 7.69'	NAVD 1988

NOTE:
THE INFORMATION DEPICTED ON THIS MAP REPRESENTS THE RESULTS OF SURVEYS MADE ON THE DATES INDICATED AND CAN ONLY BE CONSIDERED AS INDICATING THE GENERAL CONDITIONS EXISTING AT THAT TIME.
COORDINATES REFER TO THE NEW JERSEY MERCATOR SYSTEM (NAD 1983) SOUNDINGS REFER TO THE PLANE OF MEAN LOWER LOW WATER (MLLW) EPOCH (1983-2001) AS DEFINED IN NOAA'S DATUM 2.2.15 (NEW YORK HARBOR-NEW JERSEY, VERSION 02).
THE PLANE OF MLLW IS 2.9' BELOW NAVD 1988.
THE SOUNDING DATA DEPICTED ON THIS MAP WAS COLLECTED USING PROJECT CLASSIFICATION-GENERAL, AS DEFINED IN EM 1110-2-1003.
THE CONTOUR ON THIS MAP WAS CREATED FROM THE FULL DATA SET. THE DATA ON THIS MAP IS REPRESENTATIVE OF A LARGER DATA SET. THIS SURVEY WAS PERFORMED USING RTK GPS FROM RTK KEYPORT.

DEPARTMENT OF THE ARMY
CORPS OF ENGINEERS
NEW YORK, NEW YORK 10278

OPERATIONS DIVISION
SUBDIVISION
CENNAOCP

STATUS SURVEY
POST HURRICANE SANDY

APPROVED: M. ARPELLO
APPROVED: M. EDRIE
APPROVED: D. CLARKE
APPROVED: J. ARIZALE
DATE: 26 MARCH 2013

SCALE: ONE INCH = 100 FEET
FIELD BOOKS: 1000

DATES OF SURVEY: 15, 16, 21 MARCH 2013
FILE NO.: 84
PROJECT NO.: 133842

VH102
SHEET 2 OF 3

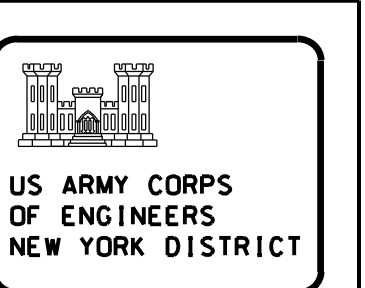
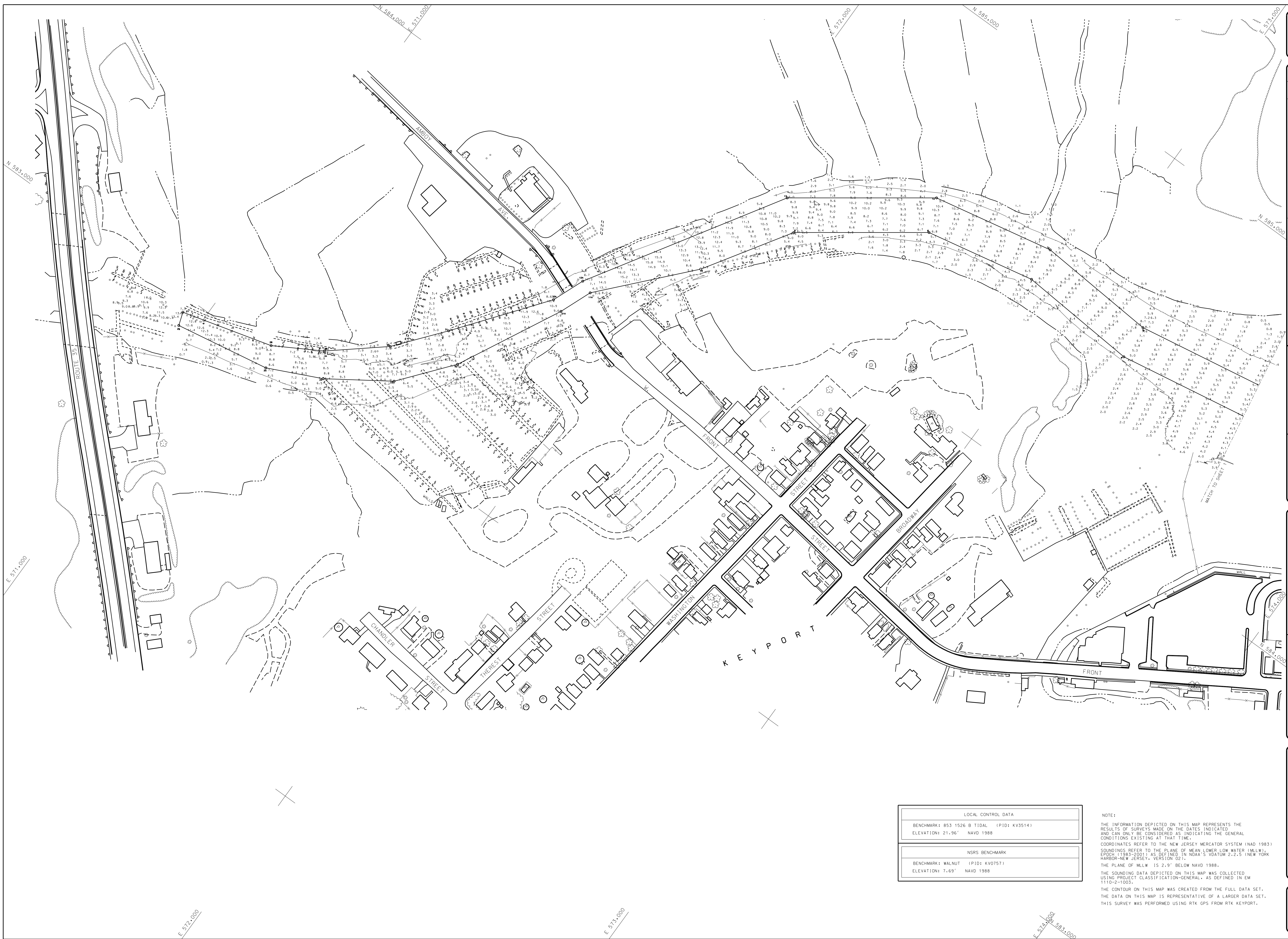

US ARMY CORPS OF ENGINEERS NEW YORK DISTRICT

DATES OF SURVEY: 15-16-17 MARCH 2013	
SCALE: ONE INCH = 100 FEET	FIELD BOOKS: 1000
FILE NO.: 884 PROJECT NO.: 13838	

APPROVED: M. APPELO DATE: 25 MARCH 2013	APPROVED: J. MARLIZ DATE: 25 MARCH 2013
APPROVED: M. ERBE DATE: 25 MARCH 2013	APPROVED: J. MARLIZ DATE: 25 MARCH 2013

DEPARTMENT OF THE ARMY
CORPS OF ENGINEERS
NEW YORK, NEW YORK 10278

OPERATIONS DIVISION
SURVEY SECTION
CENANOPS

KEYPORT HARBOR & MATAWAN CREEK
KEYPORT, NEW JERSEY
STATUS SURVEY
POST HURRICANE SANDY

VH103
SHEET 3 OF 3

LOCAL CONTROL DATA	
BENCHMARK: 853 1526 B TIDAL (PID: KV3514)	ELEVATION: 21.96' NAVD 1988
NSRS BENCHMARK	
BENCHMARK: WALNUT (PID: KV0757)	ELEVATION: 7.69' NAVD 1988

NOTE:
THE INFORMATION DEPICTED ON THIS MAP REPRESENTS THE RESULTS OF SURVEYS MADE ON THE DATES INDICATED AND CAN ONLY BE CONSIDERED AS INDICATING THE GENERAL CONDITIONS EXISTING AT THAT TIME.
COORDINATES REFER TO THE NEW JERSEY MERCATOR SYSTEM (NAD 1983) SOUNDINGS REFER TO THE PLANE OF MEAN LOWER LOW WATER (MLLW) EPOCH (1985-2001) AS DEFINED IN NOAA S-5700.2-2-51 (NEW YORK HARBOR-NEW JERSEY, VERSION 02).
THE PLANE OF MLLW IS 2.9' BELOW NAVD 1988.
THE SOUNDING DATA DEPICTED ON THIS MAP WAS COLLECTED USING PROJECT CLASSIFICATION-GENERAL, AS DEFINED IN EM 1110-2-1003.
THE CONTOUR ON THIS MAP WAS CREATED FROM THE FULL DATA SET. THE DATA ON THIS MAP IS REPRESENTATIVE OF A LARGER DATA SET. THIS SURVEY WAS PERFORMED USING RTK GPS FROM RTK KEYPORT.