

ONE INCH = 100 FEET

---

FIELD BOOKS:

N/A \_\_\_\_\_

\_\_\_\_\_

\_\_\_\_\_

**McKIM & CREED**  
 243 NORTH FRONT STREET  
 WILMINGTON, NORTH CAROLINA 28401  
 TELEPHONE: (910) 343-1048  
 FAX: (910) 251-8287

VH-110

SHEET 1 OF 2

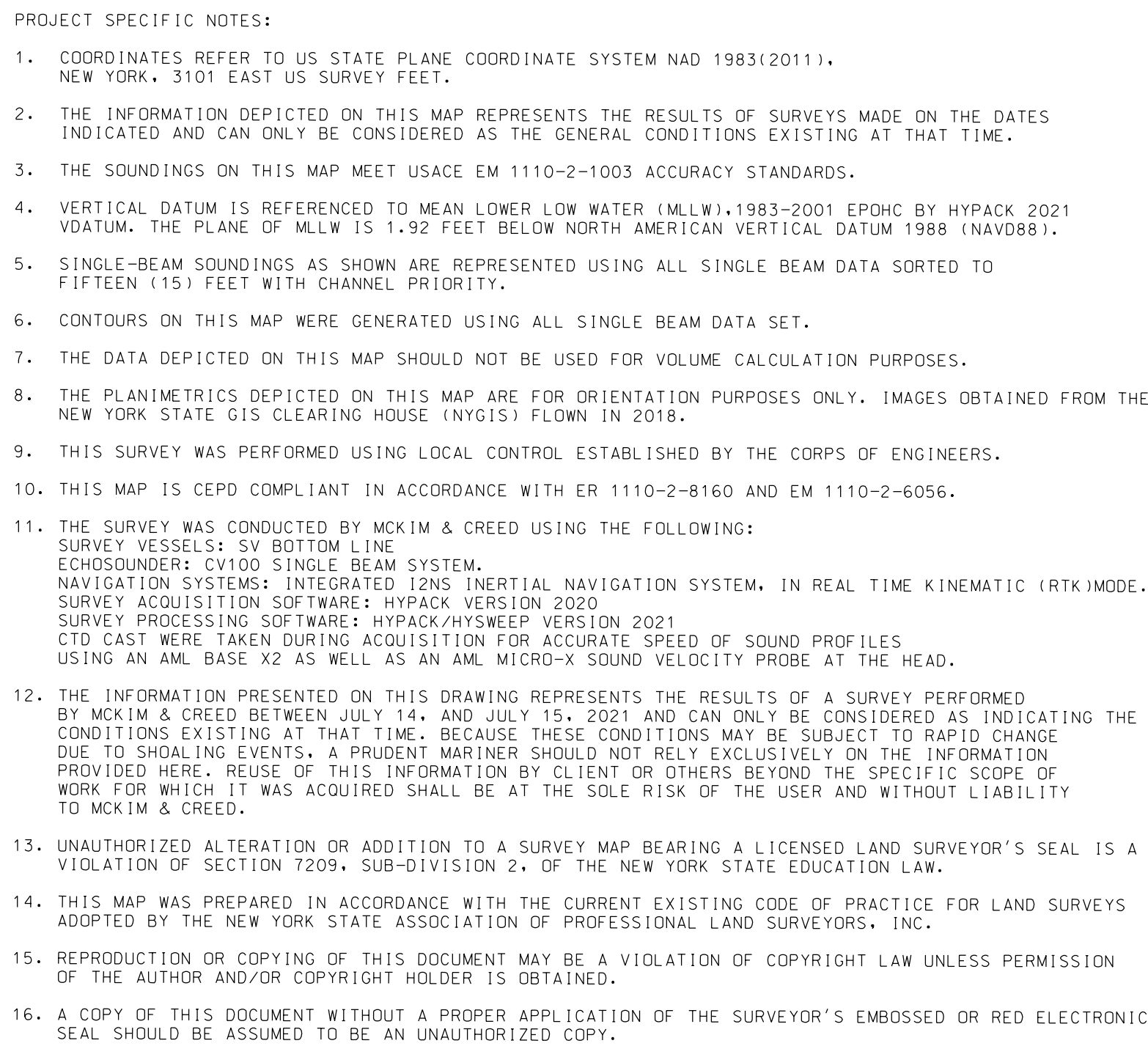

666.000

REQ. NO./FILE NO.:5069



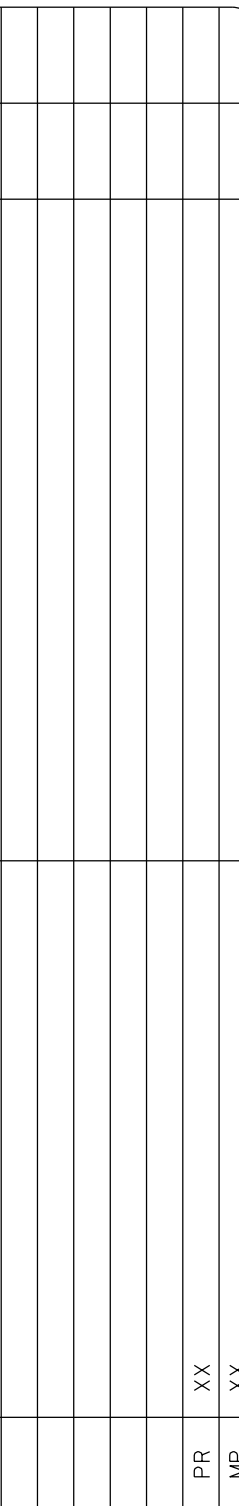

JULY 14-15, 2021

---



---

REQ NO./FILE NO.:5069

ONE INCH = 100 FEET

---

FIELD BOOKS:

N/A \_\_\_\_\_

\_\_\_\_\_

\_\_\_\_\_

APPROVED: M. FORTÉ  
CIVIL ENGINEERING TECHNICIAN

APPROVED: P. BHADUR  
LEAD CARTOGRAPHER

APPROVED: J. MRAZ  
DEPUTY CHIEF OF SURVEY

DATE: JULY 26, 2021

**McKIM & CREED**  
CORPS OF ENGINEERS  
NEW YORK, NEW YORK 10278  
243 NORTH FRONT STREET  
WILMINGTON, NORTH CAROLINA 28401  
TELEPHONE: (910) 343-1048  
FAX: (910) 251-8282

TARRYTOWN HARBOR  
NEW YORK

1/11-110

SHEET 2 OF 2

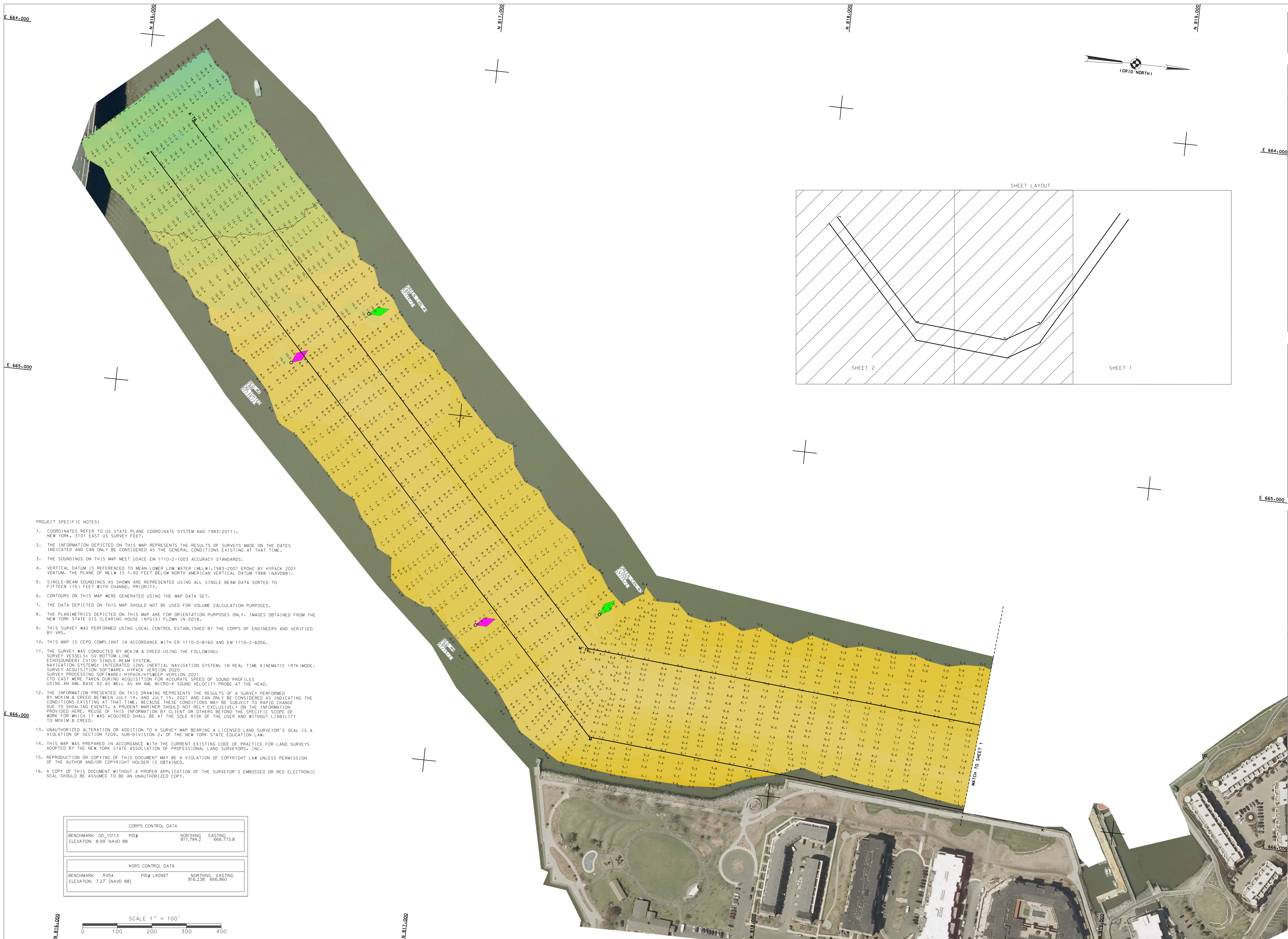

PROJECT SPECIFIC NOTES:

- COORDINATES REFER TO US STATE PLANE COORDINATE SYSTEM NAD83 (2011), NEW YORK, 3101 EAST US SURVEY FEET.
- THE INFORMATION DEPICTED ON THIS MAP REPRESENTS THE RESULTS OF SURVEYS MADE ON THE DATES INDICATED AND CAN ONLY BE CONSIDERED AS THE GENERAL CONDITIONS EXISTING AT THAT TIME.
- THE SOUNDINGS ON THIS MAP MEET USACE ANL 1110-2-1003 ACQUISITION STANDARDS.
- VERTICAL DATUM IS REFERENCED TO MEAN LOWER LOW WATER (MLLW), 1983-2001 EPOCH BY HYPACK 2021 DATUM. THE PLANE OF MLLW IS 1.92 FEET BELOW NORTH AMERICAN VERTICAL DATUM 1988 (NAV88).
- SINGLE-BEAM SOUNDINGS AS SHOWN ARE REPRESENTED USING ALL SINGLE BEAM DATA SORTED TO FIFTEEN (15) FEET WITH CHANNEL PRIORITY.
- CONTOURS ON THIS MAP WERE GENERATED USING THE MAP DATA SET.
- THE DATA DEPICTED ON THIS MAP SHOULD NOT BE USED FOR VOLUME CALCULATION PURPOSES.
- THE PLANIMETRICS DEPICTED ON THIS MAP ARE FOR ORIENTATION PURPOSES ONLY. IMAGES OBTAINED FROM THE NEW YORK STATE GIS CLEARING HOUSE (NYGIS) FLOWN IN 2018.
- THIS SURVEY WAS PERFORMED USING LOCAL CONTROL ESTABLISHED BY THE CORPS OF ENGINEERS AND VERIFIED BY VRS.
- THIS MAP IS CEPD COMPLIANT IN ACCORDANCE WITH ER 1110-2-8160 AND EM 1110-2-6056.
- THE SURVEY WAS CONDUCTED BY MKC/M & CREED USING THE FOLLOWING:  
SURVEY VESSELS: SV BOTTOM LINE  
ECHOSOUNDERS: CVID5 SINGLE BEAM SYSTEM.  
NAVIGATION SYSTEMS: INTEGRATED 1301 INERTIAL NAVIGATION SYSTEM. IN REAL TIME KINEMATIC (RTK) MODE.  
SURVEY ACQUISITION SOFTWARE: HYPACK VERSION 2020  
SURVEY PROCESSING SOFTWARE: HYPACK/HYSWEEP VERSION 2021  
C/O CAST WERE TAKEN DURING ACQUISITION FOR ACCURATE SPEED OF SOUND PROFILES  
USING AN ANI BASE X2 AS WELL AS AN ANI MICRO-X SOUND VELOCITY PROBE AT THE HEAD.
- THE INFORMATION PRESENTED ON THIS DRAWING REPRESENTS THE RESULTS OF A SURVEY PERFORMED BY MKC/M & CREED BETWEEN JULY 14, AND JULY 15, 2021 AND CAN ONLY BE CONSIDERED AS INDICATING THE CONDITIONS EXISTING AT THAT TIME. BECAUSE THESE CONDITIONS MAY BE SUBJECT TO RAPID CHANGE, THE USER SHOULD UNDERSTAND THAT THE USER SHOULD NOT RELY EXCLUSIVELY ON THE INFORMATION PROVIDED HERE. REUSE OF THIS INFORMATION BY CLIENT OR OTHERS BEYOND THE SPECIFIC SCOPE OF WORK FOR WHICH IT WAS ACQUIRED SHALL BE AT THE SOLE RISK OF THE USER AND WITHOUT LIABILITY TO MKC/M & CREED.
- UNAUTHORIZED ALTERATION OR ADDITION TO A SURVEY MAP BEARING A LICENSED LAND SURVEYOR'S SEAL IS A VIOLATION OF SECTION 7029, SUB-DIVISION 2, OF THE NEW YORK STATE EDUCATION LAW.
- THIS MAP WAS PREPARED IN ACCORDANCE WITH THE CURRENT EXISTING CODE OF PRACTICE FOR LAND SURVEYS ADOPTED BY THE NEW YORK STATE ASSOCIATION OF PROFESSIONAL LAND SURVEYORS, INC.
- REPRODUCTION OR COPYING OF THIS DOCUMENT MAY BE A VIOLATION OF COPYRIGHT LAW UNLESS PERMISSION OF THE AUTHOR AND/OR COPYRIGHT HOLDER IS OBTAINED.
- A COPY OF THIS DOCUMENT WITHOUT A PROPER APPLICATION OF THE SURVEYOR'S EMBOSSED OR RED ELECTRONIC SEAL SHOULD BE ASSUMED TO BE AN UNAUTHORIZED COPY.

CORPS CONTROL DATA			
BENCHMARK:	CD_10113	PID#	NORTHING
ELEVATION:	8.99' NAVD 88		817,794.2
			EASTING
			666,773.8

NSRS CONTROL DATA			
BENCHMARK:	RY54	PID# LX0997	NORTHING
ELEVATION:	7.27' (NAVD 88)		816,238
			EASTING
			666,960

N 816.000

N 817.000

EQ NO./FILE NO.:5069