



PUBLIC NOTICE

U.S. Army Corps
of Engineers
New York District, CENAN-OP-R
Upstate Regulatory Field Office
1 Buffington Street, Bldg. 10, 3rd Floor
Watervliet, New York 12189-4000

In replying refer to:

Public Notice Number: NAN-2016-01391-UCO

Issue Date: **DEC 22 2016**

Expiration Date: **IAN 20 2017**

To Whom It May Concern:

The New York District, Corps of Engineers has received an application for a Department of the Army permit pursuant to Section 10 of the Rivers and Harbors Act of 1899 (33 U.S.C. 403).

APPLICANT: City of Plattsburgh
41 City Hall Place
Plattsburgh, NY 12901

ACTIVITY: To expand an existing mooring facility and establish marina services

WATERWAY: Lake Champlain (Cumberland Bay)

LOCATION: City of Plattsburgh, Clinton County, New York

A detailed description and plans of the applicant's activity are enclosed to assist in your review.

The decision whether to issue a permit will be based on an evaluation of the probable impact including cumulative impacts of the proposed activity on the public interest. That decision will reflect the national concern for both protection and utilization of important resources. The benefit which reasonably may be expected to accrue from the proposal must be balanced against its reasonably foreseeable detriments. All factors which may be relevant to the proposal will be considered including the cumulative effects thereof; among those are conservation, economics, aesthetics, general environmental concerns, wetlands, historic properties, fish and wildlife values, flood hazards, floodplain values, land use, navigation, shoreline erosion and accretion, recreation, water supply and conservation, water quality, energy needs, safety, food and fiber production, mineral needs, considerations of property ownership and, in general, the needs and welfare of the people.

The Corps of Engineers is soliciting comments from the public; Federal, state, and local agencies and officials; Indian Tribes; and other interested parties in order to consider and evaluate the impacts of this proposed activity. Any comments received will be considered by the Corps of Engineers to determine whether to issue, modify, condition or deny a permit for this proposal. To make this decision, comments are used to assess impacts on endangered species, historic properties, water quality, general environmental effects, and the other public interest factors listed above. Comments are used in preparation of an Environmental Assessment and/or an Environmental Impact Statement pursuant to the National Environmental Policy Act. Comments are also used to determine the need for a public hearing and to determine the overall public interest of the proposed activity.

ALL COMMENTS REGARDING THE PERMIT APPLICATION MUST BE PREPARED IN WRITING AND MAILED TO THE ATTENTION OF John Connell AT THE ABOVE ADDRESS, OR SENT VIA ELECTRONIC MAIL TO john.r.connell@usace.army.mil, TO REACH THIS OFFICE

BY THE EXPIRATION DATE OF THIS NOTICE, otherwise, it will be presumed that there are no objections to the activity.

Comments submitted in response to this notice will be fully considered during the public interest review for this permit application. Comments provided will become part of the public record for this permit application. All written comments, including contact information, will be made a part of the administrative record, available to the public under the Freedom of Information Act. The Administrative Record, or portions thereof, may also be posted on a Corps of Engineers internet web site. Due to resource limitations, this office will normally not acknowledge the receipt of comments or respond to individual letters of comment.

Any person may request, in writing, before this public notice expires, that a public hearing be held to collect information necessary to consider this application. Requests for public hearings shall state, with particularity, the reasons why a public hearing should be held. It should be noted that information submitted by mail is considered just as carefully in the permit decision process and bears the same weight as that furnished at a public hearing.

Our preliminary determination is that the activity for which authorization is sought herein will not affect Federally endangered or threatened species or their critical habitat. However, pursuant to Section 7 of the Endangered Species Act (16 U.S.C. 1531), if new information warrants, the District Engineer will consult with the appropriate Federal agency to determine the presence of and any potential impacts to listed species or their critical habitat in the project area.

Based upon information provided by the applicant, the project site is located in the vicinity of two sites eligible for listing in the National Register of Historic Places (Register), namely the Bay of Plattsburgh and the D & H Railroad Station. By letter dated September 8, 2016, the New York State Office of Parks, Recreation and Historic Preservation (SHPO) indicated that this undertaking will have no adverse effect on sites eligible for listing in the Register. Further consultation with SHPO regarding this undertaking will be conducted, if necessary, and will be concluded prior to the final decision.

The applicant has obtained or requested the following governmental authorization for the activity under consideration:

- Use of State Owned Lands Underwater from the New York State Office of General Services
- Docks, Moorings or Platforms permit from the New York State Department of Environmental Conservation

In order for us to better serve you, please complete our Customer Service Survey located at:

<http://www.nan.usace.army.mil/Missions/Regulatory/CustomerSurvey.aspx>

It is requested that you communicate the foregoing information concerning the activity to any persons known by you to be interested and who did not receive a copy of this notice. If you have any questions concerning this application, you may contact John Connell of this office at (518) 266-6357, or via electronic mail at john.r.connell@usace.army.mil.

For more information on New York District Corps of Engineers programs, visit our website at <http://www.nan.usace.army.mil>



For and in behalf of

Stephan A. Ryba
Chief, Regulatory Branch

Enclosures

WORK DESCRIPTION

The applicant, the City of Plattsburgh, has requested a Department of the Army permit for a proposal to expand an existing mooring facility and establish marina services, in Lake Champlain, at the Plattsburgh City Marina, located at 2 Dock St., in the City of Plattsburgh, Clinton County, New York.

The work would involve the placement of additional floating piers to add 72 new boat slips to the existing facility, which consists of 32 boat slips and 25 mooring buoys. All existing and proposed boat slips would have access to electrical service, lighting, potable water, a security system and Wi-Fi service. In addition, the proposed facility would be equipped with two sewage pump-out stations.

The proposed floating pier assembly would consist of extending the existing 8' wide by 121' long access pier by 43 feet, for a total length of 164', and adding an additional 8' wide by 80' long access pier. Both of these access piers would be oriented parallel to the shoreline and the 164' pier attached to shore by the existing 30' by 4' gangway. The 80' pier would have four (4) 28' by 4' fingers and one (1) 32' by 4' finger attached to its west side for boat slips. The 80' pier would also have a 260' long by 8' wide main pier attached to its east side near its northern terminus and oriented perpendicular to the shoreline. This main pier would have fourteen (14) 28' by 4' fingers and two (2) 28' by 8' fingers attached to its northern and southern sides for boat slips. The 164' pier would have a 292' long by 8' wide main pier attached to its northern terminus and oriented perpendicular to the shoreline. This 292' main pier would have thirteen (13) 32' by 4' fingers and two (2) 32' by 8' fingers attached to its northern and southern sides for boat slips. The 164' pier would also have a 385.5' long by 8' wide main pier attached to its southern terminus and oriented perpendicular to the shoreline. This 385.5' main pier would have eight (8) 40' by 4' fingers attached to its northern side for boat slips. The 385.5' main pier would also have a 301' long by 10' wide floating wave attenuator attached to its eastern terminus and oriented at an oblique angle to the shoreline. This 301' wave attenuator would have seven (7) 48' by 6' fingers attached to its northwestern side for boat slips. The facility would maintain the existing 25 mooring buoys, for a total proposed mooring capacity of 129 vessels. The facility would also maintain the existing reconfiguration perimeter, consisting of approximately 25 acres of the Lake. The northeast and southeast corners of this perimeter are proposed to be marked with floating buoys.

The stated purpose of this project is to expand public access to Lake Champlain for recreational boating.

NOTE 2 NO-DISCHARGE ZONE, 49 CFR 140

Under the Clean Water Act, Section 312, all vessels operating within a No-Discharge Zone (NDZ) are completely prohibited from discharging any sewage, treated or untreated, into the waters. All vessels with an installed marine sanitation device (MSD) that are navigably, moored, anchored, or docked within a NDZ must have the MSD disabled to prevent the overboard discharge of sewage (treated or untreated) or install a holding tank. Regulations for the NDZ are contained in the U.S. Coast Pilot. Additional information concerning the regulations and requirements may be obtained from the Environmental Protection Agency (EPA) web site: <http://www.epa.gov/owow/cleanair/ndz/ndz.html>.

POLLUTION REPORTS

Report all spills of oil and hazardous substances to the National Response Center via 1-800-424-8802 (toll free), or to the nearest U.S. Coast Guard facility if telephone communication is impossible (33 CFR 153).

PLATTSBURGH

SARANAC RIVER

O

R

K

PLATTSBURGH AIR FORCE BASE

Joins page 8

City of Plattsburgh Marina

National Oceanic & Atmospheric Administration
(NOAA)
Great Lakes-Lake Champlain
Cumberland Head To Four Brothers Island
#14782 - Page 4

Note: Chart grid lines are aligned with true north.

Printed at reduced scale,

SCALE 1:40,000

See Note on page 5.



Applicant: City of Plattsburgh Marina
Location: Plattsburgh, NY - Lake Champlain
Description: Site Vicinity Map

Date: 9/28/16

Sheet NO: 1 OF 10

Drawn: K. Jewell

Approved:



WATERFRONT SOLUTIONS
Consulting Group, Inc.

19 Little Otter Lane
Ferrisburg, VT 05456

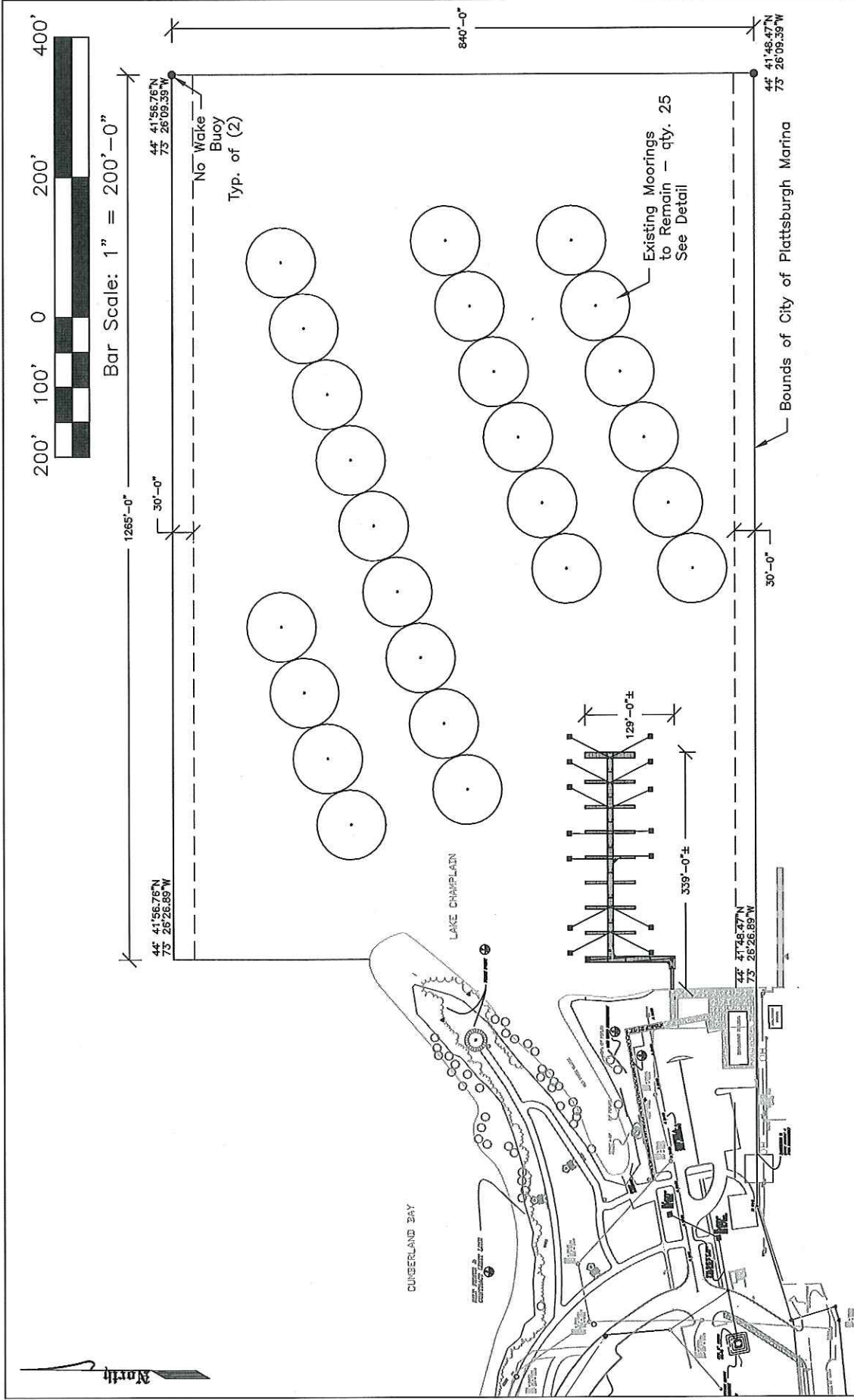

NOTE: Longitude/Latitude coordinates approximate per 'Google Earth'

Applicant: City of Plattsburgh Marina	
Location: Plattsburgh, NY - Lake Champlain	
Description: Existing Conditions	
Date: 9/28/16	
Sheet NO: 3 OF 10	
Drawn: K. Jewell	
Approved:	

WATERFRONT SOLUTIONS
Consulting Group, Inc.

19 Little Otter Lane
 Ferrisburg, VT 05456

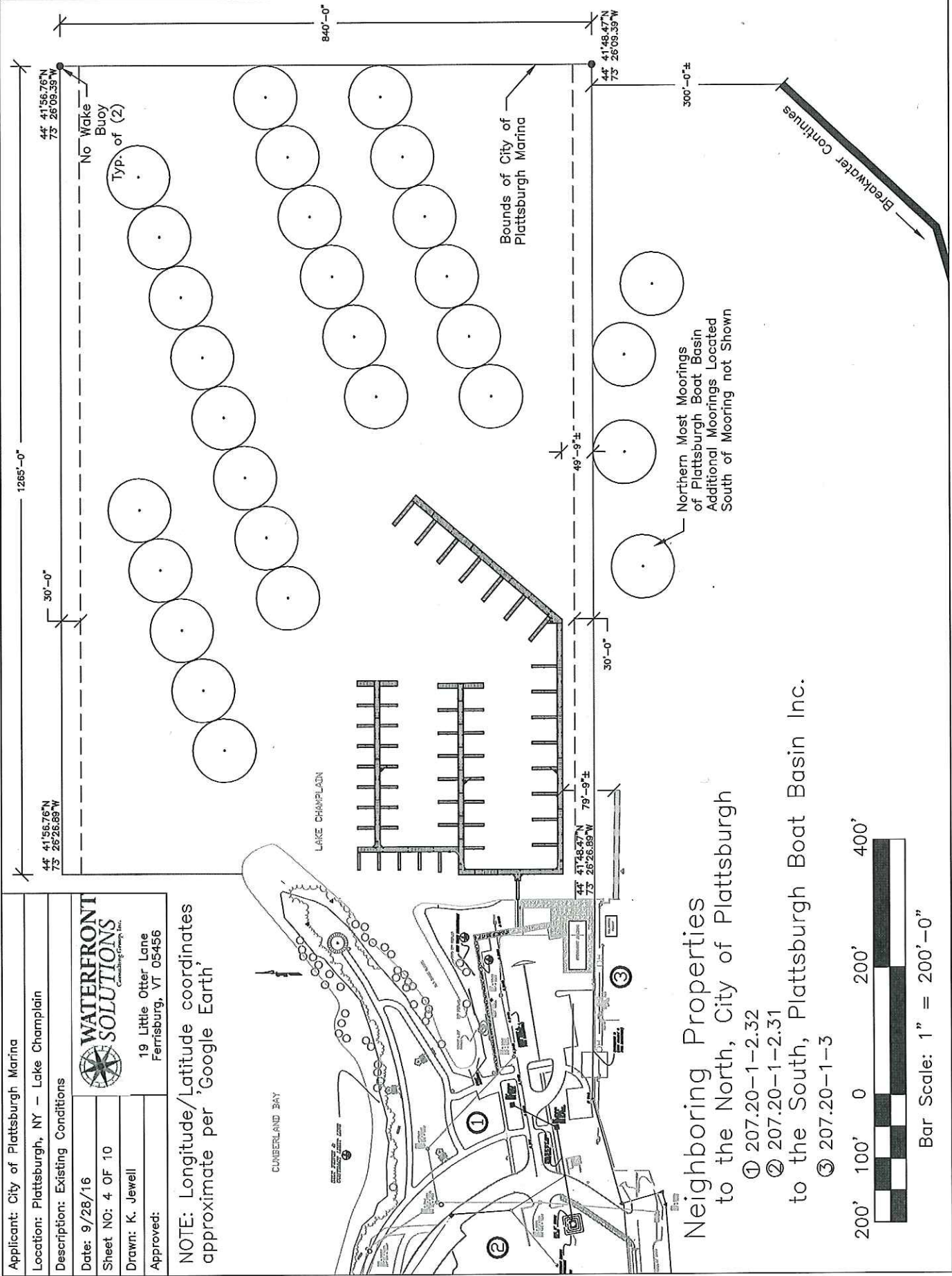

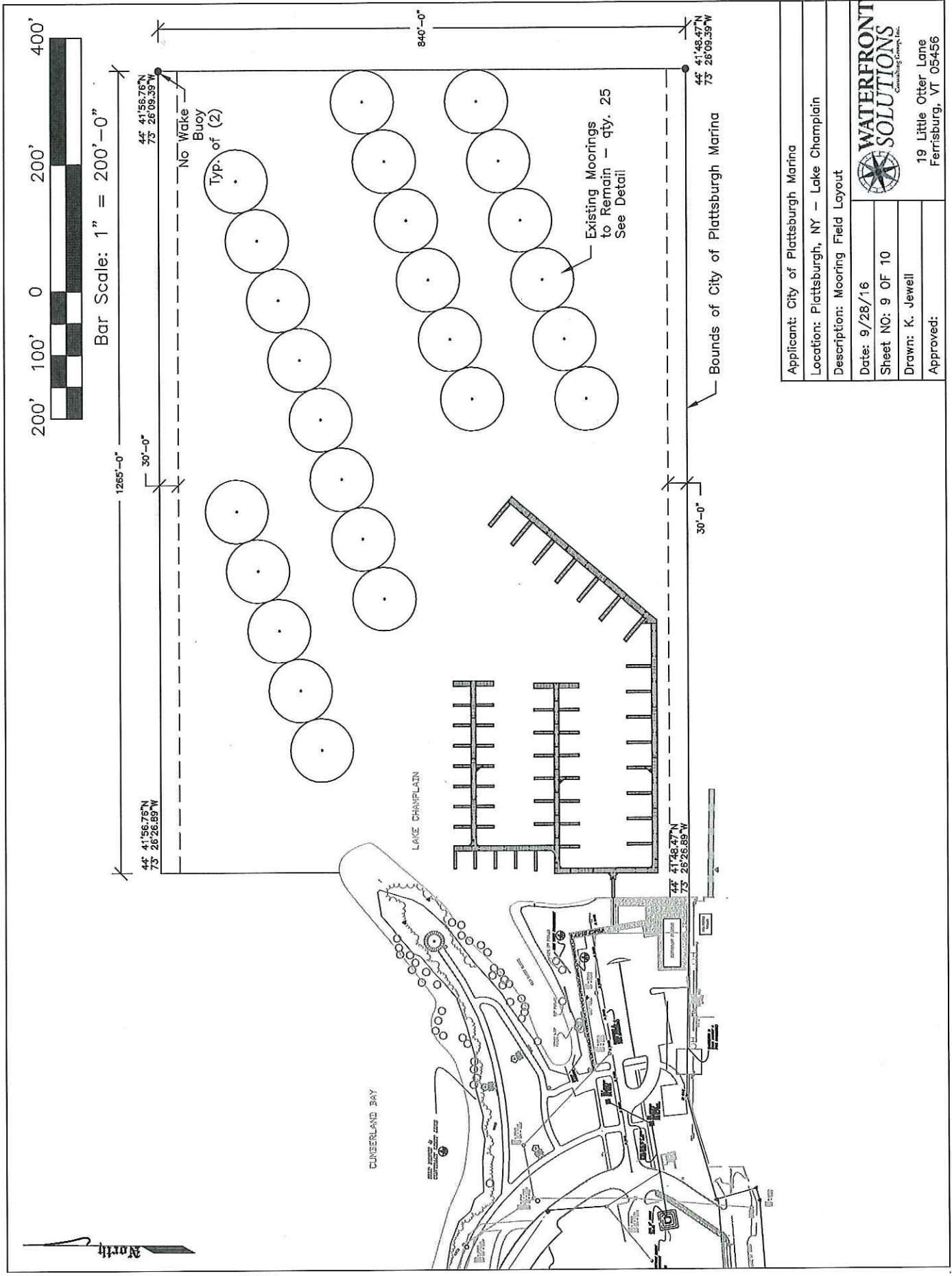

Applicant: City of Plattsburgh Marina	
Location: Plattsburgh, NY – Lake Champlain	
Description: Mooring Field Layout	
Date: 9/28/16	 WATERFRONT SOLUTIONS <small>Consulting Group, Inc.</small>
Sheet NO: 9 OF 10	
Drawn: K. Jewell	
Approved:	
19 Little Otter Lane Ferrisburg, VT 05456	

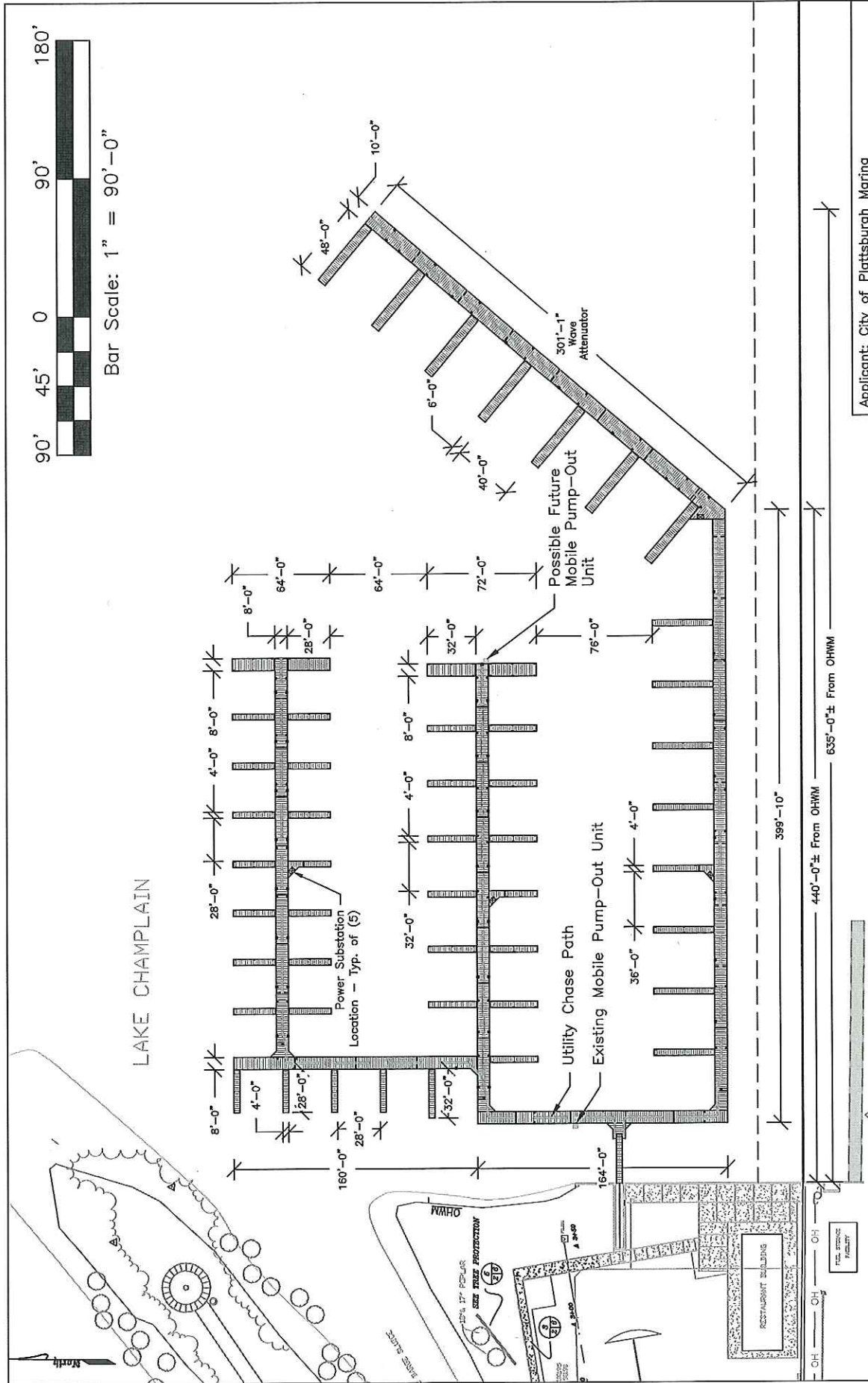

Bar Scale: 1" = 90'-0"

LAKE CHAMPLAIN

Site plan of the proposed mobile pump-out station. The plan shows a rectangular building layout with various dimensions. Key features include:

- Power Substation Location - Typ. of (5)**: Located on the left side of the plan.
- Utility Chase Path** and **Existing Mobile Pump-Out Unit**: Located at the bottom of the plan.
- Possible Future Mobile Pump-Out Unit**: Located on the right side of the plan.
- 301'-1" Wave Attenuator**: Located at the top right of the plan.
- Dimensions**: Various dimensions are provided for building sections and setbacks, including 8'-0", 4'-0", 28'-0", 60'-0", 32'-0", 8'-0", 4'-0", 36'-0", 4'-0", 76'-0", 72'-0", 64'-0", 64'-0", 8'-0", 28'-0", 48'-0", 10'-0", 40'-0", 6'-0", and 399'-10".

Applicant: City of Plattsburgh Marina

Location: Plattsburgh, NY – Lake Champlain

Description: Dimensional Layout

Date: 9/28/16

Sheet NO: 5 OF 10

Drawn: K. Jewell

Approved:



Consulting Group, Inc.

19 Little Otter Lane
Ferrisburg, VT 05456

UTILITIES:

- 4) Power Substation Locations

SHEET ____ OF ____

Plattsburgh City Marina
Existing & Proposed Marina Area Sketch
Scale: NTS
Date: 11/17/2016
Sheet 2 of 2

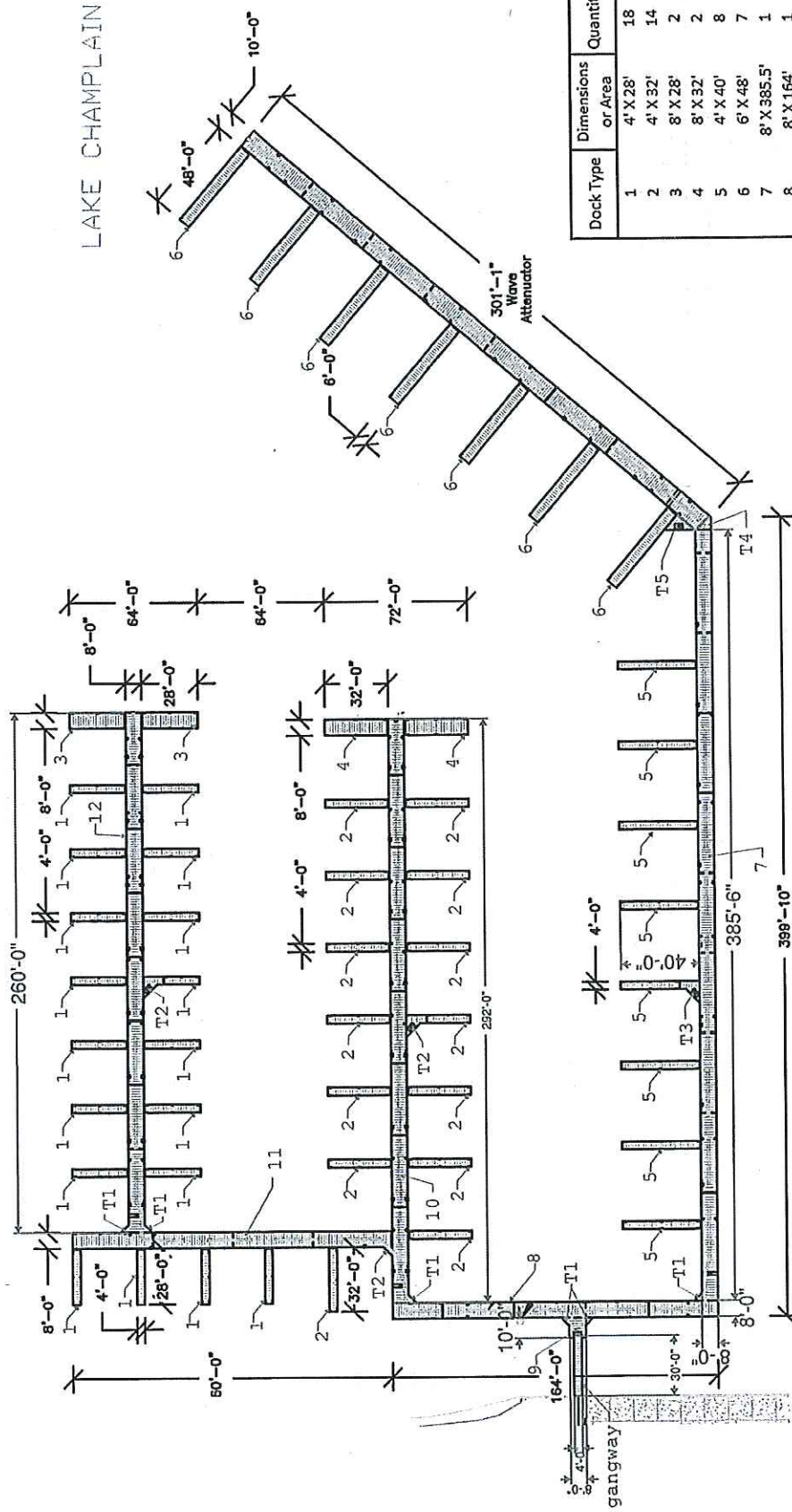

Dock Type	Dimensions or Area	Quantity	Total SF
1	4' X 28'	18	2016
2	4' X 32'	14	1792
3	8' X 28'	2	448
4	8' X 32'	2	512
5	4' X 40'	8	1280
6	6' X 48'	7	2016
7	8' X 385.5'	1	3084
8	8' X 164'	1	1312
9	8' X 10'	1	80
10	8' X 292'	1	2336
11	8' X 60'	1	480
12	8' X 260'	1	2080
Gangway	4' x 30'	1	120
Wave Att.	10' x 301.83'	1	3018.3
T1	9 SF	6	54
T2	27 SF	2	54
T3	25 SF	1	25
T4	30 SF	1	30
T5	60 SF	1	60
		Total	20,797±

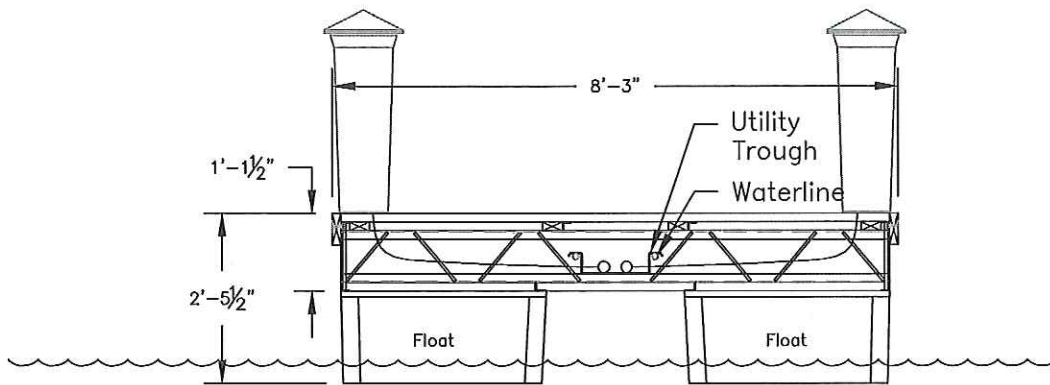

Typical 8'-3" Wide Main Dock Cross Section
Scale: $\frac{3}{8}" = 1'-0"$

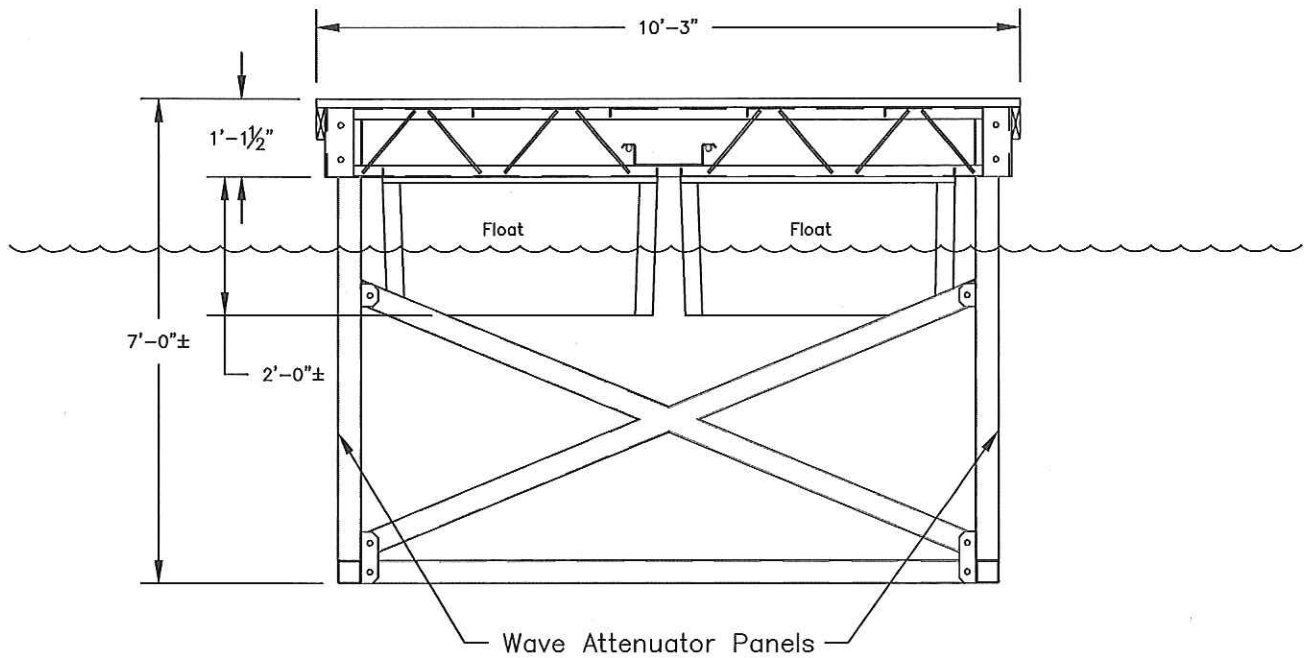

Wave Attenuator Cross Section
Scale: $\frac{3}{8}" = 1'-0"$

Applicant: City of Plattsburgh Marina

Location: Plattsburgh, NY - Lake Champlain

Description: Cross Sections

Date: 9/28/16

Sheet NO: 6 OF 10

Drawn: K. Jewell

Approved:



19 Little Otter Lane
Ferrisburg, VT 05456

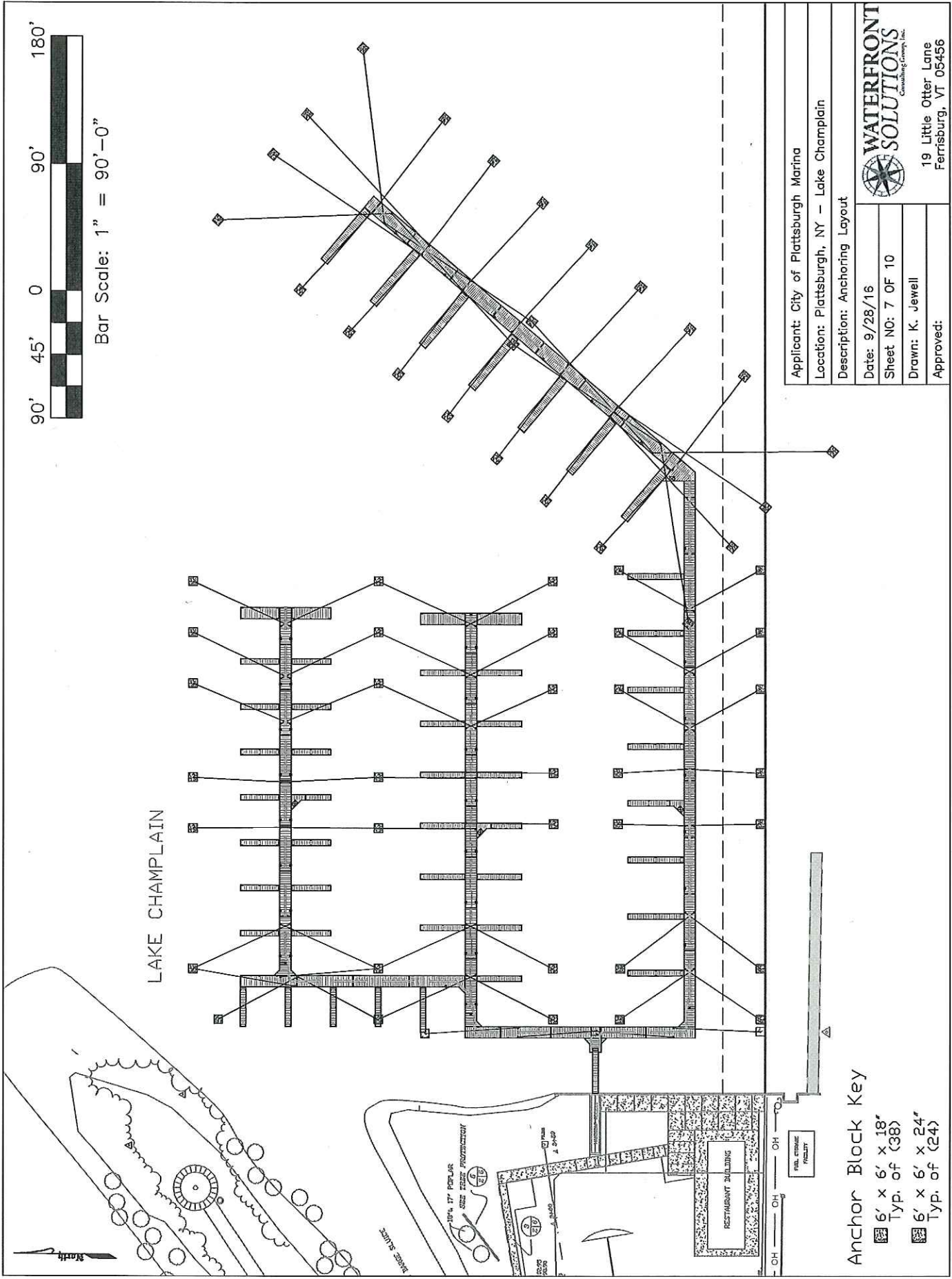

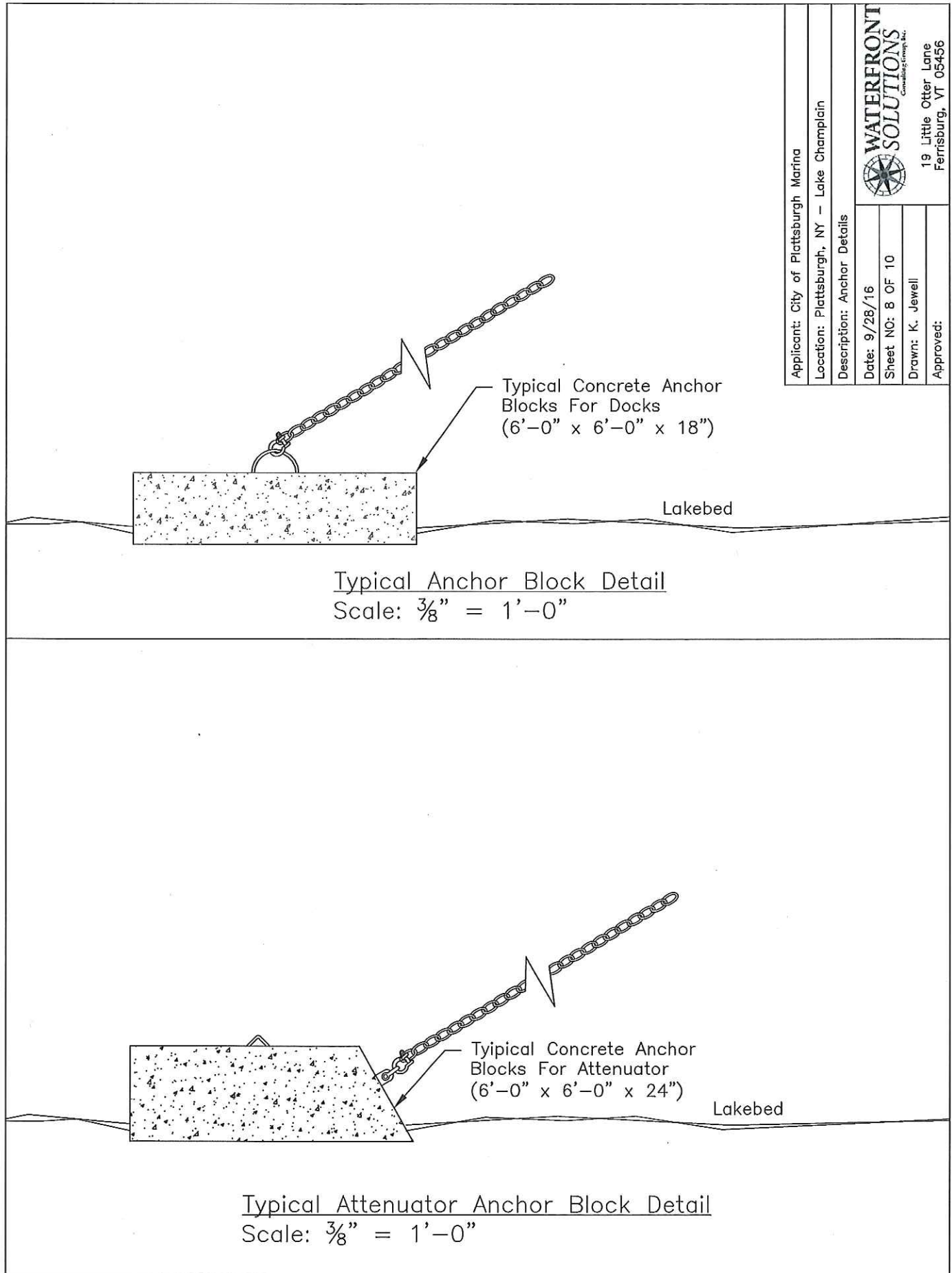

Applicant: City of Plattsburgh Marina	
Location: Plattsburgh, NY - Lake Champlain	
Description: Anchor Details	
Date: 9/28/16	
Sheet NO: 8 OF 10	
Drawn: K. Jewell	
Approved:	
 WATERFRONT SOLUTIONS <small>Consulting Group, Inc.</small>	
19 Little Otter Lane Ferrisburg, VT 05456	

Lake Level (Varies)

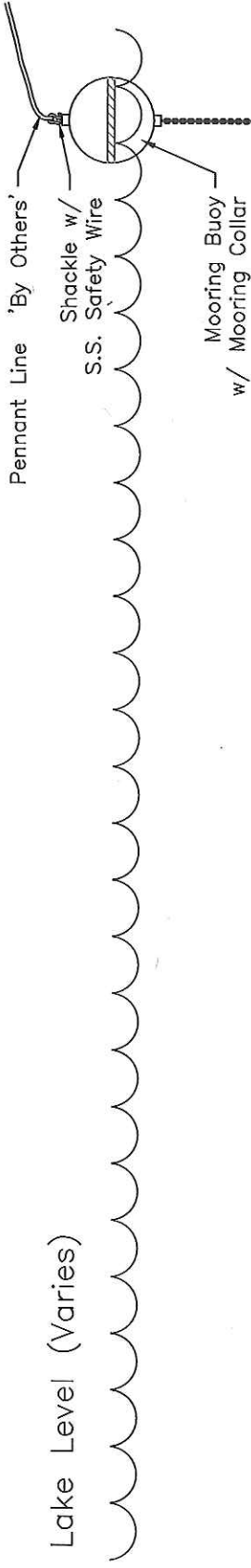

Galvanized Chain length shall be equal to the water depth
Based on 101' ASL
*verified by contractor prior to placement

Connection to be in series
Jaw & Eye Swivel, Shackle
w/ S.S. Safety Wire

Galvanized Chain, length shall be
1 1/2 times the water depth
Based on 101' ASL
*verified by contractor prior to placement

6' x 6' x 18" Anchor Blocks

Single Shackle Connection
w/ S.S. Safety Wire

Mooring Detail
Scale: 1/4" = 1'-0"

Applicant: City of Plattsburgh Marina
Location: Plattsburgh, NY - Lake Champlain
Description: Mooring Detail
Date: 9/28/16
Sheet NO: 10 OF 10
Drawn: K. Jewell
Approved:



19 Little Otter Lane
Ferrisburgh, VT 05456