



# PUBLIC NOTICE

U.S. Army Corps  
of Engineers  
New York District, CENAN-OP-R  
Upstate Regulatory Field Office  
1 Buffington Street, Bldg. 10, 3<sup>rd</sup> Floor  
Watervliet, New York 12189-4000

**In replying refer to:**

Public Notice Number: NAN-2016-00872-UCO  
Issue Date: May 5, 2017  
Expiration Date: June 5, 2017

**To Whom It May Concern:**

The New York District, Corps of Engineers has received an application for a Department of the Army permit pursuant to Section 10 of the Rivers and Harbors Act of 1899 (33 U.S.C. 403).

**APPLICANT:** Westport Marina, Inc.  
20 Washington Street  
Westport, NY 12993

**ACTIVITY:** To maintain a previously completed expansion of a marina and establish a reconfiguration perimeter

**WATERWAY:** Lake Champlain (North West Bay)

**LOCATION:** Town of Westport, Essex County, New York

A detailed description and plans of the applicant's activity are enclosed to assist in your review.

The decision whether to issue a permit will be based on an evaluation of the probable impact including cumulative impacts of the proposed activity on the public interest. That decision will reflect the national concern for both protection and utilization of important resources. The benefit which reasonably may be expected to accrue from the proposal must be balanced against its reasonably foreseeable detriments. All factors which may be relevant to the proposal will be considered including the cumulative effects thereof; among those are conservation, economics, aesthetics, general environmental concerns, wetlands, historic properties, fish and wildlife values, flood hazards, floodplain values, land use, navigation, shoreline erosion and accretion, recreation, water supply and conservation, water quality, energy needs, safety, food and fiber production, mineral needs, considerations of property ownership and, in general, the needs and welfare of the people.

The Corps of Engineers is soliciting comments from the public; Federal, state, and local agencies and officials; Indian Tribes; and other interested parties in order to consider and evaluate the impacts of this proposed activity. Any comments received will be considered by the Corps of Engineers to determine whether to issue, modify, condition or deny a permit for this proposal. To make this decision, comments are used to assess impacts on endangered species, historic properties, water quality, general environmental effects, and the other public interest factors listed above. Comments are used in preparation of an Environmental Assessment and/or an Environmental Impact Statement pursuant to the National Environmental Policy Act. Comments are also used to determine the need for a public hearing and to determine the overall public interest of the proposed activity.

ALL COMMENTS REGARDING THE PERMIT APPLICATION MUST BE PREPARED IN WRITING AND MAILED TO THE ATTENTION OF John Connell AT THE ABOVE ADDRESS, OR SENT VIA ELECTRONIC MAIL TO [john.r.connell@usace.army.mil](mailto:john.r.connell@usace.army.mil), TO REACH THIS OFFICE

BY THE EXPIRATION DATE OF THIS NOTICE, otherwise, it will be presumed that there are no objections to the activity.

Comments submitted in response to this notice will be fully considered during the public interest review for this permit application. Comments provided will become part of the public record for this permit application. All written comments, including contact information, will be made a part of the administrative record, available to the public under the Freedom of Information Act. The Administrative Record, or portions thereof, may also be posted on a Corps of Engineers internet web site. Due to resource limitations, this office will normally not acknowledge the receipt of comments or respond to individual letters of comment.

Any person may request, in writing, before this public notice expires, that a public hearing be held to collect information necessary to consider this application. Requests for public hearings shall state, with particularity, the reasons why a public hearing should be held. It should be noted that information submitted by mail is considered just as carefully in the permit decision process and bears the same weight as that furnished at a public hearing.

Based on information provided by the applicant, there is no tree clearing associated with this action, therefore our preliminary determination is that the activity for which authorization is sought herein will not affect Federally endangered or threatened species or their critical habitat. However, pursuant to Section 7 of the Endangered Species Act (16 U.S.C. 1531), if new information warrants, the District Engineer will consult with the appropriate Federal agency to determine the presence of and any potential impacts to listed species or their critical habitat in the project area.

Based upon information provided by the applicant, this office has determined that this undertaking will have no effect on sites eligible for listing in the National Register of Historic Places. Further consultation with New York State Office of Parks, Recreation and Historic Preservation regarding this undertaking will be conducted, if necessary, and will be concluded prior to the final decision.

The applicant has obtained or requested the following governmental authorization for the activity under consideration:

- Use of State Owned Lands Underwater from the New York State Office of General Services
- Docks, Moorings or Platforms permit from the New York State Department of Environmental Conservation

In order for us to better serve you, please complete our Customer Service Survey located at:

<http://www.nan.usace.army.mil/Missions/Regulatory/CustomerSurvey.aspx>

It is requested that you communicate the foregoing information concerning the activity to any persons known by you to be interested and who did not receive a copy of this notice. If you have any questions concerning this application, you may contact John Connell of this office at (518) 266-6357, or via electronic mail at [john.r.connell@usace.army.mil](mailto:john.r.connell@usace.army.mil).

For more information on New York District Corps of Engineers programs, visit our website at <http://www.nan.usace.army.mil>

A handwritten signature in cursive script, reading "Amy L. Gitchell".

**For and in behalf of**  
Stephan A. Ryba  
Chief, Regulatory Branch

Enclosures



## **WORK DESCRIPTION**

The applicant, the Westport Marina, Inc., has requested a Department of the Army permit for a proposal to maintain a previously completed expansion of a marina and establish a reconfiguration perimeter, in Lake Champlain, at the Westport Marina, located at 20 Washington St., in the Town of Westport, Essex County, New York.

The work would involve the relocation and reorientation of previously authorized structures, including floating piers and a floating tire breakwater, and the placement of two additional floating piers and mooring buoys. The previously authorized facility included a front floating dock assembly, with main pier and finger piers to accommodate 20 permanent boat slips, a main crib dock with finger piers to accommodate 13 permanent and 4 transient slips, and a back dock assembly, with main pier and finger piers to accommodate 20 permanent slips. As authorized, the front floating dock assembly was 10 feet wide by 265 feet long with (5) 5 feet wide by 20 feet long finger piers. As authorized, the main crib dock assembly was 265 feet long with (6) 10 feet wide by 25 feet long floating finger piers. As authorized, the back floating dock assembly was 12 feet wide by 160 feet long with (10) 5 feet wide by 20 feet long finger piers. The previously authorized facility also included a 40 feet long by 17 feet wide by 6 feet deep boat lift and a 26 feet wide by 650 feet long floating tire breakwater, oriented in an 'L' shape protecting the front dock assembly. The previously authorized mooring capacity of the facility accommodated 53 permanent and 4 transient vessels.

The previously completed work proposed to be authorized with this application includes the following:

- Extension of front floating dock assembly to a 6 feet wide by 353 feet long main pier with (12) 3-4 feet wide by 25-30 feet long finger piers, providing 12 additional permanent boat slips;
- The reduction and relocation of the main concrete crib dock assembly to a 10 feet wide by 242 feet long crib dock with (4) 2.5 feet wide by 25 feet long floating finger piers, eliminating 2 permanent boat slips;
- The extension of the back floating dock assembly to a 6 feet wide by 181 feet long main pier with (13) 5 feet wide by 19-32 feet long finger piers, providing 6 additional permanent boat slips;
- The addition of 13 mooring buoys, providing 13 permanent mooring spaces;
- The addition of a 770-square feet 'C' shaped 'patio' floating dock, consisting of an 8 feet by 52 feet main pier with (2) 5 feet wide by 36 feet long fingers extending lakeward, providing 3 transient boat slips
- The addition of an 8 feet by 120 feet 'retaining wall' floating pier, providing 4 transient boat slips; and
- The relocation and reduction of the scrap tire breakwater, which is 15 feet wide by 130 feet long and oriented to protect the entire southern portion of the marina.

All existing and proposed boat slips would continue to have access to marina services, including fuel, electrical service, lighting, potable water, sewage pump-out, a security system and Wi-Fi service. The facility would maintain the existing mooring capacity, which accommodates 69 permanent and 11 transient vessels. The facility would also establish a reconfiguration perimeter, consisting of approximately 19 acres of the Lake. The proposed perimeter will be marked by floating buoys at the lakeward perimeter points. The stated purpose of this project is to maintain public access to Lake Champlain for recreational boating.



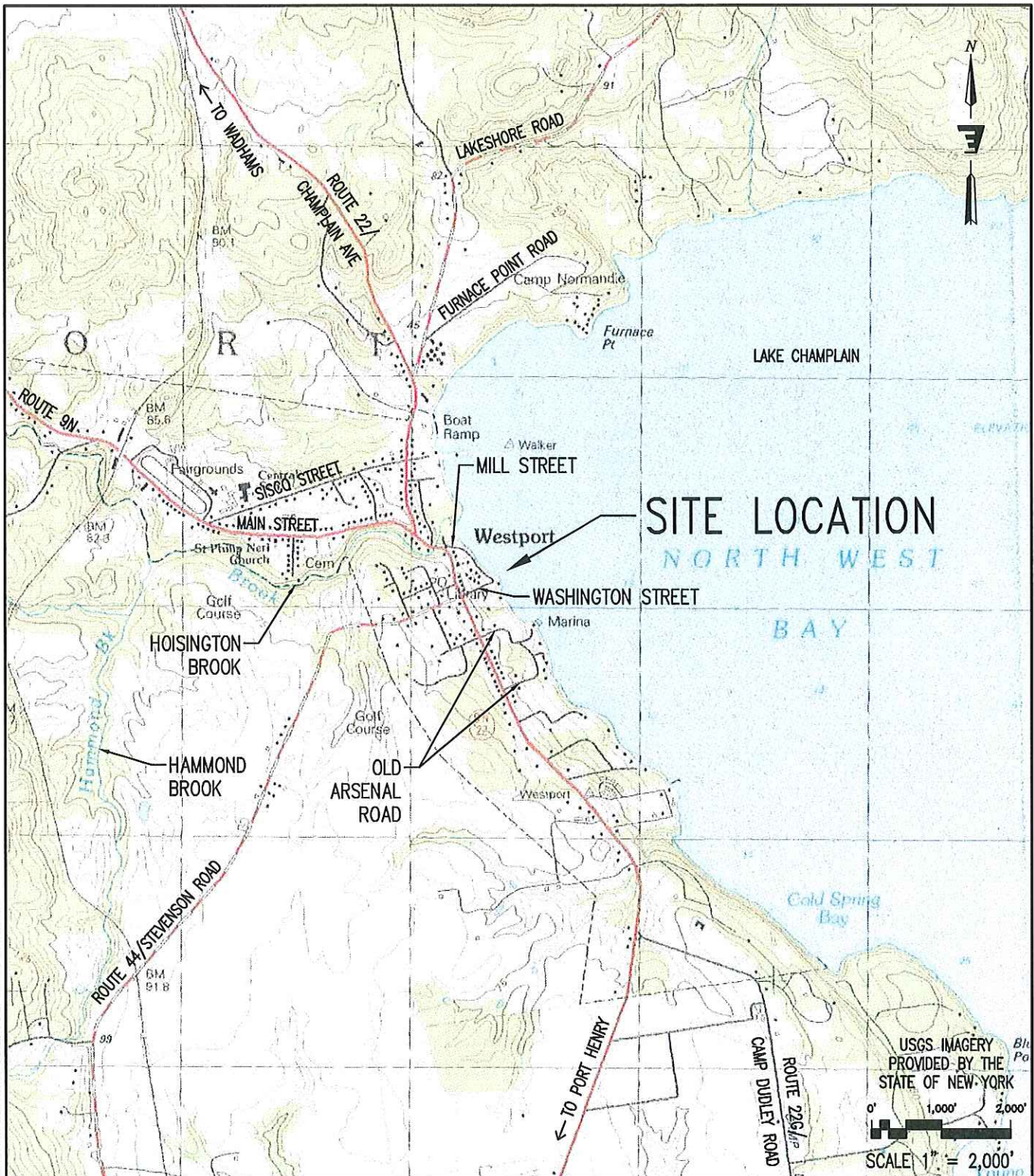

**ENGINEERING VENTURES PC**  
 200 Flynn Avenue, Suite 2A, Burlington, VT 05401  
 tel. 802.863.6225  
 fax 802.863.6306  
 www.engineeringventures.com

## VICINITY MAP

File No:	Project: WESTPORT MARINA: FLOAT DOCKS & ANCHORS
Lot/Long: 44°10'57.3" N 73°25'50.6" W	Applicant: WESTPORT MARINE BASE, INC.
	Waterbody: LAKE CHAMPLAIN
	Location: TOWN OF WESTPORT, ESSEX COUNTY, NY

Checked By: PG	Scale: 1" = 2,000'
Drawn By: HKW	Project No.: 16416
Date: 02/15/2017	Drawing No.: 1 of 11



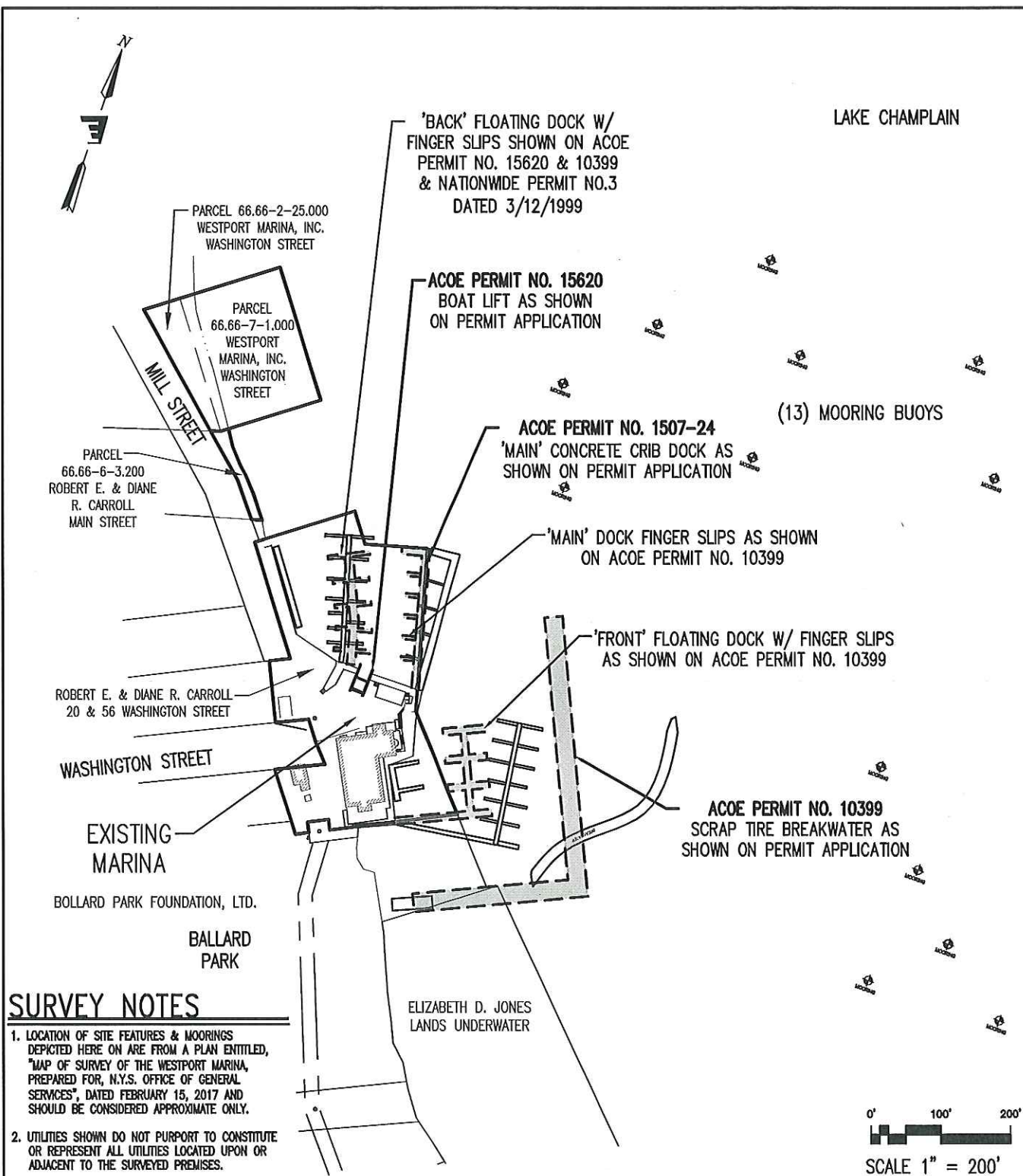

**ENGINEERING VENTURES PC**

208 Flynn Avenue, Suite 2A, Burlington, VT 05401  
tel. 802.863.6225  
fax 802.863.6306  
www.engineeringventures.com

## PREVIOUSLY AUTHORIZED STRUCTURES

File No:	Project: WESTPORT MARINA: FLOAT DOCKS & ANCHORS
Lot/Long: 44°10'57.3" N 73°25'50.6" W	Applicant: WESTPORT MARINE BASE, INC.
	Waterbody: LAKE CHAMPLAIN
	Location: TOWN OF WESTPORT, ESSEX COUNTY, NY

Checked By: PG	Scale: 1" = 200'
Drawn By: HKW	Project No.: 16416
Date: 02/15/2017	Drawing No.: 2 of 11

Plotted: 3/6/2017 12:57 PM

Westport Marina Boat Slips			
Structure	Permanent	Transient	Total
Front Floating Dock	32	-	32
Main Crib Dock	11	4	15
Back Floating Dock	26	-	26
Retaining Wall Dock	-	4	4
Patio Dock	-	3	3
Total	69	11	80

REFER TO SHEETS 6 & 7  
FOR SLIP LOCATIONS

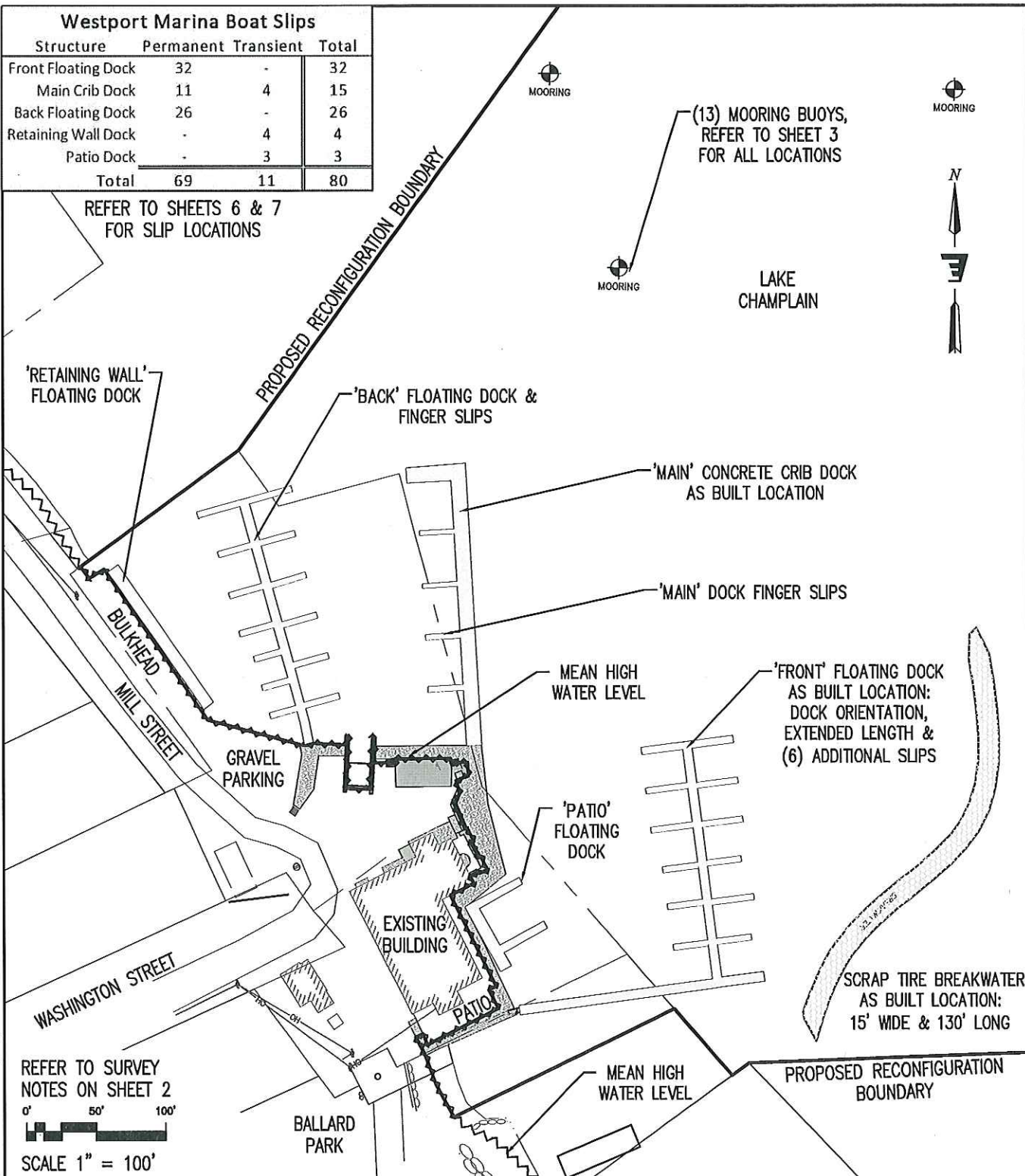

REFER TO SURVEY  
NOTES ON SHEET 2

0' 50' 100'

SCALE 1" = 100'

**ENGINEERING VENTURES PC**  
208 Flynn Avenue, Suite 2A, Burlington, VT 05401  
tel. 802.863.6225  
fax 802.863.6306  
www.engineeringventures.com

## PROPOSED AUTHORIZATION PLAN

File No:

Lot/Long: 44°10'57.3" N  
73°25'50.6" W

Project: WESTPORT MARINA: FLOAT DOCKS & ANCHORS  
Applicant: WESTPORT MARINE BASE, INC.  
Waterbody: LAKE CHAMPLAIN  
Location: TOWN OF WESTPORT, ESSEX COUNTY, NY

Checked By:  
PG

Drawn By:  
HKW

Date:  
02/15/2017

Scale:  
1" = 100'

Project No.:  
16416

Drawing No.:  
3 of 11

S:\PROJECTS\0-2016\16416 NY Westport Marina Base Permitting\dwg\16416-ACOE Permit Plans.dwg



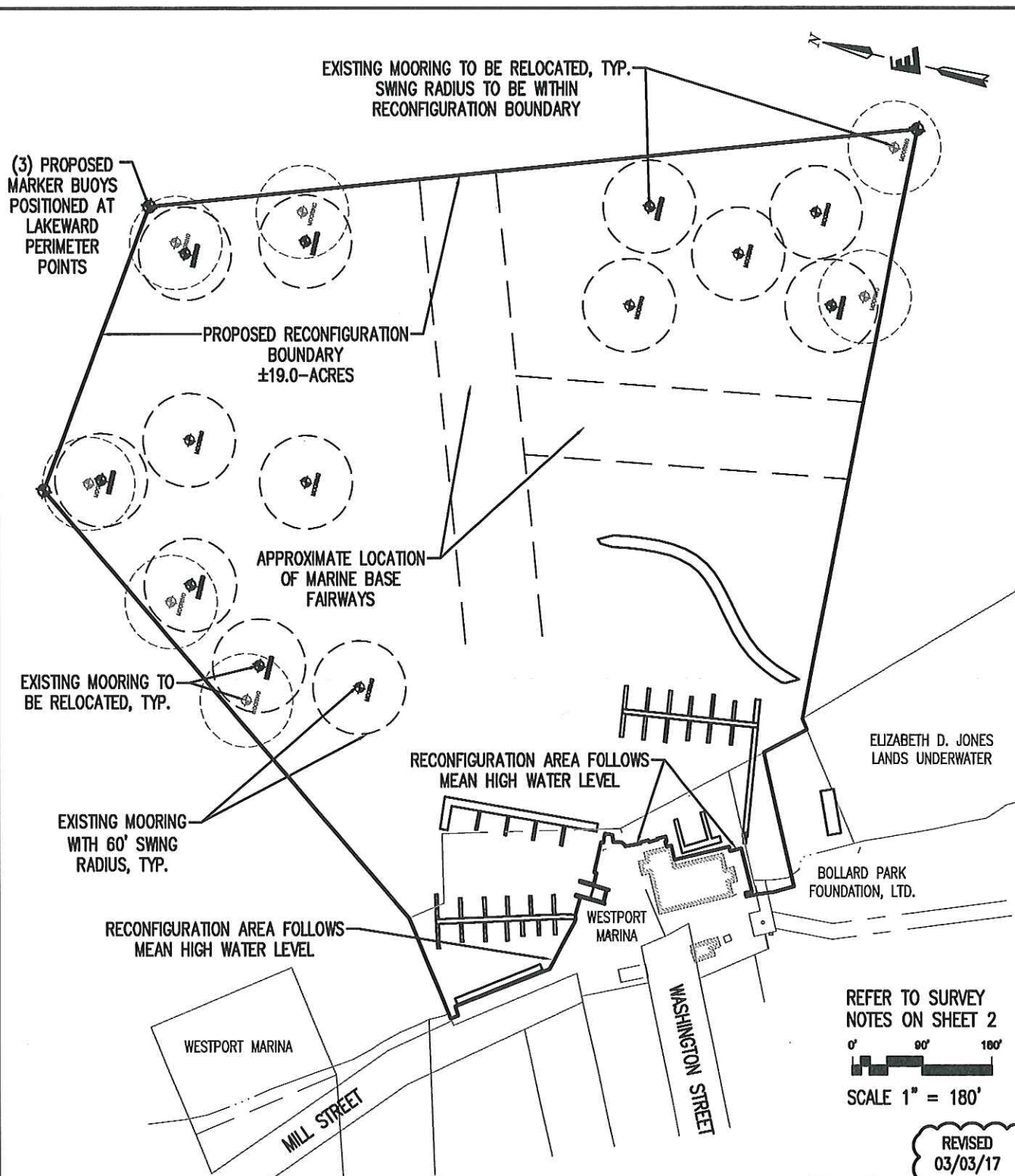

REVISED  
03/03/17

**ENGINEERING VENTURES PC**  
200 Flynn Avenue, Suite 2A, Burlington, VT 05401  
tel. 802.863.6225  
fax 802.863.6306  
www.engineeringventures.com

## RECONFIGURATION PERIMETER PLAN

File No:	Project: WESTPORT MARINA: FLOAT DOCKS & ANCHORS
Lot/Long: 44°10'57.3" N 73°25'50.6" W	Applicant: WESTPORT MARINE BASE, INC.
	Waterbody: LAKE CHAMPLAIN
	Location: TOWN OF WESTPORT, ESSEX COUNTY, NY

Checked By: PG	Scale: 1" = 180'
Drawn By: HKW	Project No.: 16416
Date: 02/15/2017	Drawing No.: 4 of 11



Plotted: 3/6/2017 12:57 PM

S:\PROJECTS\0-2016\16416 NY Westport Marina Base Permitting\dwg\16416-ACOE Permit Plans.dwg

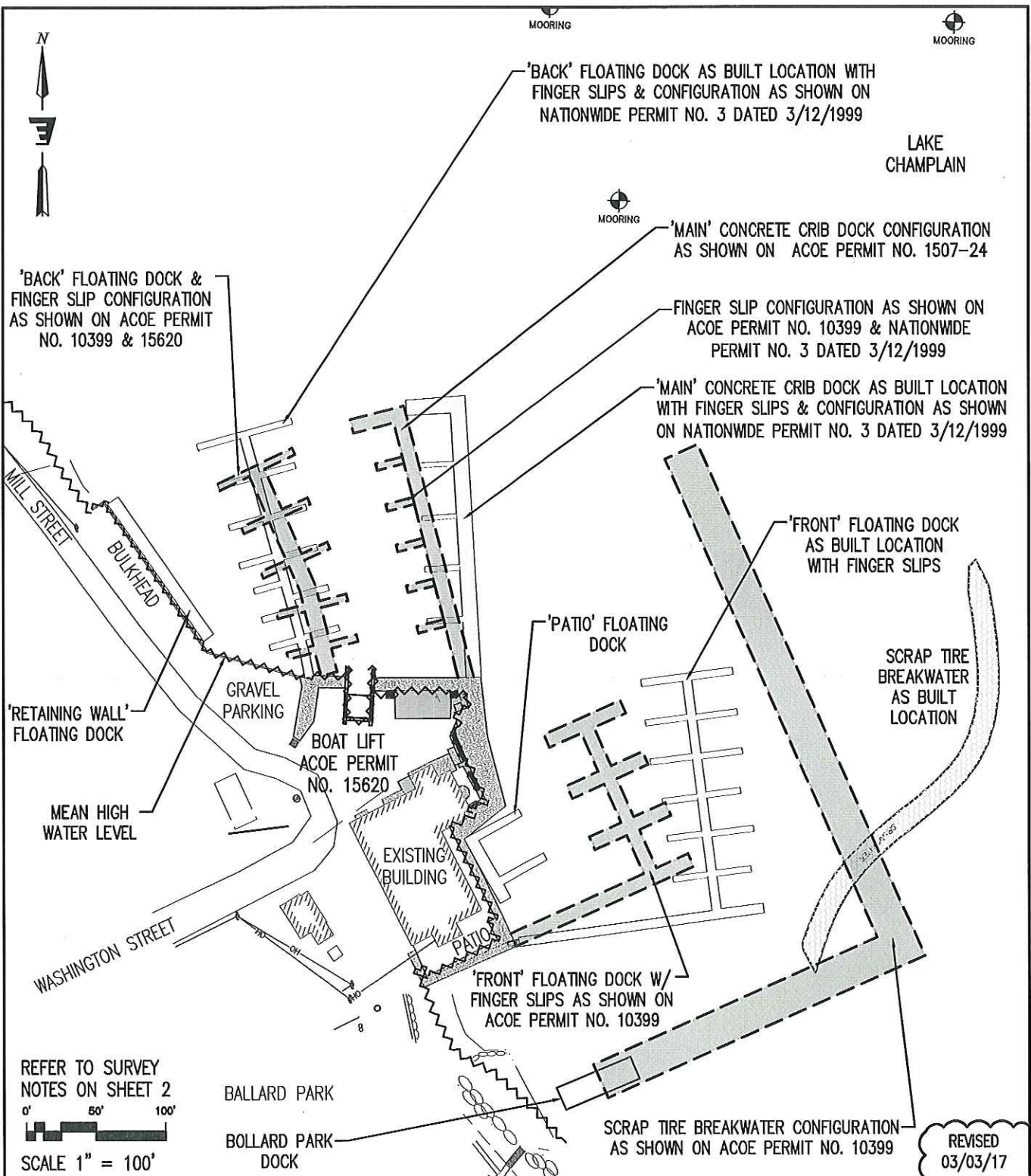

REFER TO SURVEY  
NOTES ON SHEET 2  
0' 50' 100'  
SCALE 1" = 100'

**ENGINEERING VENTURES PC**  
208 Flynn Avenue, Suite 2A, Burlington, VT 05401  
tel. 802.863.6225  
fax 802.863.6306  
www.engineeringventures.com

## STRUCTURE DEVIATION PLAN

File No:	Project: WESTPORT MARINA: FLOAT DOCKS & ANCHORS
Lat/Long: 44°10'57.3" N 73°25'50.6" W	Applicant: WESTPORT MARINE BASE, INC.
	Waterbody: LAKE CHAMPLAIN
	Location: TOWN OF WESTPORT, ESSEX COUNTY, NY

Checked By: PG	Scale: 1" = 100'
Drawn By: HKW	Project No.: 16416
Date: 02/15/2017	Drawing No.: 5 of 11

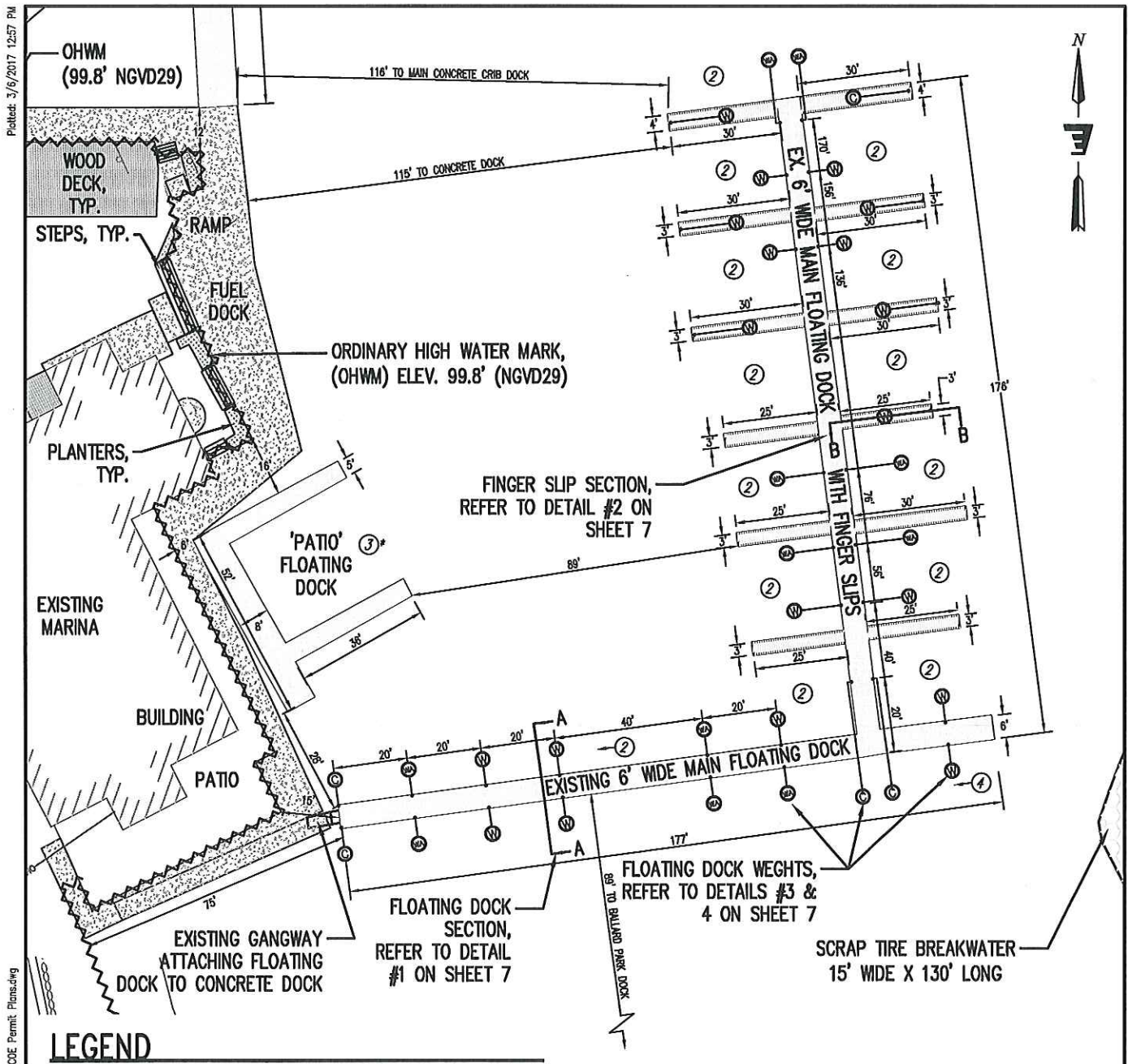

## LEGEND

- ⊙ ANCHOR WEIGHT: 5' X 5' X 1' CONCRETE BLOCK
  - ⊙ ANCHOR WEIGHT: RAILROAD WHEEL
  - ⊙ ANCHOR WEIGHT: RAILROAD WHEEL WITH 1/2 AXLE
  - CHAIN AND CONNECTION POINT
  - ② DESIGNATED NUMBER OF SLIPS AVAILABLE FOR VESSEL DOCKING
- WITHIN IMMEDIATE AREA, \* DENOTES TRANSIENT SLIP
- WEIGHT LOCATIONS ARE APPROXIMATE

REFER TO SURVEY NOTES ON SHEET 2

0' 20' 40'

SCALE 1" = 40'

**ENGINEERING VENTURES PC**

208 Flynn Avenue, Suite 2A, Burlington, VT 05401

tel. 802.863.6225

fax 802.863.6308

www.engineeringventures.com

## EXISTING CONDITIONS PLAN (SOUTH)

File No:	Project: WESTPORT MARINA: FLOAT DOCKS & ANCHORS
Lat/Long: 44°10'57.3" N 73°25'50.6" W	Applicant: WESTPORT MARINE BASE, INC.
	Waterbody: LAKE CHAMPLAIN
	Location: TOWN OF WESTPORT, ESSEX COUNTY, NY

Checked By: PG	Scale: 1" = 40'
Drawn By: HKW	Project No.: 16416
Date: 02/15/2017	Drawing No.: 6 of 11



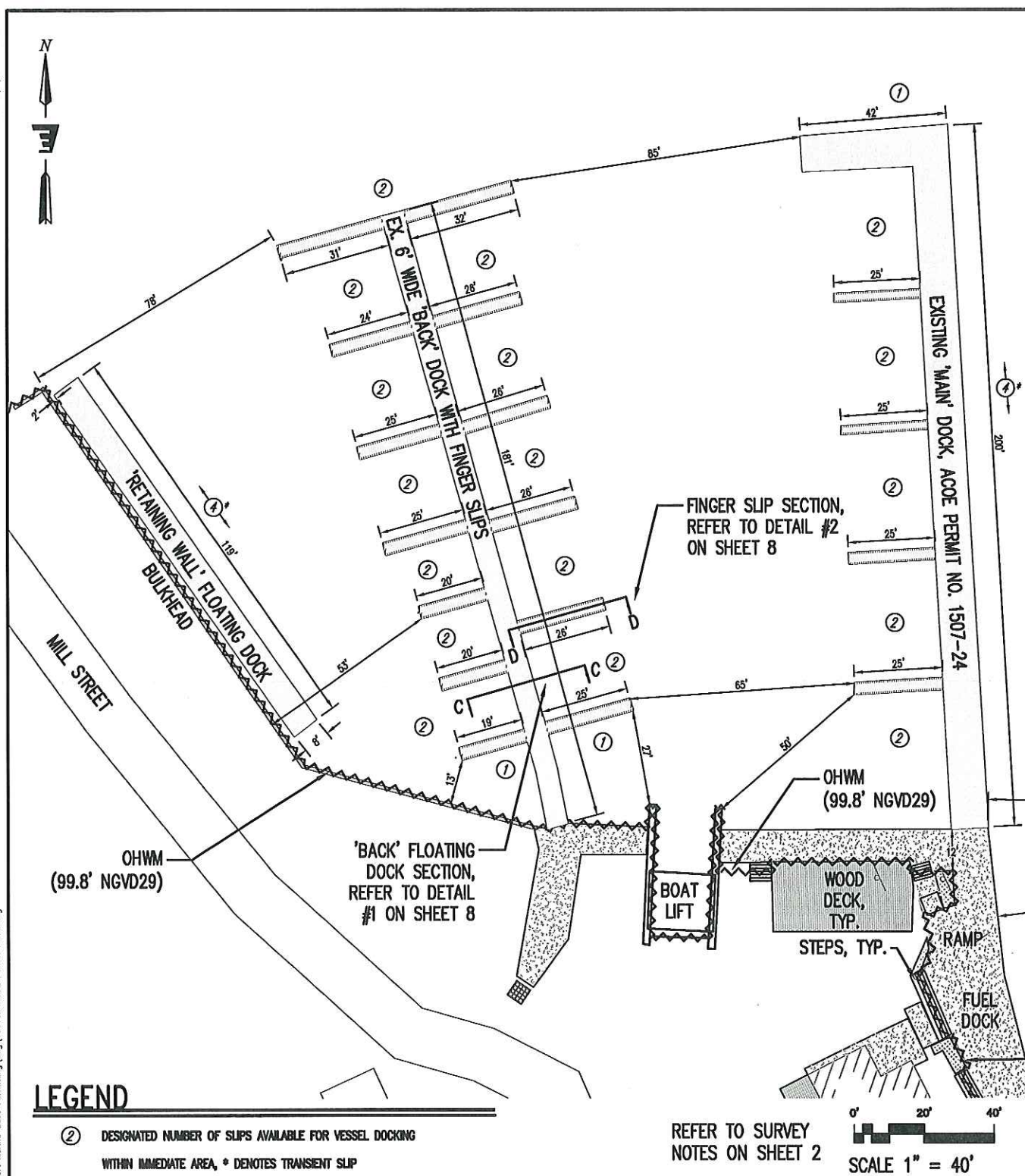

# EXISTING CONDITIONS PLAN (NORTH)

 <b>ENGINEERING VENTURES PC</b> 208 Flynn Avenue, Suite 2A, Burlington, VT 05401 tel. 802.863.6225 fax 802.863.6306 <a href="http://www.engineeringventures.com">www.engineeringventures.com</a>	<b>EXISTING CONDITIONS PLAN (NORTH)</b>		Checked By: <b>PG</b>	Scale: <b>1" = 40'</b>
	File No:	Project: <b>WESTPORT MARINA: FLOAT DOCKS &amp; ANCHORS</b>	Drawn By: <b>HKW</b>	Project No.: <b>16416</b>
	Lat/Long: <b>44°10'57.3" N 73°25'50.6" W</b>	Applicant: <b>WESTPORT MARINE BASE, INC.</b> Waterbody: <b>LAKE CHAMPLAIN</b> Location: <b>TOWN OF WESTPORT, ESSEX COUNTY, NY</b>	Date: <b>02/15/2017</b>	Drawing No.: <b>7 of 11</b>

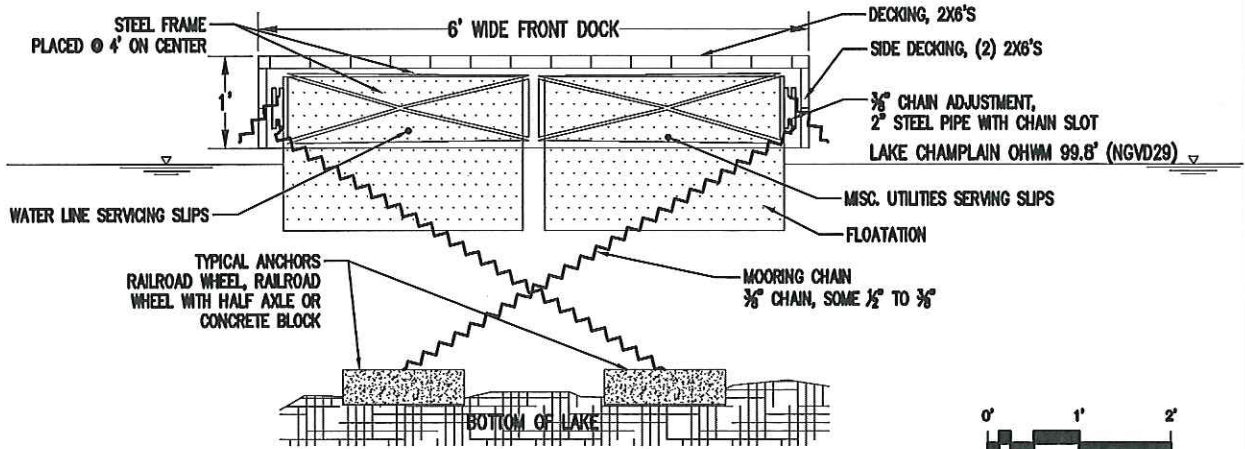

**FRONT FLOATING DOCK: SECTION A-A**

SCALE 1" = 2'

SCALE 1" = 2' 1

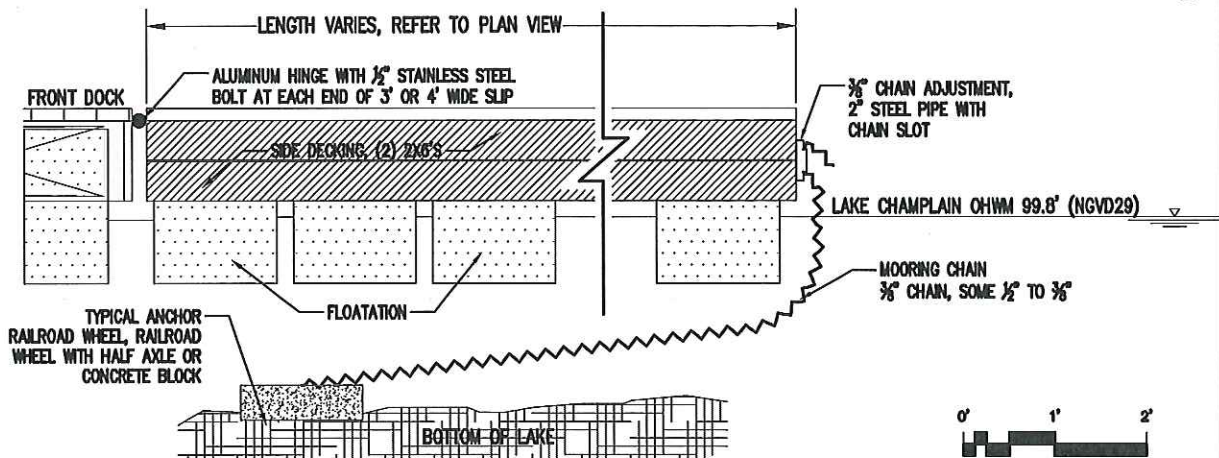

**FRONT FLOATING DOCK CONNECTION TO FINGER SLIP: SECTION B-B**

SCALE 1" = 2'

SCALE 1" = 2' 2

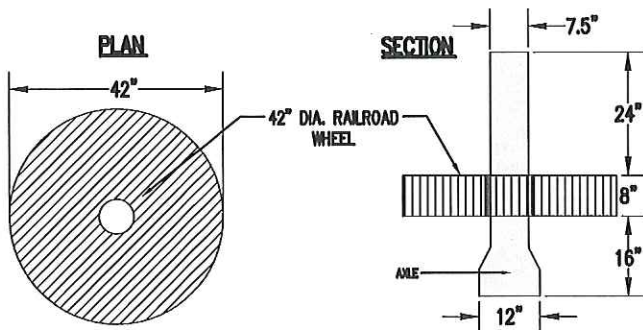

**RAILROAD WHEEL & AXEL DETAIL**

SCALE 1" = 3' 3

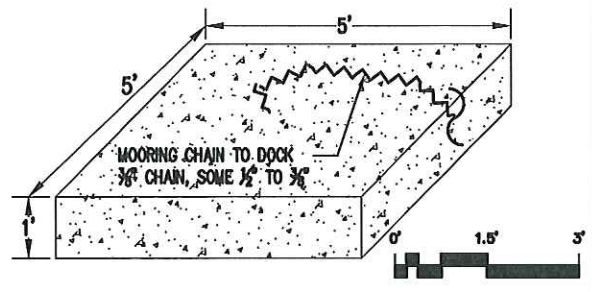

**CONCRETE ANCHOR DETAIL**

SCALE 1" = 3'

SCALE 1" = 3' 4

**ENGINEERING VENTURES PC**  
208 Flynn Avenue, Suite 2A, Burlington, VT 05401  
tel. 802.863.6225  
fax 802.863.6306  
www.engineeringventures.com

**FRONT DOCK SECTIONS & DETAILS**

File No:	Project: WESTPORT MARINA: FLOAT DOCKS & ANCHORS
Lat/Long: 44°10'57.3" N 73°25'50.6" W	Applicant: WESTPORT MARINE BASE, INC.
	Waterbody: LAKE CHAMPLAIN
	Location: TOWN OF WESTPORT, ESSEX COUNTY, NY

Checked By: PG	Scale: AS NOTED
Drawn By: HKW	Project No.: 16416
Date: 02/15/2017	Drawing No.: 8 of 11



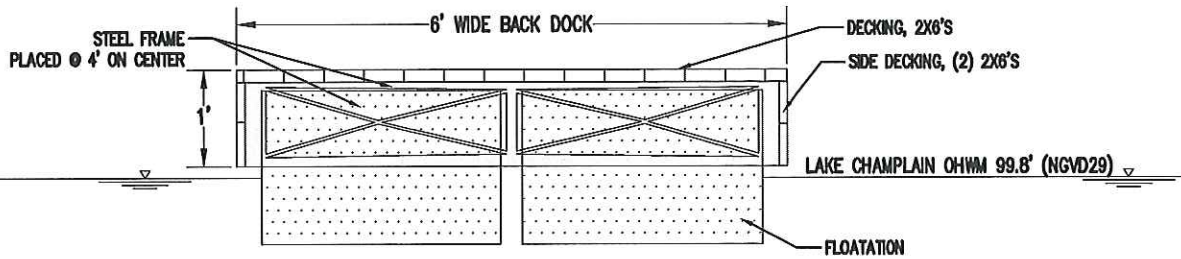

**NOTE:**  
DOCK IS ATTACHED TO SHORE  
AT THE CONCRETE PORTION  
WEST OF THE BOAT LIFT.



SCALE 1" = 2'

## BACK FLOATING DOCK: SECTION C-C

SCALE 1" = 2'

1

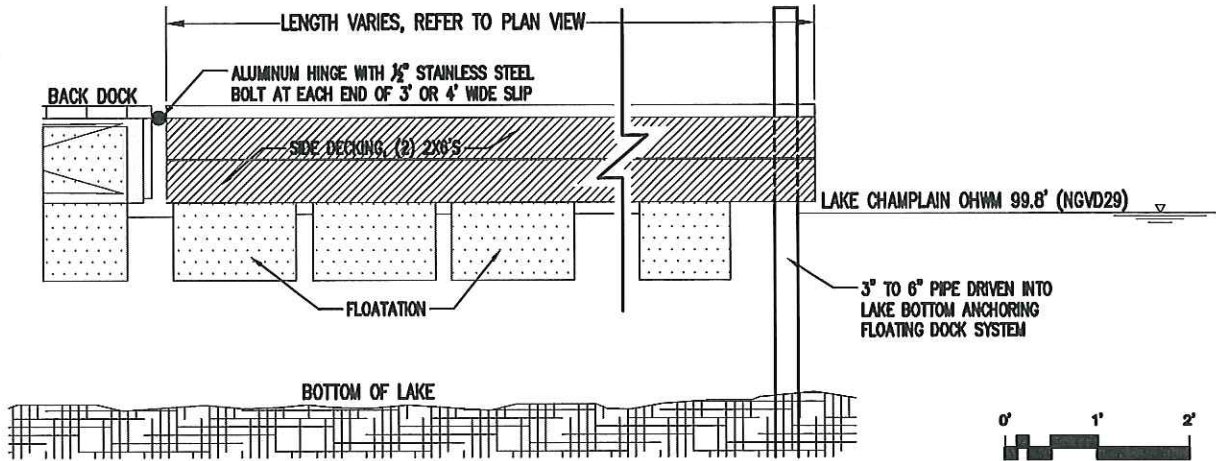

SCALE 1" = 2'

## BACK FLOATING DOCK CONNECTION TO FINGER SLIP: SECTION D-D

SCALE 1" = 2'

2

**ENGINEERING  
VENTURES PC**

208 Flynn Avenue, Suite 2A, Burlington, VT 05401  
tel. 802.863.6225  
fax 802.863.6306  
www.engineeringventures.com

## BACK DOCK SECTIONS & DETAILS

File No:	Project: WESTPORT MARINA: FLOAT DOCKS & ANCHORS
Lat/Long: 44°10'57.3" N 73°25'50.6" W	Applicant: WESTPORT MARINE BASE, INC.
	Waterbody: LAKE CHAMPLAIN
	Location: TOWN OF WESTPORT, ESSEX COUNTY, NY

Checked By: PG	Scale: AS NOTED
Drawn By: HKW	Project No.: 16416
Date: 02/15/2017	Drawing No.: 9 of 11

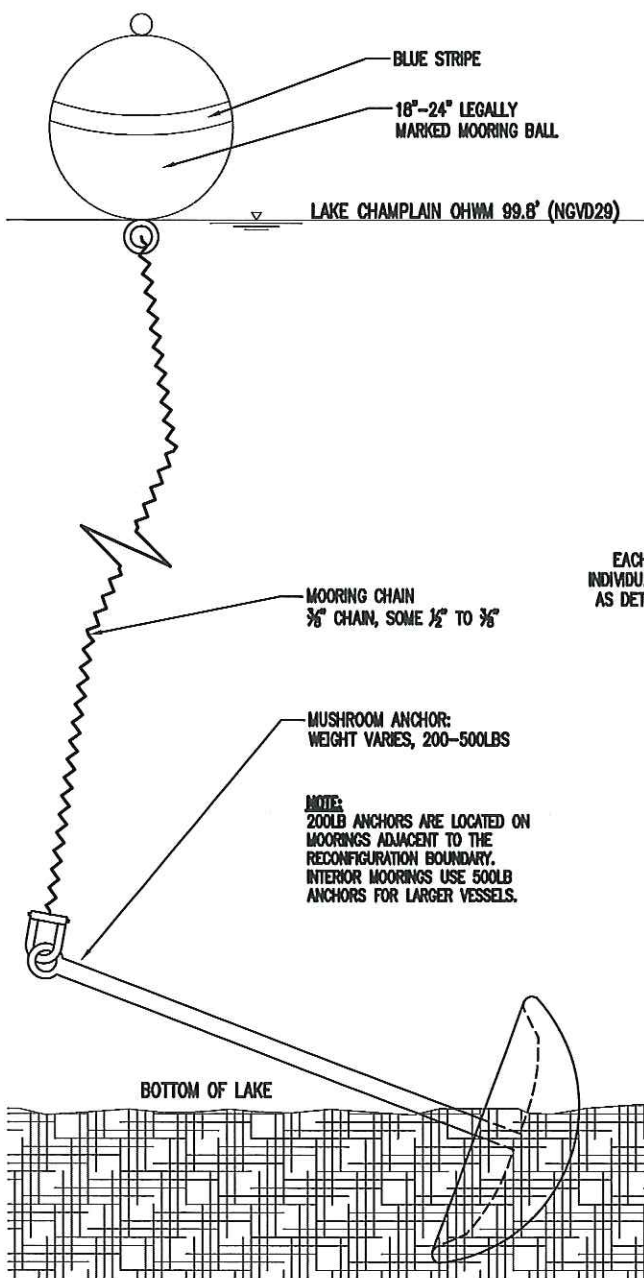

**TYPICAL MOORING DETAIL**

SCALE 1" = 2'

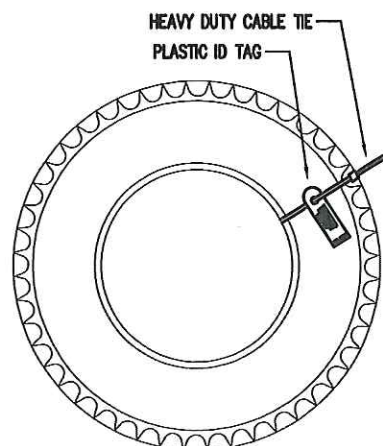
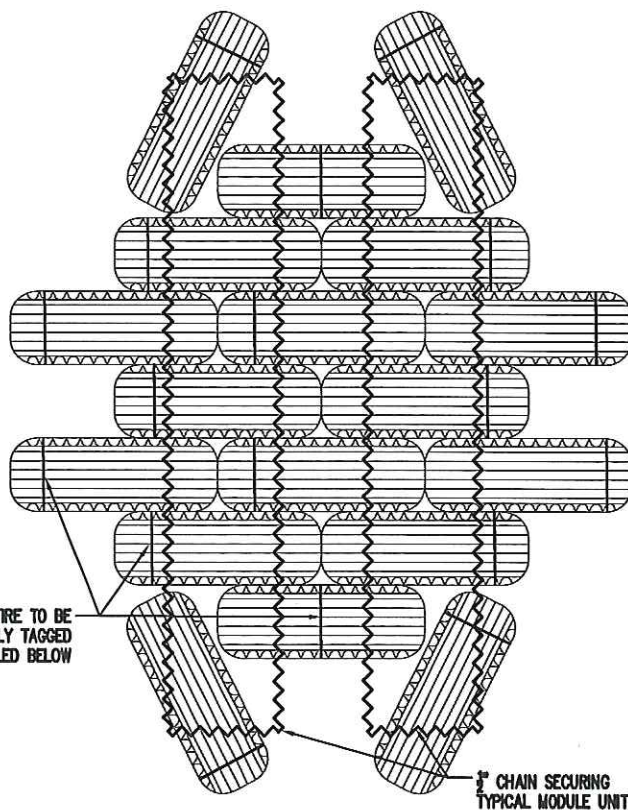

**BREAKWATER TIRE TAGGING DETAIL**

NOT TO SCALE

**ENGINEERING VENTURES PC**

208 Flynn Avenue, Suite 2A, Burlington, VT 05401  
tel. 802.863.8225  
fax 802.863.6306  
www.engineeringventures.com

**MOORING & BREAKWATER DETAIL**

File No: Project: WESTPORT MARINA: FLOAT DOCKS & ANCHORS  
Applicant: WESTPORT MARINE BASE, INC.  
Lat/Long: 44°10'57.3" N Waterbody: LAKE CHAMPLAIN  
73°25'50.6" W Location: TOWN OF WESTPORT, ESSEX COUNTY, NY

Checked By: PG  
Drawn By: HKW  
Date: 02/15/2017

Scale: AS NOTED  
Project No.: 16416  
Drawing No.: 10 of 11

REVISED  
03/03/17



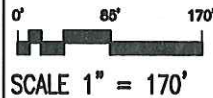

## MAP OF SURVEY

<h1 style="text-align: center;">MAP OF SURVEY</h1>		Checked By: <b>AS NOTED</b>	Scale: <b>1" = 170'</b>
File No:	Project: <b>WESTPORT MARINA: FLOAT DOCKS &amp; ANCHORS</b> Applicant: <b>WESTPORT MARINE BASE, INC.</b>	Drawn By: <b>AS NOTED</b>	Project No.: <b>16416</b>
Lat/Long: <b>44°10'57.3" N</b> <b>73°25'50.6" W</b>	Waterbody: <b>LAKE CHAMPLAIN</b> Location: <b>TOWN OF WESTPORT, ESSEX COUNTY, NY</b>	Date: <b>02/15/2017</b>	Drawing No.: <b>11 of 11</b>